

Marshall University

**Marshall Digital Scholar**

---

Marshall University Student Handbook

University Archives

---

8-1962

## **The Student Handbook of Marshall University, 1962-1963**

Marshall University

Follow this and additional works at: <https://mds.marshall.edu/studenthandbook>



Part of the [Higher Education Commons](#)

---

ARCHIVES

StP

1.28

1962-63

cop.2



# *Student Handbook*

1962 - 1963

MARSHALL UNIVERSITY

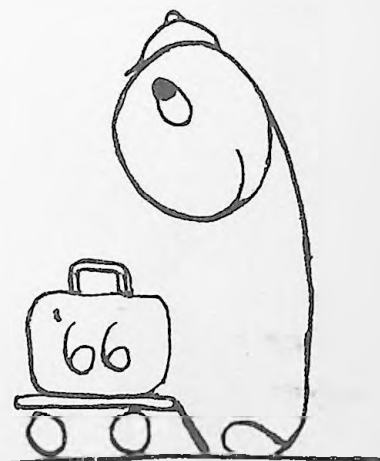

# The Official STUDENT HANDBOOK

Dedicated to "Swede" Gullickson, the eternally, youthful  
spirit of Marshall University



Published by

The Student Handbook Commission of the  
MARSHALL UNIVERSITY STUDENT GOVERNMENT

BARBRA CHARLES, EDITOR

JAMES CASTO, BUSINESS MANAGER

Elaine Thompson, Ed Eckley, Joe Hughes

1962 - 1963

## TABLE OF CONTENTS

John Marshall .....	3
Message from President Smith .....	4
Message from Gary McMillan, Student Body President .....	5
Welcome .....	6
Freshman Week .....	6
Freshman Rules .....	6
History of Marshall and Proposed Expansion .....	9
Traditions .....	10
The Individuals Who Run Our Campus .....	13
Additional Personnel and Facilities .....	17
Clothes and Manners to Fit The Occasion .....	19
Get Acquainted with Culture .....	22
Entertainment .....	26
Nearby Churches .....	27
Map of University .....	24
Extracurricular Activities .....	28
Let's Get Academic .....	29
Student Government .....	32
Organizations .....	34
Publications .....	39
A Look At Sports .....	41
Glossary .....	44

---

---

## JOHN MARSHALL

"The services of Marshall will always remain as an inspiration to young America as well as to the older generations. He stands as an example of courage, perseverance, and self-sacrifice. He ranks among the founders of the Nation; he early formed definite habits of thinking which crystallized his character. To these principles he remained adamant. As a lawyer, he knew the drudgery incident to the careful preparation of an argument in court. As a legislator he studied the fundamental principles upon which a democracy must be founded. As a member of Congress he rose to the defense of a President who was carrying out the duties of his office. As an envoy he outwitted the craftiest statesman of France. As Secretary of State he gave the first outlines of a strong foreign policy. As Chief Justice of the Supreme Court he rendered decisions which have influenced and molded the character of the American Nation. John Marshall, born of humble parentage in Virginia, rose to a position of power and prominence equal to that of the presidency . . . His memory will be an inspiration in the years to come to the thousands of students of this University who will take with them into the world the influence of this great American which is still a vital living force in our Nation."

(Above quote from J. F. T. O'Connor from  
One Hundred Years of Marshall College.)

**DR. STEWART H. SMITH**  
President of Marshall University



### **PRESIDENT'S MESSAGE**

To the Members of the Class of 1966:

We welcome you to Marshall University. You are now one of us and we expect you to play an important part in upholding the ideals and purposes of our University.

You are most fortunate to be able to attend an institution of higher learning. I believe that most of you have the qualities which will enable you to succeed here. Much will depend upon your desire to learn.

Colleges and universities exist to help young people improve themselves so that they can render greater service and enjoy richer and fuller lives. Here you will have the opportunity to grow into maturity in a wholesome and stimulating environment. You must educate yourself by taking advantage of the many opportunities that are provided.

Marshall is your university. Give generously of your loyalty, devotion and enthusiasm and you will reap great rewards. Make sure that every word and act of yours will bring credit and honor to your Alma Mater.

With all good wishes for your success, I am

Cordially yours,  
STEWART H. SMITH  
President

### **MESSAGE FROM PRESIDENT STUDENT BODY**

On behalf of the upperclassmen and myself, I would like to take this opportunity to welcome you to MARSHALL UNIVERSITY. If this is the first university or college you have attended, as it probably is for most of you, we hope that your adjustment, both academic and social, will be a rewarding one. If by chance you have already begun your attempt at higher education, we hope that the knowledge you have elsewhere will aid those freshmen who have not been so fortunate.

Your success as a college student will be what you can make of it. True, the university faculty is always ready to give advice, but the real burden rests upon your shoulders. You, the individual student, have the responsibility of choosing your field or fields of study. Some of you are still undecided about this matter. Reasonably so, but if you maintain a well-rounded academic program, you will be prepared for the time when you make your final decision as to your course of study.

Being new on the campus, many questions may arise which can be answered either by myself or another member of the Student Government. Our office is located in the west end of the Student Union and we are all looking forward to meeting you some time in the near future.

Until that time, let me wish you a pleasant and enlightening stay at Marshall. One which will insure your success in both business and society.

GARY McMILLAN  
Student Body President

## YOU ARE HERE!

"Hi!" and "Welcome to Marshall University"; we are very happy that you have decided to make our campus your home for the next four years, and we are eager to make you feel like you belong to our fine institution.

As a freshman, you have made two very important decisions: first, to attend college, and second, to attend Marshall. College will be four of the most difficult years of your life, but there are many compensations: you will have an opportunity to make many new friends, have new experiences, and prepare yourself for a career in the business or professional world. Remember, a college education is not gotten entirely in the class room, so be sure to avail yourself of Marshall's fine cultural program and her many outside activities.

## FOR FRESHMEN ONLY

You have doubtless heard much about the terrors of Freshman Week. Freshman Week is not designed to terrorize or humiliate you; its purpose is to make you feel at home at Marshall.

You have been assigned to a specific group with other Freshmen. Freshman Guides, chosen by the University Administration, are in charge of the individual groups. These groups serve a two-fold purpose: first, you will have the opportunity to become acquainted with other Freshmen in your group; second, your GUIDE will be able to answer any question you may have about Marshall University. Before you begin, though, we suggest you read this Handbook and the Marshall University Catalog from cover to cover, then fire those questions at the GUIDES. Don't feel hesitant about asking anything you want to know. Remember, the GUIDES asked the same questions when they were Freshmen.

## FRESHMAN ACTIVITIES THE RULES AND THE RULERS

It is the tradition at many colleges for the entering freshmen to wear beanies. This "tradition" is enforced by Freshmen Rule Enforcers. These enforcers (or rulers) are upperclassmen who have been chosen by the Freshman Activities Commission. They may be identified by their name tags to which are attached green and white ribbons. If you are caught violating one of the Freshman Rules, one of the Enforcers will give you a ticket. The Freshman Court will then decide

your penalty. Last year our "Kangaroo Court" convicted 100% of its cases.

The following rules governing Freshman Activities have been drafted by the Freshman Activities Commission for 1962-63:

1. Freshman Rules will go into effect Monday, September 17, 1962. They will end on Saturday, September 29, 1962, if the Freshman men win the tug-of-war. If the rope breaks the freshmen lose. If the Freshmen men lose the tug-of-war, the rules will continue to be in effect for one week until October 6.
2. Freshmen caps, handbooks, and name plates are to be worn at all times during the day from 8:00 A.M. to 5:00 P.M. and to all Freshman activities. However, Freshmen men must not wear their caps in the classrooms, ROTC formations, or other buildings on campus.
3. Freshmen are required to speak to all persons they see on campus.
4. Freshmen are required to walk on the walk-ways and shall not cut campus at anytime.
5. Freshmen are urged to attend all home football games and all Pop Rallies.
6. Freshmen will be required to sing or recite upon request at anytime the following:
  - a. Alma Mater
  - b. The year which Marshall was founded
  - c. The name of the President and Vice-President of the Student Body.
  - d. The school song "We Are the Sons of Marshall"
  - e. The name of the President of the University
  - f. The name of the Dean of Men, Dean of Women, the name of your own academic Dean, and your own Academic Advisor.
7. Freshmen cannot wear any article of clothing that pertains to any school other than Marshall University.
8. Freshmen cannot sit in the booths by the windows in the Student Union, and at the request of any upperclassmen, must relinquish their seats.
9. During the Freshman Activities period, Veterans must follow all the rules as the Freshmen with the exception of purchasing beanies.

10. Freshmen are required to carry a schedule of their classes with them while on campus for as long as the Freshman Rules are in effect.

11. All Freshmen are encouraged to join the Greenbackers.

Now that you know the rules, how do you get rid of them? On September 29, at the Marshall University vs. Louisville football game, the Freshman football team will meet "selected" upperclassmen in a TUG-OF-WAR. If you win, you are free—no more Freshman Rules, however, if you lose—Well, let's hope you win.

### ALMA MATER

Marshall gracious Alma Mater  
We thy name revere;  
May each noble son and daughter  
Cherish thine honor dear.  
May thy lamp be ever bright,  
Guiding us to truth and light;  
As a beacon o'er dark water  
This is for thee our prayer.

#### Second verse:

May the years be kind to Marshall  
May she grow in fame;  
May her children fail her never,  
True to her beacon flame.  
May her spirit brave and strong  
Honor right and conquer wrong;  
This the burden of our song.  
Ever her truth proclaim.

### "WE ARE THE SONS OF MARSHALL"

We are the sons of Marshall  
Sons of the great John Marshall  
Year after year we go to Marshall U  
Cheering for the team and gaining knowledge too  
Proudly we wear our colors, Love and Loyalty we share,  
Sure from far and near you'll always hear the  
wearin' of the green  
For it's the Green and White of Marshall U.

### FRESHMAN PLEDGE

FRESHMAN PLEDGE—We, the Class of '66, pledge ourselves to uphold the traditions, the high standards, the spirit, and the ideals of Marshall University.

We do also pledge to strive to better ourselves, academically, socially, and spiritually, so that we may carry these high ideals beyond our college days.

### The History of Marshall and Proposed Expansion

1962-1963 marks the 125th year of Marshall University as an educational institution. The original one and one-half-acre site of Marshall was bought in 1837 for \$40 from John Holderby, who made the provision that the estate always be used for school purposes.

John Laidley, friend of Chief Justice John Marshall for whom the college is named, is considered the founder of Marshall University which was first known as Marshall Academy. In March, 1858, by an act of the Virginia Assembly, the Academy became Marshall College, with authority to confer degrees.

During the Civil War the school was sold because of debts, but it housed a private school during this war because of the terms of the original deed. Out of the confusion of the war, the new state of West Virginia was created, and Marshall College was soon revived under State control.

Today Marshall is a multi-million-dollar institution whose campus covers over 26 acres in the heart of Huntington. There are 17 permanent buildings and numerous temporary structures, with addition of three buildings—the Student Chapel, the new Physical Education and Health Building, and the new Men's Dormitory. Also, the university has available 62 temporary housing units for married students in its Donald Court housing project. Plus, the additional campus on Route 60 which is beginning plans.

Marshall University now maintains four divisions, each under a dean—the College of Arts and Sciences, the Teachers' College, the College of Applied Sciences, and the Graduate School—plus an Evening Program and a director of Adult Education in charge of the college extension program and the off-campus workshops.

We are accredited by the North Central Association of Colleges and Secondary Schools and the Association of Colleges for Teacher

Education. The university is approved by the American Association of University Women and is a member of the Association of American Colleges and the American Council on Education.

It is impossible to be indifferent to the progress of Marshall during the last 125 years. Even during the preceding 20 years, her expansion has been astonishing. The campus has grown, enrollment has increased, faculty members have come and gone—though some still linger.

You, as a student for the next four years, will see changes even in your short stay here. The New Men's Dormitory has been completed, and plans are underway for a class room building, auditorium, and gymnasium for the Laboratory School, and a garage and service building. We shall see these things come to pass in the next few years.

(The above history of Marshall University was taken from the Marshall College Greenbook)

## TRADITIONS

**BUST OF JOHN MARSHALL** — In front of Old Main stands the Bust of John Marshall, the founder of Marshall University. Our University was founded and named on his principles and ideals of: Equality, Democracy, and Individual Freedom.

**BEECH TREE** — The Old Beech Tree is symbolic of the tree of life, and represents the growth of Marshall Academy into the Marshall University of today. If it could only talk, many stories could it tell from the Civil War until now of the thousands of students that succeeded at Marshall and went on to greater achievements. This is also located in front of Old Main, Fagus, senior women's honorary, hold initiation here in the spring.

**ODK** — The ODK Victory Bell, next to the Music Building, is traditionally rung after each victory in the field of sports or knowledge. This tradition has dwindled but it will be renewed this year to remind all of us that victory is not always won at Fairfield Stadium or the Memorial Field House, but the every day trials and tribulations of college make the individual stronger in mind, body, and soul.

The ODK Circle is located in front of the Union tennis courts. It's a brick circle enclosed by concrete benches and has an ODK emblem in the center. This project was presented to the campus by Omicron Delta Kappa, men's leadership honorary.

It's sometimes used by organizations such as Fagus, senior women's honorary, for public initiations. Many a student has spent leisure moments sitting in the circle; thinking, conversing, or just sunning in the springtime.

**LEADERSHIP CAMP** — This is the "meeting of the campus wheels" the weekend prior to Freshman Week. During this weekend, the student senate, president and vice-president of the student body, members of the administration, officers of organizations, and those students connected with Freshman Week and Homecoming, seclude themselves at a near-by camp to plot and plan the coming school year. It's something that most of you will never attend, but for those of you fortunate enough to make the grade, it's an unforgettable and invaluable experience.

**FROSH AND UPPERCLASS TUG OF WAR** — This "Tug of War" between the freshmen football team and a group of upperclassmen symbolizes the quest of the frosh to be accepted. If the freshmen win, off come your beanies and away with Freshman Rules. But alas, if you lose, the rules stay into effect until a later date. So, lots of luck and may the best team win! The battle takes place during half-time at a football game to be announced later.

**GREEK WEEK** — The Greek fraternities and sororities unite once a year to join in the annual Greek Week. This week includes fireside chats and exchange dinners between sororities and fraternities. A parade of chariots and floats and the Greek Week Queen are usually climaxed by games and contests at a picnic. The highlight of the week is the Greek Week Dance at which is crowned the Greek Queen and King.

**HOMECOMING** — One of the biggest weekends is Homecoming, with the Alums returning to campus to renew bonds, observe the changes, and to live it up with the undergrads.

Much planning goes on prior to this weekend to insure its success. A week before Homecoming an election is held to choose class queens and "Miss Marshall." All full time women students at Marshall are eligible to run for a class queen if they have an overall "C" average. They secure a petition in the student government office and must have it signed by a certain number of members in their respective class. The best girls are chosen at the polls with the senior queen reigning over the weekend's festivities as "Miss Marshall."



A pep rally is always held on the Friday evening of the Homecoming Week End on the intramural field which leads off the big week end. Then judging of the house decorations that the dorms and sororities have slaved over follows.

On Saturday the parade begins about noon, and what a colorful spectacle! The campus beauties representing the Freshmen, Sophomore, and Junior classes will ride on a float with "Miss Marshall." The fraternities and other organizations will present floats they have constructed, and the Band, Cheerleaders, Majorettes, and the ROTC will help make it a parade to remember.

Then join with the alums and it's off to the game. This is one game you dress up for, and with the bright fall clothing that will be observed, you will notice many of the gals sporting lovely mums. The Greenbackers and an enthusiastic crowd are sure to give us a victory. After the game comes a round of reunions, open houses, and parties. This leaves you just enough time to quickly change into party clothes, and it's off to the Memorial Field House, and you'll dance the night away to a "name" band, with the highlights of the evening being the announcement of the winners of the house decorations and the floats.

Oh! You'll be tired when you finally sink into bed that night, but we bet you'll never forget the fun and excitement of this memorable week end.

**LIFE PLANNING WEEK** — This is one week set aside during second semester for you, the student, to evaluate yourself, your life, and your future. Speakers are brought in from all parts of the nation to speak to classes, the entire campus, and "fireside" groups. This period is set aside for re-examining our ideas about why we're here and where we're going. It serves as an inspiration to many students who find themselves confused as to life's problem. Religion plays a part in this week, of course, but what kind of life would a person have with no religion? Take advantage of this week and what it has to offer; you'll profit tremendously.

**UGLY MAN CONTEST** — Alpha Phi Omega, men's service honorary, sponsors a contest to find the "ugliest man on the campus." Of course, Marshall has no ugly men, so some must be made. The social organizations, either separately or two combined, select a subject and then produce a photograph by trick photography or makeup of the ugliest human (?) specimen possible. Some of the results put Lon Chaney to shame!

The pictures are then published in the Parthenon and circulated around campus. The climax of the event is a mix in the union at which the student body elects the ugliest picture by paying for a vote. It's a huge success each year, and we all look forward to it. You will too, especially after you've seen some of the pictures. The proceeds from this contest are donated by Alpha Phi Omega to the college intramural program.

**PARENTS' WEEK END** — Parents' Week End along with Homecoming is one of the big events of our college year. This is the time the University shows off, and all departments and the student body presents a complete series of entertaining and informative activities from the time parents' week end opens until it closes on Sunday afternoon. Start telling your parents about this now, so that when spring comes around, they will be sure to come. The highlight of this week end is the Mothers' Day Sing.

**MOTHERS' DAY SING** — This is the big day for the social organizations as well as a day of tribute to our mothers. These organizations work for months prior to the Sing preparing songs. On the day of the Sing, each group participates in the contest with the winning fraternity and sorority receiving a permanent trophy. The dormitories and social organization always hold open house for you and the public afterwards in order to complete the day's activities.

## THE INDIVIDUALS WHO RUN OUR CAMPUS THE UNIVERSITY ADMINISTRATION

Every student finds himself in need of seeing one of the university administrators at some time and should know where to find them. The first floor of Old Main houses our administrative personnel, and their office hours are from 8:00 A. M. to 4:15 P. M. Office hours for your individual instructors will vary, so check with them for the office location and office hours.

One of the first men you will come in contact with during Freshman Week is our PRESIDENT, Dr. Stewart H. Smith. Once he has met you, he does not often forget your name or face and always has a kind word for everyone. It is through the work of such men as our President that Marshall University has grown in size and prestige. His office, Room 108, is open to all, and he will be glad to aid you in problems which your advisor or dean cannot solve.

Dr. Harold Walker, VICE-PRESIDENT OF ACADEMIC AFFAIRS, is in the former Dean of Men's office, Room 110. This is a

new position and, as Dr. Walker says, "we are still defining the duties of the position."

The new VICE-PRESIDENT OF BUSINESS AND FINANCE, Mr. Joseph S. Soto, is the man in charge of money.

The REGISTRAR, Mr. Luther E. Bledsoe, is your guardian from the time you apply for admission to Marshall until you finally graduate. The services he renders range from Freshman Week, Registration, and transcripts to college catalogues, and caps and gowns. This is the office which takes care of you Veterans. You will find Mr. Bledsoe in Room 106.

Mr. Fred Smith, the COMPTROLLER, handles all your money. He is located in Room 103, and this is where you pay your tuition, room and board, receive loans, and rent hall lockers.

Mr. Paul H. Collins, ADMINISTRATIVE ASSISTANT AND DIRECTOR OF ADULT EDUCATION, serves as Administrative Assistant to the President of the University. He is also Director of Adult Education, and in this capacity he initiates, organizes, and administers off-campus and certain campus activities. For example, he is in charge of the extension class program and the college evening program. His office is located in Room 107.

You women will get to know well our DEAN OF WOMEN, Mrs. Lillian Helms Buskirk, before you leave Marshall. Her office is located in Room 109, and she will be glad to offer advice or give you help with any problems you may come up against during your college career.

Our new DEAN OF MEN, Mr. Stanley A. Shaw, handles any difficulty the men run into. His office, Room 116, handles loans and scholarships, lost and found, traffic and parking violations, men's housing, fraternities, and counselling. Mailboxes for campus organizations and a campus bulletin board are also found in his office.

Dean J. Frank Bartlett of the COLLEGE OF ARTS AND SCIENCES is the man to see about your academic problems if your advisor cannot help you. He is the man to see about changing your major or obtaining a credit evaluation. Dean Bartlett's office is found in Room 115.

Dean of the TEACHERS' COLLEGE, is Dr. D. Banks Wilburn who serves in the same capacity for those of you in the teaching field as Dean Bartlett does in the fields of arts and sciences. In his office, Room 113, you may get a credit evaluation in the teaching field.

Dr. A. E. McCaskey is Dean of the newly established COLLEGE OF APPLIED SCIENCES. Dean McCaskey's new college embraces engineering, the Reserve Officers' Training Corps, the new nursing education department, and the medical technology training program. His office is located in Room 116.

After receiving your college diploma, and you decide to do graduate work, the man who will handle your affairs is Dr. A. E. Harris, Dean of the GRADUATE SCHOOL. His office is located in Room 111.

Mr. Frank Spear, INFORMATION DIRECTOR, releases news to local and hometown newspapers and to radio and TV stations.

PLACEMENT DIRECTOR, Mr. Robert Alexander, acts as a go-between for students seeking jobs, and employees seeking personnel.

The James E. Morrow Library, named for a former president of Marshall, is headed by Mr. Harold Apel, LIBRARIAN. It is the third largest library in the state and contains over 120,000 volumes.

Mr. John Sayre is DIRECTOR OF DEVELOPMENT AND ALUMNI AFFAIRS.

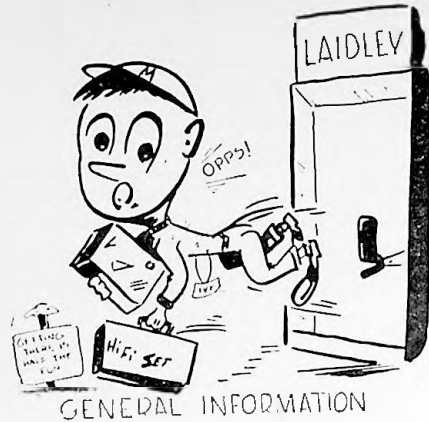

## ADDITIONAL PERSONNEL AND FACILITIES

**HEALTH CLINIC** — All full-time students receive the clinic's services free after having paid their health fee during registration. The clinic is located in the new Physical Education Building on 18th Street between Virginia and College Avenues. This office is open from 8 to 12 AM and from 1 to 4:45 PM on week days; and 8 to 12 AM on Saturdays. Dr. Charles H. Hagan, the university physician is there from 9 to 12 AM, but Mrs. Mary D. Summers, the university nurse, is present at all times during hours to treat you. If you need medicine, a shot, or a physical examination, the clinic will be glad to serve you.

**SHAWKEY STUDENT UNION** — Mr. Don Morris manages the Shawkey Student Union which is named after one of Marshall's past presidents, Morris P. Shawkey. The Student Union is the center of social activity on campus. On the first floor are found a lunch counter, a lounge, and dance area. Bridge, checkers, and chess facilities are available during the hours of operation which starts at 7:30 AM and close at 9:00 PM. Hours on Saturdays are from 7:30 AM to 2:00 PM, and the Union is closed all day Sunday. In the basement are found pool and ping-pong tables (you must furnish your own ping-pong balls which may be bought at the lunch counter). On the second floor are found the office of the college annual staff — The Chief Justice, two conference rooms, and a music room where television and record facilities are available. The Student Government Office is found in

the right wing of the Student Union, and we urge you to take an interest in and participate in the campus government.

On each Wednesday night a student mix is held from 7:30 PM until 9:45 PM when women must be in the dorms for the night. Most of the mixes are free, but when sponsored by a group or organization, there is a nominal fee of \$.25. Just one word of warning — you do not receive a grade in "unionology", so spend some time on your studies.

**BOOKSTORE** — The Book Store is located in the basement of Old Main, under the management of Mr. Percy L. Galloway. Here you buy your textbooks, drafting equipment, art supplies, and desk supplies. It is open from 8 to 12 AM and from 1 to 4:15 PM during the school week; and 8 to 12 AM on Saturdays. Checks will be accepted for the purchase of supplies.

**POST OFFICE** — Located adjacent to the Bookstore and also run by Mr. Galloway, the hours are the same as for the bookstore, and they handle all mail coming in and going out of the university. They don't mail packages, but the store will if you have the correct postage on them. A subdivision of the downtown post office is located on Third Avenue above 20th Street; it's best to have packages handled there.

**PLACEMENT OFFICE** — On campus and off campus jobs may be found by inquiring in the Placement Office managed by Mr. Robert P. Alexander. His office is located in Room 114 of Old Main. Hours are from 8 to 4:15. Checking in this office will save you a lot of trouble walking the streets of Huntington looking for employment.

**BUILDING AND GROUNDS** — Here is found the crew who keep the campus clean and attractive. The office is located in the basement of Old Main and is open from 6 until 4:30. If you need something repaired, want to borrow a tool, or need paint for your room, this is the place to have it taken care of.

**DUPLICATING DEPARTMENT** — Managed by Mrs. James Bias, the Duplicating Department is located across from the Book Store in the basement of Old Main and is open from 8 to 4:15. If you need some printing done for your dormitory, organization, or committee, this is the department that will handle it for you.

**CAFETERIA** — Located between Laidley and Hodges Halls at the east end of the campus, they serve breakfast from 7 to 9 AM; lunch from 11 to 1:30 PM; and dinner from 5 until 6:30 PM. Saturday

lunch is served from 11 to 12. On Sunday, breakfast is served from 8:30 until 9:30 AM; lunch from 12 to 1 PM; no dinner is served on Sunday.

**INFORMATION DESK** — This office is located across the hall from the Registrar's Office, and there is always someone on duty from 8 to 4:30 to direct you to any place on campus.

**INFORMATION SERVICE** — Located in Room 112 of Old Main, this office is under the direction of Mr. Frank E. Spear, Information Director, and it handles the publicity, publications, and public relations of Marshall University. Check here if you need anything along this line.

**DEVELOPMENT AND ALUMNI AFFAIRS** — Located in Room 129 of Old Main, John Sayre directs the affairs of this office which acts as a link between the university, its alumni, and all other interested groups. When you have completed your work here, this will be the office to keep informed of the progress of Marshall, but until that time, this office will be working with you on such activities as Homecoming and Parents' Week End.

**SPEECH CLINIC** — The Speech Clinic is located in the Science Hall, Room 18. This facility provides special help in correcting speech defects.

**RELIGIOUS COUNSELING** — This is handled by The Reverend Lander Beal in the Student Chapel. The Reverend Beal is a personable man who can be of great help to you regardless of whether your problems are of a religious nature or not.

**PARKING** — This will be a daily problem to you car owners. Daytime parking in the university parking lot behind the Science Hall is reserved for the faculty and those cars with special permits issued by the Dean of Men. The lot is open to everyone after school hours. Dorm residents park behind the dorms they live in. Students may park wherever it is legal on the streets, and first come, first served. You may have to park five or six blocks from the campus. If you park on Fifth Avenue, make sure you move your car before three o'clock, or you will find a \$5 parking ticket on your windshield. There is no parking on Fifth Avenue between the hours of 3 PM and 6 PM. Limited parking is available in the Engineering Building Lot, corner 5th Avenue and 19th Street.

If you violate the above rules concerning parking on the campus, you **MUST** report to the Dean of Men's Office within 24 hours after

the issuance of a ticket. All tickets given by city police concerning parking on the city streets must be handled at the city police station and need not be reported to the Dean of Men's Office. Explanation of campus parking violations: first ticket is a warning; second offense means an appearance before the traffic committee; third offense means an appearance before the Administrative Cabinet and a possible suspension from school.

**JAMES E. MORROW LIBRARY** — You will become familiar with this building during your next four years at Marshall. There is unlimited reference material available in the library which will be of valuable help to you in your classwork, and a great supplement to your learning in the classroom. Try to spend more time in the library both to accomplish studying and to broaden your scope of knowledge.

Library hours during the school week are from 8 AM to 9:30 PM; and 8 AM to 5 PM on Saturdays. If you are unable to find the material you desire, ask the person on duty at the desk, and they will be able to offer you assistance.

The journalism department is located in the basement of the library, and it is here that the school newspaper, the **PARTHENON**, is published.

**PSYCHOLOGICAL CLINIC** — The Psychological Clinic, Room M307, is open to full-time students for consultation on scholastic, vocational, social, and personal problems. Students are invited to make use of the clinic.

## **CLOTHES AND MANNERS TO FIT THE OCCASION FOR WOMEN ONLY**

Here's what you've been wondering about all summer: what to wear and when. Since Marshall is a friendly and informal place, the same clothes you wore in high school will suffice as proper attire here. The same skirts and sweaters you wore in high school with bobby socks and loafers, flats, or tennis shoes are traditional for class. You will find blouses of any style and color will be especially convenient because they're easy to wash in the dorm, once you catch on!

In the dorm, plan to get plenty of wear out of your bermudas; slacks are standard library equipment. But do remember to always look neat regardless of your attire. Bermudas and peggers are right

in style in the spring and fall, and shorts are acceptable on the tennis courts only.

For dating, a matched skirt and sweater with heels and earrings are good for Saturday night movies and also for the Community Forums. Ball games call for the same with a date; but if you're temporarily dateless, flats will be suitable. Our gals go in a casual skirt and sweater to week-day basketball games, but add heels for the week-end games. Skirts and sweaters are also fine for the Wednesday night mix.

For Artist Series and "special dates," you'll need a party or dressy wool dress. Teas and receptions usually call for hat and gloves as does church. You'll find that a good basic suit, possibly a walking suit, is invaluable. Floor-length formals are not the rule at formal dances, but they are nice if available; however, a street-length formal with or without short gloves will do. Informal dances call for cocktail dresses or costumes. Speaking of costume dances, old costumes will do fine, but be sure to keep them in good taste. For the most important dance of all—Homecoming—be sure to wear a cocktail dress.

Indispensable on Marshall's campus is a raincoat and umbrella. Boots are handy too when the sidewalks are covered during the annual monsoon season each spring. Also, Huntington has cold winters, so you'll need a heavy winter coat, a carcoat, gloves, and scarves. During the spring, blazers are very popular.

As for beauty and make-up, look natural—please! There is no substitute for natural beauty. Just ask the University men. Hair styles are casual with versatility the key.

You're a smart shopper if you buy outfits which mix and match well. You'll find that you don't need as much as you probably expected. Huntington has quite a few dress shops which carry stylish yet reasonable clothes. So have some of your clothes allowance to spend here.

As far as etiquette is concerned, just remember, "always be a lady." You know to be polite and show respect for your elders and persons of authority; you know to thank your date for a wonderful time and to be attentive to him while on a date; and you know to be considerate of your roommate and others around you. So relax and have a good time, but always remember that whatever you do in public is seen by someone else. Here is a tip to you girls who plan to rush: sororities are very interested in your neat appearance and polite personality.

## CLOTHES AND MANNERS TO FIT THE OCCASION FOR MEN ONLY

Casual and comfortable are the keywords for attire of Marshall men. A neat sports shirt and khakis or cords will do for class, also crew neck sweaters and dress pants. Wash and wear fabrics are economical and a good substitute for the jeans you wore in high school. Suits and ties are worn by some to class, but it's entirely up to you. But remember, guys, to get a date you'll be in competition, and your appearance at all times is important.

Loafers are good for the feet, but don't forget neat dress shoes for "special dates." You'll have plenty of opportunity to wear those tennis shoes, too. Wear a suit and tie on dates, for movies, and ball games. Dress accordingly to what your date is wearing is a good rule to follow.

Formal clothes are nice to have, but are not a necessity. A tux is usually worn to a winter formal (a dark suit will do), and a white dinner jacket is traditional at a spring formal.

Trench coats and water repellent garardines are popular as well as necessary during the rainy season. Most of our men also carry absolutely huge black umbrellas (which serve as an introduction to that beautiful coed standing in the rain). A heavy top-coat and jacket are necessary for winter. Hats are up to you; they are fine for dress wear, cold football games, or in a windy convertible.

Your old high school sweat shirt and pants are fine for sports when it's cold; tennis shoes, swimming trunks, and T-shirts are fine for doing what comes athletically. You'll be able to wear those bermudas and beachcombers too.

Impressing girls by doing crazy things like you did in high school just won't work here; you're in college now, so act accordingly. Our gals like gentlemen; they appreciate it when you open a door for them, or take their arm when crossing the street. Help them put on their wraps, and compliment them on that dress which was worn especially for you. Just be yourself with a little added polish, and you'll get along swell, be it a professor, a date, a fraternity you're rushing, or another guy.



## GET ACQUAINTED WITH CULTURE

In your well-rounded program at Marshall University, don't forget the cultural activities offered. Although you may have neglected culture in high school, it can be very enjoyable. It is as much a part of your education as the development of your mind and personality. Marshall offers one of the best cultural programs in the country and you have already paid for it, so take advantage of it.

With the purchase of your student activity card, you buy your way to numerous professional performances of national and international reputation, including symphony orchestras, operas, Broadway plays, ballets, and big name concerts. These ARTISTS SERIES are held downtown at the Keith-Albee Theatre.

The COMMUNITY FORUMS are held in Old Main Auditorium and feature internationally known lecturers on literature, science, travel, current affairs, and other interesting topics.

CONVOCATIONS are held on Thursdays at 11:00 A.M. in Old Main Auditorium at least once a month. These programs are numerous and varied.

The ARTISTS SERIES, FORUMS, and CONVOCATIONS are the "big three," but don't overlook our University theatre. Half the fun is the development of your own special talents, you know. If you participated in high school plays or have a suppressed desire to be on the stage, look into the University Theatre. Tryouts are open to the entire student body regardless of experience. Normally four full-length plays and several studio and experimental dramas are produced each year. So try out for one; you may discover acting is your hidden talent!

Art lovers, the Huntington Galleries is for you. Located on Eighth Street Road, you'll find various exhibits offered during the year as well as the standard exhibits such as the gun and silver collections. You will also find exhibitions on the first floor of our own library at various times during the year. If you're really interested in art, take a class in it. You'll be surprised at what you learn.

For music lovers, there are all types of music albums available for your use in the Student Union lounge on the second floor. Just see Don Morris, Student Union Manager, make your selection of music, check these selections out, and relax. There is also a television set in the second floor lounge for your enjoyment.

You can find rooms of pianos and musical instruments if you investigate the music building. You'll also meet people who share your common interest in music. Why not join the marching or concert bands, the symphony orchestra, the symphonic or men's concert choirs? As we suggested in art, why not take a music class, if only for sheer enjoyment.

Investigate the upstairs of the library; there is found a multitude of books from which you can glean knowledge which will aid your cultural development. It's fun to acquire a little culture, and it doesn't hurt at all. Culture is not something to be avoided, so try some.

Additional Campus on Route 60.

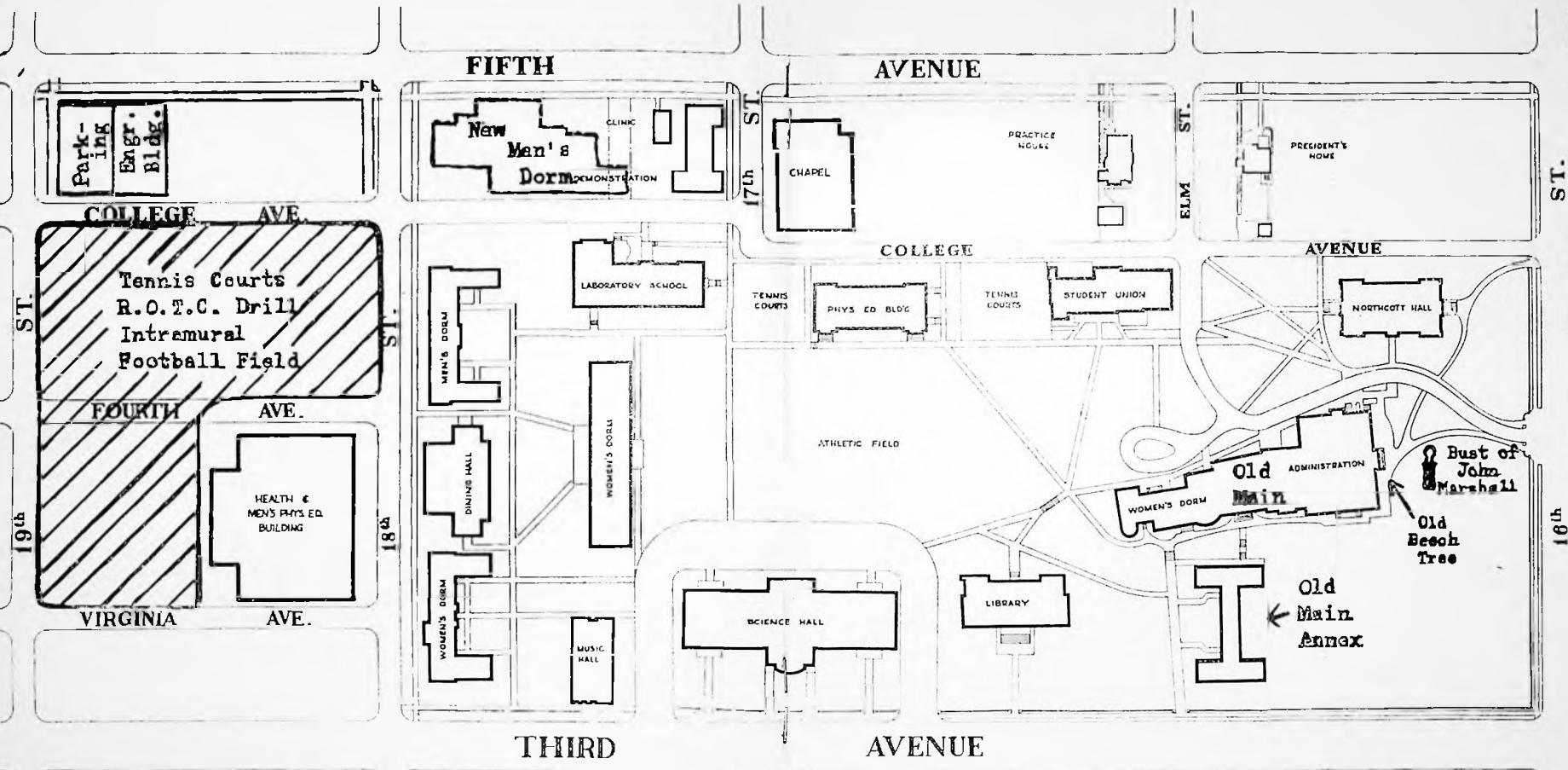

MAP OF

MARSHALL UNIVERSITY

HUNTINGTON, W. VA.

## ENTERTAINMENT

Believe it or not, you'll find you have some leisure time. To fill it, try the wide range of entertainment which is concentrated within the tri-state area. Entertainment will naturally differ with the individual, but here are some suggestions on how to use your leisure time in our city.

Fourth Avenue is the main street of the city. On this street about seven blocks from the campus is located the theatre area. Three theatres are located in this section; they offer special student rates if you take your ID card. There are several drive-in theatres in Huntington or the surrounding area.

The city maintains Ritter Park and several other smaller parks, with their recreational facilities. In Huntington is also found Dreamland and the Olympic Pool, superior recreational sites. If the tennis courts on campus are filled, try the ones in Ritter Park. Camden Park also offers many fun-filled amusements.

Huntington offers horseback riding, golf, swimming, hiking, bowling, car rentals, airplane rides, and boating facilities. Miniature golf is one of our most popular recreations.

The YMCA and YWCA are sources of varied activities. Classes in swimming, first aid, handicraft, and lounging facilities are available to students. Neophyte artists can find direction for their talents in classes at the Huntington Galleries, the only one of its kind in the state.

Nationally known entertainers often visit Huntington. All you need to do is read the ads in the newspapers to find out when they are to appear.

Students are always welcomed as helpers with such activities as the Girl Scouts, Boy Scouts, Campfire Girls, and related youth groups.

If show business is your calling, you'll find collegians have an opportunity to try their talents in front of the footlights of the Community Players, located at the Abbot Theatre, which is on West Fourteenth Street.

Just so you won't get lost, remember that the avenues run east and west and are numbered beginning at the river. The streets run north and south and are numbered in both directions from First Street, which is located fifteen blocks west of the campus. Buses make regular runs, and taxis are always available.

## NEARBY CHURCHES

Just because you are away from home, you must not neglect your spiritual life. No matter what your church preference might be, Huntington can accommodate you. In fact, it has been called "the city of churches," and you will soon realize why. There are nearly fifty churches and one will suit you.

Following is a list of churches that most of our students attend. The entire list of churches can be found in the yellow section of the telephone directory. You can always find someone on campus who will go with you, so don't worry about being by yourself. Many churches are within walking distance, and most of the outlying churches will be glad to furnish transportation if you are interested in attending their services.

- Central Christian—1202 Fifth Avenue
- Emmanuel Methodist—18th Street and Sixth Avenue
- Enslow Park Presbyterian—Enslow and Washington Boulevards
- Fifth Avenue Baptist—1135 Fifth Avenue
- Fifth Avenue Church of God—2128 Fifth Avenue
- First Church of Christ's Scientists—1101 Twelfth Avenue
- First Congregational—707 Fifth Avenue
- First Methodist—1124 Fifth Avenue
- First Presbyterian—1015 Fifth Avenue
- First Evangelical United Brethren—21st Street at Fifth Avenue
- Hellenic Orthodox, Saint George—7th Street at Eleventh Avenue
- Johnson Memorial Methodist—10th Street and Fifth Avenue
- Ohev Shalom Temple—949 Tenth Avenue
- Pilgrim Holiness—20th Street and Ninth Avenue
- St. Paul's Evangelical Lutheran Church—721 Twelfth Avenue
- St. Joseph's Roman Catholic—519 Thirteenth Street
- Sixth Avenue Church of Christ—530 Twentieth Street
- Trinity Episcopal—520 Eleventh Street
- Twentieth Street Baptist—20th Street and Fifth Avenue



## EXTRA CURRICULAR ACTIVITIES

**UNIVERSITY THEATRE**—For thirty-six years the University Theatre has given training in dramatic skills and techniques, and has helped students to develop such qualities as poise, confidence, initiative, self-reliance, and cooperativeness. It also helps to encourage appreciation of dramatic literature, and to help keep alive the plays which have made dramatic history.

The Theatre presents four plays each year and weekly plays which are presented on the Marshall Radio Station WMUL. All students are eligible for parts or work as directors, stage hands, etc. Any student interested in dramatics should participate in University Theatre. The play productions class is in charge of the stage setting and props.

The University Theatre is supervised by Clayton Page. Alpha Psi Omega is the top honor that a drama student can obtain.

**CHORAL UNION** — The Choral Union is composed of members of all the choirs in the music department, united in order to present productions such as the "Messiah" and the "Requiem."

**A CAPELLA CHOIR**—This is the training ground for freshmen interested in participating in choral work. From this group freshmen advance to the Men's Concert or Symphonic Choir.

**SYMPHONIC CHOIR** — This is a choir for the sophomore, junior, and senior women.

**MEN'S CONCERT CHOIR** — This is the all-male touring group for upperclassmen.

**MARSHALL UNIVERSITY DEBATE TEAM** — Debating at Marshall is an intercollegiate activity. It offers you a chance to gain recognition for you and your school, and it is an invaluable opportunity for all students, especially those in Law, Political Science, or Economics, to develop and further their ability to think and speak effectively under pressure.

The team enters about eight tournaments each year and culminates the season by participating in the State Intercollegiate Speech Tournament and the National or Regional Pi Kappa Delta meet. Outstanding debaters may gain membership in Pi Kappa Delta, national debate fraternity.

**MARSHALL UNIVERSITY BAND** — This group is open to any student who is interested in being a part of a marching or a concert

band. The band under the direction of Thomas O'Connell performs at all home football games and sometimes attends away games. It also plays for the basketball games. The marching band with a few minor changes, becomes a concert band for many college programs. Both men and women students are eligible to participate in the band.

**RADIO** — The Marshall University Radio Station (WMUL) was reopened this year and has been a success. The station broadcasts on 88.1 megacycles on the FM band from 7-10 A. M. and 3-10 P. M., Monday thru Friday. The programs vary from popular, jazz, and classical music to news, weather, sports, and other campus activities.

Participation is open to all Marshall students and participation gives them a broad background and knowledge in radio and TV.

Director of the university radio and television facilities is Dr. Stephen Buell, Assistant Professor of Speech.

## LET'S GET ACADEMIC

If you are to achieve your purpose at Marshall University, you must learn how to study now. Studying is a term representing various activities, and thus there are various methods of study. There is no recipe or surefire solution to passing your next four years at Marshall. What works best for you may flunk your roommate. No two individuals can study exactly alike. The best policy is to formulate your own pattern. However, we'll try to let you in on a few of our time-tested procedures.

Buy your books early. Then read the preface and introduction before going to class the first time. DON'T be afraid to ask questions this or ANY other day. DON'T be afraid of the professor. He is sincerely interested in your abilities, so get acquainted and show an interest in the course.

Note-taking is a necessity at college and quite different from high school. Our professors move fast; they have to in order to cover all the material in one short semester. Take notes in ink on standard size paper; then you can read them at exam time. Keep them organized, dated, and in a notebook so you won't lose half a semester's work if you drop a book sometime.

You can usually detect possible test questions by the emphasis put on certain points in lecture. MARK IT IN RED OR STAR IT. Speaking of exams, find out what type your professor will give: essay

or objective. Knowing what to study makes your studying easier. You may also have "pop quizzes" so be prepared each day. Many students recommend a short review period and a good night's sleep before a test. If this plan works for you—congratulations! If not, join the rest of us and burn the midnight oil. However, you cannot be expected to cram millions of facts into your head if you have not heard them before or read the chapters. Exams are one of the few ways that professors have to measure your progress.

For each hour in class, two out-of-class hours of preparation are recommended. Some classes may not require this while in others, you will have to devote far more time. Always have assignments ready to turn in and have chapters read before class.

Marshall is small enough to afford a close student-professor relationship, so take advantage of it. You won't get ribbed as you probably were in high school for getting to know your professor. We like our "profs"; we get to know them. If you're floundering when it comes to asking questions in class or if you need special help, make an appointment to see your professor.

Unfortunately, final exams are a necessary evil. We hate 'em, but we take 'em. A final can be a complete review or merely cover the segment since the last test. After you're through that first final week, you're one of the gang. Finals will be tough. They can raise or lower a grade, so study, but don't PANIC when this week rolls around. It is best to begin studying early and to get plenty of sleep.

Your big academic aim is the Dean's list. This is for the students each semester making a 3.0 average or better. Work for it.

We don't advise cutting class. However, if you find it necessary to miss class, be sure you know the policy of your professor before doing so, or you may get a grade cut. When you're sick, call your dean's office, and they will contact your professor. However, this does not automatically excuse you from class. Upon returning to class, be sure to explain why you were absent, and then you will be responsible for making up the work you missed. You may find it necessary to crawl to class for some professors, so do it without question. If you miss a class because of a school activity such as intercollegiate sports, debates, choir trips, etc., the department head will notify your instructors.

Along the line of class etiquette, call a professor by his correct title. The faculty directory tells you whether it is Mister, Doctor,

Professor, Mrs. or Miss. They have worked long earning their titles, so call them by the correct one. You had better get used to the idea of being called Mister or Miss yourself: this isn't high school. An instructor also appreciates a student who is on time.

A final word, remember your first and primary aim in coming to Marshall is TO OBTAIN AN EDUCATION — aside from you "husband-hunting" females. But remember, girls, Marshall men like their women to have brains as well as beauty.

At college, learning is no longer "candy-coated." The responsibility now lies upon YOU.

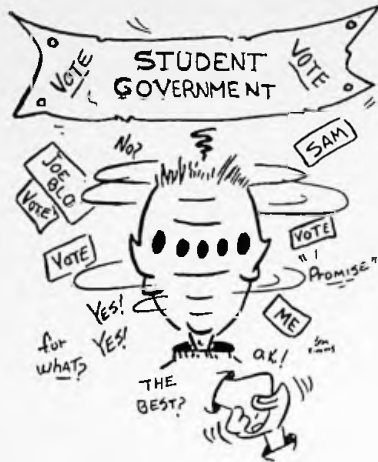

## STUDENT GOVERNMENT

The purpose of Student Government is to provide an instrument which will make it possible for all students to have a voice in any program which would make Marshall a better University. It is constructed to represent democratically all members of the Student Body. It is designed to reflect student opinion, and to crystallize and make effective any constructive program. It encourages initiative and civic development; it trains for intelligent citizenship.

Our Student Government, like the federal government, is composed of three branches: The EXECUTIVE, The LEGISLATIVE, and The JUDICIAL.

The EXECUTIVE portion of the government is directed by the President of the Student Body. Under the President serving in executive capacity are the STUDENT EXECUTIVE CABINET Secretaries and the COMMISSIONS. The Student Cabinet acts as an advisory group to the President and its members include the Secretaries of Academic Affairs, Athletic Affairs, Publications and Public Relations, Social Affairs, and Student Government Affairs, and The Executive Secretary, the Business Manager, and the Vice-President of the Student Body. The Commission heads, better known as Co-ordinators, serve over the various Student Government Commissions. These Coordinators, five cabinet secretaries, the Business Manager, and the Executive

Secretary are all appointed by the Student Body President and are subject to approval of the Student Senate.

The LEGISLATIVE branch of Student Government is the STUDENT SENATE. This is the elected branch. This fall you will go to the polls and elect Four Regular Senators, one Alternate Senator, and a Freshman Class President to voice your opinion in the Student Senate. In the springtime Genrec! Elections are held each year to elect upperclass representatives to the Senate, our lawmaking body. The Student Senate meets each Wednesday night at 6:30 P. M. in the Student Government Office, and anyone may attend the meeting to watch his representative in action. If you think you might be willing to "try your luck" during Frosh elections, try to attend a Senate meeting. The Vice-President of the Student Body serves as the Speaker of the Senate, the Senate's presiding officer.

The JUDICIAL branch of our government consists of eight Student Court Justices and the chairman of the court who is the Chief Justice. The President of the Student Body appoints the court members and the Chief Justice, and the Student Senate must approve these appointments.

Active in many campus activities, Student Government sponsors the following: Homecoming, Life Planning Week, Parents' Weekend, Leadership Camp, the Greenbackers, Student Elections, Freshman Activities, and the Blood Drives. These are only a few, as you may see by consulting the chart of student government.

Incoming freshmen can take an active part in student government activities. Freshmen elections will be held just a few weeks after the opening of school and you will be given a chance to elect six representatives from your class to the Senate. However, this is by no means the only way you may enter into the activities of your college government. There are many commissions which are formed during the first few months of school, so just drop in the Student Government Office, and fill out an application. Commission coordinators always consult the file of appointments in selecting their commissions.

## STUDENT GOVERNMENT MEMBERS

President of the Student Body ..... Gary McMillan  
 Vice President of the Student Body ..... Wait Cosby

## THE STUDENT SENATE

Senior Class Senators: Tom Dunfee, Clark Todd, Ivan Ash, Barbara Shinn, Georgann Hanna, Alternate.

**Junior Class Senators:** Marna Paulovicks, Frank Varocalli, Ken Gainer, Lily Naylor, Alternate.

**Sophomore Class Senators:** Hobart Raikes, Francis Tabi, Brenda Hubbard, Janet Stewart, Dick Caltrill.

## RECOGNITION AND HONORARY ORGANIZATIONS

**ALPHA EPSILON DELTA** — Honorary pre-med fraternity for students with an over all 2.8 academic average.

**ALPHA KAPPA DELTA** — Honorary sociology fraternity.

**ALPHA LAMBDA DELTA** — Honorary academic fraternity for freshmen women who attain a 3.5 academic average the first semester of the freshman year or a 3.5 over all average at the end of the second semester of the freshman year.

**ALPHA PHI OMEGA** — National service fraternity for men who have previously been in scouting and have attained good scholastic standards.

**ALPHA PSI OMEGA** — National dramatics fraternity.

**CHI BETA PHI** — National science honorary fraternity. Membership is extended to these students majoring in one of the sciences who has attained at least 20 hours in his science field with a 3.0 academic average in science and an over all 3.0 average.

**D-RHO-D THETA** — Honorary engineering fraternity.

**DELTA OMICRON** — National music honorary fraternity. Membership is extended to those who have attained a 3.0 average in music and at least a 2.0 over all average.

**ETA MU PI** — National recognition fraternity for retailing students.

**ETA SIGMA PHI** — National honorary fraternity for students of classical languages.

**FAGUS** — Senior women's leadership honorary fraternity which was founded in 1950-51 on Marshall's Campus by local members of Mortar Board, national senior women's honorary. Members are elected the second semester of their junior year on the basis of scholarship, leadership, character, and service.

**FOURTH ESTATE** — Women's honorary journalism fraternity.

**GAMMA THETA UPSILON** — National geographical honorary fraternity.

**KAPPA DELTA PI** — National education honorary fraternity. Membership is extended to students in Teachers College who maintain an overall 3.0 average.

**KAPPA OMICRON PHI** — National home economics honorary fraternity.

**OMICRON DELTA KAPPA** — Men's national leadership honorary fraternity for Junior and Seniors which was established on Marshall's campus in 1947. Members are selected on the basis of good scholarship and leadership in three fields.

**PHI ALPHA THETA** — National honorary history fraternity.

**PERSHING RIFLES** — Military honorary for freshmen and sophomores.

**PHI ETA SIGMA** — Honorary academic fraternity for freshmen men who attain a 3.5 academic average during their first year of college.

**PHI MU ALPHA** — National music honorary fraternity.

**PI DELTA PHI** — National French honorary fraternity. Membership is extended to those attaining a 3.0 average in French and one advanced course and an 2.8 over all average.

**PI KAPPA DELTA** — National debate honorary fraternity. Membership is extended to those who have participated in five judged debates.

**PI SIGMA ALPHA** — National political science honorary fraternity.

**PI OMEGA PI** — National business education honorary fraternity.

**PRESS CLUB** — Men's honorary journalism fraternity.

**PSI CHI** — National honorary psychology fraternity. Membership is extended to any student majoring or minoring in psychology who have completed 12 hours with a 3.0 average and maintaining a 3.0 over all average.

**ROBE** — Local men's honorary fraternity which strives to promote school spirit and student participation in projects that further the purpose of the college.

**SCABBARD AND BLADE** — National junior and senior military honorary fraternity.

**SIGMA DELTA PI** — National Spanish honorary fraternity.

## RESERVE OFFICER TRAINING CORPS

The ROTC's battle group is composed of the men in companies A, B, C, D, N, and Headquarters. Each Tuesday at 11 A. M. the battle group converges on the drill field on the west campus for their regular drill. A Second Lieutenant's commission awaits the student who participates in the battle group for four years and supplements his experience with summer boot camp at Fort Knox, Kentucky. The group acts as an organization, taking part in Homecoming and the annual blood drive. Student military leadership is developed through the battle group program. Student leaders are chosen to head each company on the basis of academic ability, military skill, extra-curricular activities, and work in summer camp.

Freshmen and sophomores are eligible for membership in Pershing Rifles. Purpose of the organization is to develop a highly skilled drill team and promote brotherhood among the members of the ROTC unit.

## INTEREST ORGANIZATIONS

**ALPHA BETA ALPHA** — An organization for students interested in library science.

**AMERICAN CHEMICAL SOCIETY** — An organization for students majoring in chemistry.

**GERMAN CLUB** — An organization for students interested in German culture.

**HOME ECONOMICS CLUB** — An organization for all home economics majors.

**INTERNATIONAL RELATIONS CLUB** — An organization for those interested in foreign affairs.

**LA SOCIEDAD HISPANICA** — An organization for students interested in Spanish.

**LE DERCLE FRANCAIS** — An organization for students interested in French culture.

**MARSHALL CLASSICAL ASSOCIATION** — An organization for students interested in classical languages.

**MARSHALL ENGINEERING SOCIETY** — An organization for junior and senior engineering students.

**MUSIC EDUCATORS ASSOCIATION** — This organization is open to all music majors.

**PSI SOCIETY** — An organization for psychology majors.

**RADIO CLUB** — An organization open for all students interested in working with Marshall's radio station, WMUL-PM.

**STUDENT NATIONAL EDUCATION ASSOCIATION** — An organization for those students who plan to teach.

**VAARSITY "M" CLUB** — An organization open to students who have won a letter in an intercollegiate sport.

**VETERANS CLUB** — Membership is open to all armed forces veterans.

**WOMEN'S ATHLETIC ASSOCIATION** — An organization open to all women on the Marshall Campus.

**YOUNG DEMOCRATS CLUB** — An organization that promotes interest in the Democratic Party.

**YOUNG REPUBLICAN CLUB** — An organization that promotes interest in the Republican Party.

## SOCIAL ORGANIZATIONS

### "Greek Groups"

**INTERFRATERNITY COUNCIL** — President — Bob Herrera

This is the governing body of Greek fraternities. Presidents of the seven fraternities and two delegates from each make up this organization.

**JUNIOR INTERFRATERNITY AND PANEL COUNCILS**

These are the coordination organizations for the pledges of the fraternities and sororities.

**PANHELLENIC COUNCIL** — President — Lois Brown

This is the governing organization of the Greek sororities. Membership is restricted to the president and two delegates from each of the six sororities.

## FRATERNITIES (All National)

Alpha Sigma Phi — President — Ted Blankenship  
1540 Seventh Avenue  
Nickname — Alpha Sigs

- Kappa Alpha Order —President — Keith Brown  
1534 Fifth Avenue  
Nickname — KA's
- Kappa Alpha Psi —President — Atwood Luder  
No house at present
- Lambda Chi Alpha —President — John Bennett  
1661 Fifth Avenue  
Nickname — Lambda Chi's
- Pi Kappa Alpha —President — Dave Ballard  
1400 Fifth Avenue  
Nickname — "Pikes"
- Sigma Alpha Epsilon—President — Charles Farrell  
1401 Fifth Avenue  
Nickname — SAE's
- Sigma Phi Epsilon —President — Bob Herrema  
1661 Sixth Avenue  
Nickname — Sig Eps
- Tan Kappa Epsilon —President — John Andrews  
1402 Fifth Avenue  
Nickname — "Tekes"

### **SORORITIES (All National)**

- Alpha Chi Omega —President — Barbara Robertson  
1601 Fifth Avenue  
Nickname — Alpha Chi's
- Alpha Sigma Alpha —President — Sara Libscomb  
1637 Fifth Avenue  
Nickname — Alpha Sigma's
- Alpha Xi Delta —President — Mary Margaret Abruzzino  
1645 Fifth Avenue  
Nickname — Alpha Xi's
- Delta Zeta —President — Margaret "Peg" Hubbard  
1616 Fifth Avenue  
Nickname — DZ's
- Sigma Kappa —President — Judy Turner  
1619 Fifth Avenue  
Nickname — Sigma K's
- Sigma Sigma Sigma —President — Barbara Shinn  
1640 Fifth Avenue  
Nickname — Tri Sigs

### **"Independents"**

#### **INDEPENDENT STUDENTS ASSOCIATION —**

President — James L. Rafter — The coordinating body for the Cavaliers and Societas.

#### **CAVALIERS — President — James W. Garrett**

Independent social organization for men

#### **SOCIETAS — President — Sue Harwood**

Social independent organization for women on campus

### **RELIGIOUS GROUPS**

**KAPPA DELTA CHI** — The purpose of this organization is to stress religious life on the Marshall campus. It is open to anyone planning to enter full-time Christian service.

**CAMPUS CHRISTIAN FELLOWSHIP** — This organization serves to unite students in Christian fellowship and service. It is open to all students.

**CANTERBURY CLUB** — This organization provides worship and fellowship for Episcopal students. Meetings are held Sunday evenings at the Trinity Episcopal Church.

**NEWMAN CLUB** — This organization is the Catholic fellowship group.

**BAPTIST STUDENT FELLOWSHIP** — This group meets each Sunday evening at the Fifth Avenue Baptist Church.

**WESTMINISTER FELLOWSHIP** — This is the Presbyterian student group and meets each Sunday evening at the First Presbyterian Church.

### **STUDENT PUBLICATIONS**

**CHIEF JUSTICE** — Presenting a pictorial review of the academic, social, and athletic year plus interesting sidelights is the job of the Marshall University yearbook, the CHIEF JUSTICE. Its editor and business manager are selected by a Faculty Student Committee and approved by the Student Senate. With such a gigantic job as covering the entire college year, the Chief Justice affords freshmen an excellent opportunity to display their talents and still have fun at the same time. Your copy of the Chief Justice is paid for in your activity fee, so be sure to get it.

**THE PARTHENON** — Written and edited by students in the Journalism Department, the PARTHENON is published twice weekly during the regular school year and once a week during the summer terms. The Parthenon covers everything from club meetings and intramural games to the State Board of Education and varsity athletic contests. It is distributed each week on Wednesday and Friday in the Union, Science Hall, Old Main, and University Cafeteria. Your Activity fee also pays for your subscription to the Parthenon.

**ET CETRA** — This is the campus literary magazine published in the spring by the Et Cetra Commission of Student Government. It contains poetry, short stories, and essays. Any student may contribute material to be judged for publication in this magazine.

**STUDENT DIRECTORY** — This book is published by the Marshall University Student Government contains the name, home address, phone number, and local address of students, faculty, and administration members. It is an invaluable aid to all students.

**SHAVETAIL** — This is published by the R.O.T.C. students.



## A LOOK AT SPORTS

Marshall University is a member of the National Collegiate Athletic Association and of the Mid-American Conference which includes Bowling Green University, Kent State University, Marshall University, Miami University, Ohio University, Toledo University and Western Michigan University. Marshall competes with all the conference schools in football, basketball, baseball and golf; and with some of the conference foes in tennis, wrestling, and track. Since freshmen cannot participate in varsity athletics, a fine program has been set up to invite freshmen into the Marshall athletic program.

Here is a chance to win recognition for yourself and honors for your school; so all you freshmen try out for the sport of your choice and let's make the athletic teams of Marshall University something to be proud of.

**FOOTBALL** — Head Coach Charlie Snyder's rebuilding program is expected to start paying off this year. A talented group of sophomores is expected to give the team added strength and much needed depth. Overall we should have a fine season if you support and cheer the Big Green to victory.

This year we have many added attractions to make the games more enjoyable. There will be a Miss USA Day, High School Band Day, ROTC Day, Parent's Day, a fireworks show and the exciting Homecoming Game. In order to have a successful season, everybody must support the team, and since you freshmen represent the largest

block of Marshall students, your support is needed. So let's get behind our coaches and players and really show them that you are backing them and you want to see them win.

All home games are played at Fairfield Stadium. We have six home games and four away games that are within easy driving distance. Away games as well as home games are always fun so let's support our team both at home and away.

**BASKETBALL** — The basketball team under the direction of Jule Rivlin is expected to have a fine season due to the graduation of only one starter from the lineup. Also last year's speedy sharp-shooting freshman team will give added strength and scoring potential to the varsity. The team plays a twenty-four game schedule in addition to the Morris Harvey Invitational which will be held over the Christmas Holidays.

Here at Marshall the students support all of the athletic teams, especially basketball, because it is such an exciting sport to watch. Why not join the fun: come out and cheer your team to victory and see Marshall play such nationally known teams as Bowling Green, Ohio University, Loyola of Chicago, and Western Kentucky.

**BASEBALL** — With Coach Alvis Brown at the helm, Marshall University has built up one of the finest baseball programs in the area. The team plays two games with each of the Mid-American Conference teams plus twelve other games outside the conference.

The team had a good season last year and prospects look great this year. So if you have any talent why not try out for the team.

**WRESTLING** — Wrestling is becoming more popular each year which is evident by the increase in matches and the increase in wins each year. Last year the team finished sixth in the conference.

Wrestling affords many thrills and much entertainment. This sport offers the student who is not big enough for football or basketball the opportunity to engage in a fine competitive sport since the weight classes start at 125 pounds. If you're small or large, just as long as you're interested see Coach Ed Prelaz.

**GOLF** — Last year the golf team, the Mid-American Conference champions, had a near perfect record and one of the best teams in the history of the school. Under the direction of Neal Wilson the team plays a tough schedule against the best competition.

If you have any golfing ability at all, you are urged to try out for the team. Our home matches are held at the beautiful Guyan Country Club.

**TENNIS** — Tennis is a tough, competitive sport that is continually growing. Each year our team, coached by Ray Cumberlidge and John Noble, faces stiff competition from conference teams and from outside the conference. We usually have a winning team and prospects look good for this year. So you freshmen grab a racket and try out for the team.

**TRACK AND FIELD** — Track at Marshall continues to improve. Because of increased student interest in track, a full time coach, Charlie Kountz, has been appointed and this season all home track meets will be held at the men's physical education building. This is a sport that has many opportunities for those of you who cannot participate in the other sports. If you have any ability you are urged to try out for the team. There will be plenty of opportunity for freshmen.

Cheering our teams on to victory are the following:

The 75-piece band is beautifully led by our line of seven **MAJORETTES** and one head majorette. These girls are chosen for the honor in the spring of each year by a series of practices and tryouts. If any of you girls are interested, look forward to next spring and brush up on your marching, twirling, and smiling; that's the basis on which you are chosen.

Our cheerleaders are an outstanding crew of gals. The six regulars and two alternates are also chosen in the spring. Don't worry "fellows" you can be a cheerleader too, just try out the same time as the girls do. Also a freshmen cheerleading squad is chosen in early autumn to cheer for the freshmen teams.

The "**GREENBACKERS**," the Flash Card Section at our home football games, was organized four years ago. Its purpose is to promote school spirit and enthusiasms and to add color and life to the football games. The Greenbackers is composed of 900 members, half frosh and half upperclassmen, and they sit on the 50 yd. line. All those interested should sign up during Freshmen Week.

**INTRAMURAL** — The broad intramural program here at Marshall offers an opportunity for every student to participate in the sport or sports of his liking attempting to promote athletics in every field of athletic interest, the intramural program includes over 136 different



sports, making our intramural program the most active of any college in the nation.

The men's intramural program is directed by capable Otto "Swede" Gullickson. With the help of four student assistants and one graduate assistant, and the Intramural Board, "Swede" conducts the program very smoothly. The fraternities are very active in this program.

The Women's Athletic Association conducts a program of events and tournaments for the athletically minded girls. Sororities compete in this program on a group basis too.

## GLOSSARY

1. **AID:** Short term loans for 60 days and long term loans of 2, 3, or 4 years administered in the Dean of Men's Office, Old Main 110. There is no interest charged unless you fail to pay in the allotted time.
2. **ALUM:** Short for alumnus or alumni which means a person who has attended or been graduated from a school, college, or university.
3. **ARMOR:** Various number of pins (sorority or fraternity) worn by females.
4. **A & S STUDENT:** Anyone who is not going to be a teacher, nurse, or engineer, e. g. Arts and Science Student.
5. **BIDS:** Invitations issued to dorms, sororities, and fraternities to attend various organization dances. It also designates an invitation to join an organization.
6. **BMOG:** "Big man on the campus."
7. **BWOC:** "Big woman on campus." A gal with beauty plus brains who manages to hold honors in many campus activities.
8. **BRIDGE:** A pre-requisite to graduation; class meets daily in the Union.
9. **BULL SESSIONS:** Where anything from A to Z is discussed until the wee hours in the morning; provides for many enjoyable hours in the dorms.
10. **CAP AND GOWN:** The symbol of four (?) years of fatigue.

11. **CATALOGUE (CATALOG):** The College of Arts and Science, Teacher's College, and College of Applied Science Catalogues can be picked up in the Registrar's Office, Old Main 106.
12. **COKE PARTY:** The "get-acquainted" party given for rushees by the sororities.
13. **CRAMMING:** The painful result for those who forget to study "day by day."
14. **CULTURE:** It's not a disease, but a well-rounded student has it.
15. **DEAN'S LIST:** The entire list of students who earn a 3.0 or above during a semester.
16. **DORM:** Your home away from home during the next four years.
17. **EIGHT O'CLOCK:** Classes resulting from the theory that "The early bird gets the worm"
18. **FISH POND:** Of historical interest as Fraternity and Sorority pin-mates were at one time dunked into the Fish Pond in Ritter Park. The custom is still often observed.
19. **FINAL EXAMS:** Farewell parties sponsored by class professors at the end of each semester!!!
20. **FIRE-SIDE CHATS:** Informal talks among campus groups during Life Planning Week and Greek Week.
21. **FIW:** Failing Irregular Withdrawal—this puts you on Academic Probation. If you want to drop a class, do so through your respective College Dean. This is the Dean's "Pet Peeve."
22. **FROSH WEEK:** The first week of school dedicated to helping you freshmen become acquainted with Marshall.
23. **FLUNK:** Fail a course. You've had it, friend.
24. **GREEKS:** Anyone who is affiliated with a sorority or fraternity with Greek names.
25. **HOLIDAY:** Vacations at Thanksgiving, Christmas, and Easter.
26. **HOME COMING:** The week-end designated for the return of the ALUMS and also a "Student Remaining" week-end.
27. **I. D. CARDS:** You can pick these up during Frosh Week, and you must present them at all intercollegiate sports, cultural programs, the Library, and for voting.

28. **IFC:** Inter-Fraternity Council.
29. **LATES:** Upperclassmen get 11:00 permission on Wednesday nights several times a semester.
30. **LEADERSHIP CAMP:** A meeting of the campus leaders prior to school to plan the coming year.
31. **LOCKERS:** 12 books at a time can become mighty heavy, so go to Room 101 in Old Main, for lockers are issued there for Old Main or the Science Hall; it is one dollar per lock, but you get your money back when you return it.
32. **LOST AND FOUND:** The Dean of Women and Dean of Men handle this problem.
33. **MIX:** The Wednesday night dances in the Union.
34. **OFFICE HOURS:** 8:00 until 4:15 for all administrative personnel.
35. **PAN-HEL:** Pan-Hellenic Association.
36. **PROBATION:** When students do not make their required grades, they are limited to a 12-hour load.
37. **RUSH:** A period where sororities and rushees, and fraternities and rushees get acquainted. The sororities and fraternities finally issue bids to rushees to become affiliated with the organization.
38. **RUSHEE:** If you are rushing a fraternity or sorority, you are a RUSHEE.
39. **SACK TIME:** That longed-for break meaning "sleep-time."
40. **SCHOLARSHIPS:** These are administered at the Dean of Men's Office, Main 110.
41. **SEMESTER LOAD:** Average 16 hours; be careful, Frosh . . . don't bite off more than you can chew.
42. **SHEEP'S SKIN:** The diploma of our Alma Mater.
43. **SMOKER:** The get-acquainted gatherings for you guys; these are sponsored by the campus frats.
44. **STUDENT ACTIVITIES CARD:** Refer to the I. D. Card.
45. **SUITCASE:** Something to be used only during Thanksgiving, Christmas, Easter, and the semester break.
46. **SUITCASER:** Refers to someone who goes home every weekend and misses out on all the campus fun.
47. **SNAP:** A course which requires little or no work. We have such a thing?
48. **TGIF:** "Thank God It's Friday" parties.
49. **TRANSCRIPTS:** When transferring to another college or university, the Registrar's Office will make out the first one free, but any others will cost \$1.00 each.
50. **TRANSFER:** Comes here from another school.
51. **TUTORING SYSTEM:** Alpha Lambda Delta and Phi Eta Sigma tutor women and men respectively at \$1.00 an hour. Take advantage of this if you need it.
52. **UNIONOLOGY:** Be careful, don't spend too much time on this course. Most freshmen decide to major in it but soon change their minds.
52. **VETERANS:** All information concerning veterans is in the Registrar's Office.

NOTES