

Marshall University

Marshall Digital Scholar

Marshall University Student Handbook

University Archives

8-1963

The Student Handbook of Marshall University, 1963-1964

Marshall University

Follow this and additional works at: <https://mds.marshall.edu/studenthandbook>



Part of the [Higher Education Commons](#)

ARCHIVES

StP
1.28
1963-64

Student

Handbook

1963 - 1964

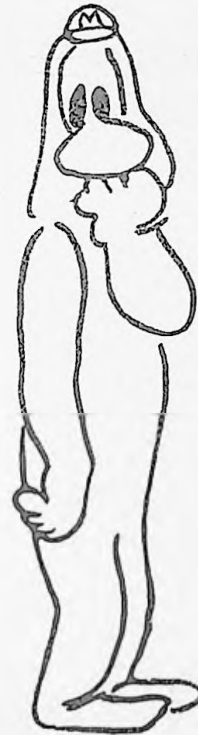

The Official STUDENT HANDBOOK

Dedicated to Miss Lucy Prichard, "capable, distinguished, and thoughtful teacher; her heart and door always open to the humblest student."



Published by

The Student Handbook Commission of the
MARSHALL UNIVERSITY STUDENT GOVERNMENT

BECKY MORRIS, EDITOR

JOHN L. JONES, BUSINESS MANAGER

John Hovey, Elaine Johnson, Vicky Miller,

Chris Adkins, John Ketchum

Middy Midkiff, J. V. Aliff

1963 - 1964

TABLE OF CONTENTS

John Marshall	3
Message from President Stewart H. Smith	4
Message from Ken Gainer, Student Body President	5
For Freshmen Only	6
Freshman Activities and Rules	6
Freshman Guides	8
Alma Mater	9
History of Marshall and Proposed Expansion	10
Traditions	11
University Administration	14
Additional Personnel and Facilities	17
Clothes and Manners to Fit the Occasion	20
Cultural Program	22
Map of the University	24
Lets Get Academic	26
Nearby Churches	27
Entertainment	28
Extra Curricular Activities	29
Social Calendar	31
Student Government	35
Organizations	37
Student Publications	42
A Look at Sports	43
Glossary	46

JOHN MARSHALL

"The services of Marshall will always remain as an inspiration to young America as well as to the older generations. He stands as an example of courage, perseverance, and self-sacrifice. He ranks among the founders of the Nation; he early formed definite habits of thinking which crystallized his character. To these principles he remained adamant. As a lawyer, he knew the drudgery incident to the careful preparation of an argument in court. As a legislator he studied the fundamental principles upon which a democracy must be founded. As a member of Congress he rose to the defense of a President who was carrying out the duties of his office. As an envoy he outwitted the craftiest statesman of France. As Secretary of State he gave the first outlines of a strong foreign policy. As Chief Justice of the Supreme Court he rendered decisions which have influenced and molded the character of the American Nation. John Marshall, born of humble parentage in Virginia, rose to a position of power and prominence equal to that of the presidency . . . His memory will be an inspiration in the years to come to the thousands of students of this University who will take with them into the world the influence of this great American which is still a vital living force in our Nation."

(Above quote from J. F. T. O'Connor from
One Hundred Years of Marshall College.)

DR. STEWART H. SMITH
President of Marshall University



PRESIDENT'S MESSAGE

To Students New to Marshall University:

Welcome to Marshall!

We believe you have come here to improve yourself in every positive way. The faculty and staff accept the responsibility to teach and guide you. You have the responsibility to do your best in all your studies and activities.

This Handbook has been prepared to help you become acquainted with the customs, traditions, standards, regulations and organization of our University. Read all of it.

It is always an inspiration to see a new class enter Marshall. What rich opportunities you will have here to develop your talents and to discover the way to a finer life. Make the most of your University years for they come but once.

Sincerely yours,
STEWART H. SMITH
President

MESSAGE FROM PRESIDENT STUDENT BODY

Dear Freshman:

I would like to take this opportunity on behalf of the entire Student Body to welcome you to Marshall University.

For some of you the transition you now face will come easily, for others it will be more difficult. As you have been told many times, the burden is now on your shoulders. Begin on the right foot by learning to budget your time.

If any questions arise during the year feel free to come to the Student Government office, located in the west end of the Student Union. We as members of your Student Government will be glad to assist you in any way possible.

I sincerely hope I get the opportunity to meet each of you during the year and may I wish you the best of luck in your stay at Marshall.

Sincerely,
KEN GAINER
Student Body President

YOU ARE HERE!

"Hi!" and "Welcome to Marshall University." We are very happy that you have decided to make our campus your home during your college career, and we are eager to make you feel like you belong to this fine institution.

Your decision to attend college is one of the most important steps in your life. Here you will be faced with many challenges and opportunities. University life will test your resourcefulness continually and you will soon realize that your success as a university student depends on what you make of it. You will have an opportunity to make many new friends, have new experiences, and prepare yourself for a career in the business or professional world. Always remember that a university education is not obtained entirely in the classroom but by availing yourself of Marshall's fine culture program and her many outside activities.

FOR FRESHMEN ONLY

No doubt, by this time, you have been scared out of your wits as you've listened to upperclassmen recite stories about the terrors of Freshmen Week. Freshmen Week has not been designed to terrorize or humiliate you. Its purpose is to make you feel at home on Marshall's campus.

Assigned to a specific group headed by Freshmen Guides, with other freshmen you will have the opportunity to become acquainted with the other students in your group. Your Guides are there to answer any question you may have about Marshall University; please don't feel hesitant about asking anything you would like to know. Before you begin, though, we suggest you read this Handbook and the Marshall University Catalogue from cover to cover, and then fire those questions at the Guides. Remember they asked the same questions when they were Freshmen!

FRESHMAN ACTIVITIES THE RULES AND THE RULERS

Many colleges still have the age-old tradition of Freshmen beanies and Marshall is one of them. So be sure you're always seen with your little green chapeaux or you may find yourself face to face with an enforcer. These Freshmen Rules Enforcers are upperclassmen who have been chosen by the Freshmen Activities Commission. They can always

be identified by their name tags to which are attached green and white ribbons.

If you are caught violating one of the Freshmen Rules — perish the thought — one of the Enforcers will give you a ticket. The Freshman Court will then decide your penalty. A word to the wise: In the history of Marshall, not once has an Enforcer ever lost a case!

The following rules governing Freshman Activities have been drafted by the Freshman Activities Commission for 1963-64:

1. Freshman Rules will go into effect Monday, September 16, 1963. They will end on Saturday, September 21, 1963, if the Freshman men win the tug-of-war. If the rope breaks the freshmen lose. If the Freshmen men lose the tug-of-war, the rules will continue to be in effect for one week until September 28.
2. Freshmen caps, handbooks, and name plates are to be worn at all times during the day from 8:00 A. M. to 5:00 P. M. and to all Freshman activities. However, Freshmen men must not wear their caps in the classrooms, ROTC formations, or other buildings on campus.
3. Freshmen are required to speak to all persons they see on campus.
4. Freshmen are required to walk on the walk-ways and shall not cut campus at anytime.
5. Freshmen are urged to attend all home football games and all Pep Rallies.
6. Freshmen will be required to sing or recite upon request at anytime the following:
 - a. Alma Mater
 - b. The year which Marshall was founded
 - c. The name of the President and Vice-President of the Student Body.
 - d. The school song "We Are the Sons of Marshall"
 - e. The name of the President of the University
 - f. The name of the Dean of Men, Dean of Women, the name of your own academic Dean, and your own Academic Advisor.
7. Freshmen cannot wear any article of clothing that pertains to any school other than Marshall University.

8. Freshmen cannot sit in the booths by the windows in the Student Union, and at the request of any upperclassmen, must relinquish their seats.
9. During the Freshman Activities period, Veterans must follow all the rules as the Freshmen with the exception of purchasing beanies.
10. Freshmen are required to carry a schedule of their classes with them while on campus for as long as the Freshman Rules are in effect.
11. All Freshmen are encouraged to join the Greenbackers.
12. Freshmen cannot be served at the Student Union counter if upperclassmen are waiting to be served.
13. Freshmen must sit in card section at all football games.

FRESHMAN GUIDES SEPTEMBER 1963

Eddie Ann Alexander	Paul Wetherall
Ivan Ash	Ted Wiley
Betty Banda	James Wilmer
Carl W. Bragg	Marda Wilson
Shirley Campbell	Bob Altomare
David R. Carper	Ronald Brandon
Gloria Jean Chafin	LaDonna Byer
Judith Ann Clayton	Marion E. Casto
Mary U. Connell	Bill Hedrick
Machael H. Ferrell	Brenda Hubbard
Carol Lynn Fields	Roy E. Huffman
Leo G. Grobb	Donna Hughes
Nina Hatfield	Mary Margaret Loemker
Carroll Hoffman	Rebecca A. McDaniel
Bertie Anne Humphreys	Robert McDonald
Sally Lynn Jewell	Anne Mecum
Thomas R. Jividen	Steve Nelson
Patricia Kidd	June Patton
Donna Gail Lytle	Kay Marie Sage
Sue Ellen McElhinny	Donna Sturgeon
Kaye Mullen	Kathryn Jo Bolen
Lily Wray Naylor	Jean Cattano
Marna Paulovicks	Carolyn Fleming
Thomas D. Robinson	Catherine Imbroguo
Barbara Dale Smith	Jane McCaskey
Jerry W. Smith	Janice Richards
Gwendolyn G. Varnam	Patricia Ann Taylor
	John A. Wright, III

ALMA MATER

Marshall gracious Alma Mater
 We thy name revere;
 May each noble son and daughter
 Cherish thine honor dear.
 May thy lamp be ever bright,
 Guiding us to truth and light;
 As a beacon o'er dark water
 This is for thee our prayer.

Second verse:

May the years be kind to Marshall
 May she grow in fame;
 May her children fail her never,
 True to her beacon flame.
 May her spirit brave and strong
 Honor right and conquer wrong;
 This the burden of our song,
 Ever her truth proclaim.

"WE ARE THE SONS OF MARSHALL

We are the sons of Marshall
 Sons of the great John Marshall
 Year after year we go to Marshall U
 Cheering for the team and gaining knowledge too
 Proudly we wear our colors, Love and Loyalty we share,
 Sure from far and near you'll always hear the
 wearin' of the green
 For it's the Green and White of Marshall U.

FRESHMAN GOAL

While you are Freshmen, you should set a goal for yourselves to uphold for the rest of your college career and beyond.

Try to maintain the traditions, high standards, the spirit and ideals of Marshall University. Strive also to better yourselves academically, socially, and spiritually so that you may carry these high ideals beyond your college days.

THE HISTORY OF MARSHALL AND PROPOSED EXPANSION

In 1837, the original one and one half acre site of Marshall was purchased from John Holderby for \$40.00. Mr. Holderby made the provision that the estate always be used for school purposes, and 1962-63 marked the 125th year of Marshall as an educational institution.

The founder of Marshall University is considered to be John Laidley: it was then called Marshall Academy, after Laidley's close friend, Chief Justice John Marshall. By an act of the Virginia Assembly in March, 1858, the Academy became Marshall College and was given the authority to confer degrees.

The school was sold because of debts during the Civil War but a private school was housed at this time because of the terms of the original deed. When the new state of West Virginia was created, Marshall was soon revived under State control.

Today, with over 35 acres in the heart of Huntington, Marshall is a multimillion dollar institution, possessing twenty-one permanent buildings and numerous temporary structures. Our newest building, the women's dorm, is now under construction. Marshall also provides housing for its married couples in the new University Heights apartments. There is an additional campus on Route 60 which is in the planning stage.

Besides the four colleges of the University; the College of Arts and Sciences, the Teachers' College, the College of Applied Sciences, and Graduate School, Marshall maintains an Evening School, a college extension program with the director of Adults Education in charge, and off-campus workshops.

We are accredited by the North Central Association of Colleges and Secondary Schools and the National Council for Accrediting of Teacher Education. The university is approved by the American Association of University women and is a member of the Association of American Colleges and the American Council on Education.

Marshall is ever growing and expanding, and in your four years here you will see changes that will be astonishing. The new women's

dorm will soon be completed and plans are under way for a classroom building, auditorium and gymnasium for the Laboratory School along with a new Student Union for us.

(The above history of Marshall University was taken from the Marshall College Greenbook)

TRADITIONS

BUST OF JOHN MARSHALL — In front of Old Main stands the Bust of John Marshall, for whom the university was named. Our University was founded and named on his principles and ideals of: Equality, Democracy, and Individual Freedom.

BEECH TREE — The Old Beech Tree is symbolic of the tree of life, and represents the growth of Marshall Academy into the Marshall University of today. If it could only talk, many stories could it tell from the Civil War until now of the thousands of students that succeeded at Marshall and went on to greater achievements. This is also located in front of Old Main. Fagus, senior women's honorary, hold initiation here in the spring.

ODK — The ODK Victory Bell, next to the Music Building, is traditionally rung after each victory in the field of sports or knowledge. This tradition has dwindled but it will be renewed this year to remind all of us that victory is not always won at Fairfield Stadium or the Memorial Field House, but the every day trials and tribulations of college make the individual stronger in mind, body, and soul.

The ODK Circle is located in front of the Union tennis courts. It's a brick circle enclosed by concrete benches and has an ODK emblem in the center. This project was presented to the campus by Omicron Delta Kappa, men's leadership honorary.

It's sometimes used by organizations such as Fagus, senior women's honorary, for public initiations. Many a student has spent leisure moments sitting in the circle; thinking, conversing, or just sunning in the springtime.

LEADERSHIP CAMP — This is the "meeting of the campus wheels" the weekend prior to Freshman Week. During this weekend, the student senate, president and vice-president of the student body, members of the administration, officers of organizations, and those students connected with Freshman Week and Homecoming, seclude themselves at a near-by camp to plot and plan the coming school year. It's something that most of you will never attend, but for those of you fortunate enough to make the grade, it's an unforgettable and invaluable experience.

FROSH AND UPPERCLASS TUG OF WAR — This "Tug of War" between the freshmen football team and a group of upperclassmen symbolizes the quest of the frosh to be accepted. If the freshmen win, off come your beanies and away with Freshman Rules. But alas, if you lose, the rules stay into effect until a later date. So, lots of luck and may the best team win! The battle takes place during half-time at the football game on Sept. 21.

GREEK WEEK — The Greek fraternities and sororities unite once a year to join in the annual Greek Week. This week includes fireside chats and exchange dinners between sororities and fraternities. A parade of chariots and floats and the Greek Week Queen are usually climaxed by games and contests at a picnic. The highlight of the week is the Greek Week Dance at which is crowned the Greek Queen and King.

HOMECOMING — One of the biggest weekends is Homecoming, with the Alums returning to campus to renew bonds, observe the changes, and to live it up with the undergrads.

Much planning goes on prior to this weekend to insure its success. A week before Homecoming an election is held to choose class queens and "Miss Marshall." All full time women students at Marshall are eligible to run for a class queen if they have an overall "C" average. They secure a petition in the student government office and must have it signed by a certain number of members in their respective class. The best girls are chosen at the polls with the senior queen reigning over the weekend's festivities as "Miss Marshall."

A pep rally is always held on the Friday evening of the Homecoming Week End on the intramural field which leads off the big week end. Then judging of the house decorations that the dorms have slaved over follows.

On Saturday the parade begins about noon, and what a colorful spectacle! The campus beauties representing the Freshmen, Sophomore, and Junior classes will ride on a float built by a fraternity with "Miss Marshall." The Band, Cheerleaders, Majorettes, and the ROTC will help make it a parade to remember.

Then join with the alums and it's off to the game. This is one game you dress up for, and with the bright fall clothing that will be observed, you will notice many of the gals sporting lovely mums. The Greenbackers and an enthusiastic crowd are sure to give us a victory. After the game comes a round of reunions, open houses, and parties. This leaves you just enough time to quickly change into party clothes, and it's off to the Memorial Field House, and you'll dance the night away to a "name" band.

Oh! You'll be tired when you finally sink into bed that night, but we bet you'll never forget the fun and excitement of this memorable week end.

LIFE PLANNING WEEK — This is one week set aside during second semester for you, the student, to evaluate yourself, your life, and your future. Speakers are brought in from all parts of the nation to speak to classes, the entire campus, and "fireside" groups. This period is set aside for re-examining our ideas about why we're here and where we're going. It serves as an inspiration to many students who find themselves confused as to life's problem. Religion plays a part in this week, of course, but what kind of life would a person have with no religion? Take advantage of this week and what it has to offer: you'll profit tremendously.

UGLY MAN CONTEST — Alpha Phi Omega, men's service honorary, sponsors a contest to find the "ugliest man on the campus." Of course, Marshall has no ugly men, so some must be made. The social organizations, either separately or two combined, select a subject and then produce a photograph by trick photography or makeup of the ugliest human (?) specimen possible. Some of the results put Lon Chaney to shame!

The pictures are then published in the Parthenon and circulated around campus. The climax of the event is a mix in the union at which the student body elects the ugliest picture by paying for a vote. It's a huge success each year, and we all look forward to it. You will too, especially after you've seen some of the pictures. The proceeds from this contest are donated by Alpha Phi Omega to the college intramural program.

PARENTS' WEEK END — Parents' Week End along with Homecoming is one of the big events of our college year. This is the time the University shows off, in all departments and the student body presents a complete series of entertaining and informative activities from the time parents' week end opens until it closes on Sunday afternoon. Start telling your parents about this now, so that when spring comes around, they will be sure to come. The highlight of this week end is the Mothers' Day Sing.

MOTHERS' DAY SING — This is the big day for the Greek organizations as well as a day of tribute to our mothers. These organizations work for months prior to the Sing preparing songs. On the day of the Sing, each group participates in the contest with the winning fraternity and sorority receiving a permanent trophy. The dormitories and Greek organization always hold open house for you and the public afterwards in order to complete the day's activities.

THE INDIVIDUALS WHO RUN OUR CAMPUS

THE UNIVERSITY ADMINISTRATION

Every student finds himself in need of seeing one of the university administrators at some time and should know where to find them. The first floor of Old Main houses our administrative personnel, and their office hours are from 8:00 A. M. to 4:15 P. M. Office hours for your individual instructors will vary, so check with them for the office location and office hours.

One of the first men you will come in contact with during Freshman Week is our PRESIDENT, Dr. Stewart H. Smith. Once he has met you, he does not often forget your name or face and always has a kind word for everyone. It is through the work of such men as our President that Marshall University has grown in size and prestige. His office, Room 108, is open to all, and he will be glad to aid you in problems which your advisor or dean cannot solve.

Dr. Harold Walker, VICE-PRESIDENT OF ACADEMIC AFFAIRS, is in Room 110. This is a new position and, as Dr. Walker says, "we are still defining the duties of the position."

The new VICE-PRESIDENT OF BUSINESS AND FINANCE, Mr. Joseph S. Soto, is the man in charge of money and buildings and grounds.

The REGISTRAR AND DIRECTOR OF ADMISSIONS, Mr. Luther E. Bledsoe, is your guardian from the time you apply for admission to Marshall until you finally graduate. The services he renders range from Freshman Week, Registration, and transcripts to college catalogues, to caps and gowns. This is the office which takes care of you Veterans. You will find Mr. Bledsoe in Room 105.

Mr. Fred Smith, the COMPTROLLER, handles all your money. He is located in Room 103.

Mr. Paul H. Collins, ADMINISTRATIVE ASSISTANT AND DIRECTOR OF ADULT EDUCATION, serves as Administrative Assistant to the President of the University. He is also Director of Adult Education, and in this capacity he initiates, organizes, and administers off-campus and certain campus activities. For example, he is in charge of the extension class program and the University's evening program. His office is located in Room 107.

You women will get to know well our DEAN OF WOMEN, Mrs. Lillian Helms Buskirk, before you leave Marshall. Her office is located in Room 109, and she will be glad to offer advice or give you help with any problems you may come up against during your university career.

Our DEAN OF MEN, Mr. Stanley A. Shaw, handles any difficulty the men run into. This office, Room 116, handles loans and scholarships, lost and found, traffic and parking violations, men's housing, fraternities, and counselling.

Dean J. Frank Bartlett of the COLLEGE OF ARTS AND SCIENCES is the man to see about your academic problems if your advisor cannot help you. He is the person to see about changing your major or obtaining a credit evaluation. DEAN Bartlett's office is found in Room 115.

Dean of the TEACHERS' COLLEGE, is Dr. D. Banks Wilburn who serves in the same capacity for those of you in the teaching field as Dean Bartlett does in the fields of arts and sciences. In his office, Room 113, you may get a credit evaluation in the teaching field.

Dr. A. E. McCaskey is DEAN of the newly established COLLEGE OF APPLIED SCIENCES, Dean McCaskey's new college embraces engineering, the Reserve Officers' Training Corps, the new nursing education department, and the medical technology program. His office is located in Room 116.

After receiving your University diploma, and you decide to do graduate work at Marshall, the man who will handle your affairs is Dr. A. E. Harris, DEAN of the GRADUATE SCHOOL. His office is located in Room 111.

David Dodrill, INFORMATION AND PUBLICATIONS DIRECTOR, releases news to local and hometown newspapers and to radio and TV stations, and prepares official University publications. His office is in Room 112.

PLACEMENT DIRECTOR, Mr. Robert Alexander, acts as a go-between for students seeking both full and part time jobs, and employs seeking personnel. His office is in Room 114.

The James E. Morrow Library, named for a former president of Marshall, is headed by Dr. Harold Apel, LIBRARIAN. It is the third largest library in the state and contains over 120,000 volumes.

Mr. John Sayre is DIRECTOR OF DEVELOPMENT AND ALUMNI AFFAIRS. His office is in the southeast corner of Old Main, Room 129.



general information

ADDITIONAL PERSONNEL AND FACILITIES

HEALTH SERVICE — All full-time students receive the health services free after having paid their health fee during registration. The clinic is located in the new Physical Education Building on 18th Street between Virginia and College Avenues. This office is open from 9 to 12 A. M. and from 1 to 4 P. M. on weekdays; and from 9 to 12 A. M. on Saturdays. Dr. T. Craig McKee, the university physician, and Mrs. Mary D. Summers, the university nurse, are present at all times during these hours to treat you. If you need medicine, a shot, or a physical examination, the clinic will be glad to serve you.

SHAWKEY STUDENT UNION — Mr. W. Don Morris manages the Shawkey Student Union which is named after one of Marshall's past presidents, Morris P. Shawkey. The Student Union is the center of social activity on campus. On the first floor are found a lunch counter, a lounge, and dance area. Bridge, checkers, and chess facilities are available during the hours of operation which starts at 7:30 A. M. and close at 9:00 P. M. Hours at Saturdays are from 7:30 A. M. to 2:00 P. M., and the Union is closed all day Sunday. In the basement are found pool and ping-pong tables (you must furnish your own ping-pong balls which may be bought at the lunch counter). On the second floor are found the office of the university annual staff — The Chief Justice, two conference rooms, and a music room where television and record facilities are available. The Student Government Office is found in the west wing of the Student Union, and we urge you to take an interest in and participate in the campus government.

On each Wednesday night a student mix is held from 7:30 P. M. until 9:45 P. M. when women must be in the dorms for the night. Most of the mixes are free, but when sponsored by a group or organization, there is a nominal fee of \$.25. Just one word of warning — you do not receive a grade in "unionology", so spend some time on your studies.

BOOKSTORE — The Bookstore is located in the basement of Old Main, under the management of Mr. Percy L. Galloway. Here you buy your textbooks, drafting equipment, art supplies, and desk supplies. It is open from 8 to 12 A. M. and from 1 to 4:15 P. M. during the school week; and 8 to 12 A. M. on Saturdays. Checks will be accepted for the purchase of supplies.

POST OFFICE — Located adjacent to the Bookstore and also run by Mr. Galloway, the hours are the same as for the bookstore, and they handle all mail coming in and going out of the university. They don't mail packages, but the store will if you have the correct postage on them. A subdivision of the downtown post office is located on Third Avenue above 20th Street; it's best to have packages handled there.

PLACEMENT OFFICE — On campus and off campus jobs may be found by inquiring in the Placement Office managed by Mr. Robert P. Alexander. His office is located in Room 114 of Old Main. Hours are from 8 to 4:15. Checking in this office will save you a lot of trouble walking the streets of Huntington looking for employment.

BUILDING AND GROUNDS — Here is found the crew who keep the campus clean and attractive. The office is located in the basement of Old Main and is open from 6 until 4:30. If you need something repaired, want to borrow a tool, or need paint for your room, this is the place to have it taken care of.

DUPLICATING DEPARTMENT — Managed by Mrs. Jeanne Bias, the Duplicating Department is located across from the Bookstore in the basement of Old Main and is open from 8 to 4:15. If you need some printing done for your dormitory, organization or committee, this is the department that will handle it for you.

CAFETERIAS — Located between Laidley and Hodges Halls at the east end of the campus, they serve breakfast from 7 to 9 A. M.; lunch from 11 to 1:30 P. M.; and dinner from 5 until 6:30 P. M. Saturday lunch is served from 11 to 12. On Sunday, breakfast is served from 8:30 until 9:30 A. M.; lunch from 12 to 1 P. M.; no dinner is served on Sunday. The same schedule is observed in the new men's dorm cafeteria.

INFORMATION SERVICE — Located in Room 112 of Old Main, this office is under the direction of Mr. David Dodrill, Information Director, and it handles the publicity, publications, and public relations of Marshall University. Check here if you need anything along this line.

DEVELOPMENT AND ALUMNI AFFAIRS — Located in Room 129 of Old Main, John Sayre directs the affairs of this office which acts as a link between the university, its alumni, and all other interested groups. When you have completed your work here, this will be the office to keep informed of the progress of Marshall, but until that time, this office will be working with you on such activities as Homecoming and Parents' Week End.

SPEECH CLINIC — The Speech Clinic is located in the Science Hall, Room 18. This facility provides special help in correcting speech defects.

PSYCHOLOGY CLINIC — The Psychology Clinic, Room M307, is open to full-time students for consultation on scholastic, vocational, social, and personal problems. Students are invited to make use of the clinic.

RELIGIOUS COUNSELING — This is handled by The Reverend Lander Beal, Dr. Elmer E. Dierks, Father Gardner and Rev. Hardin "Corky" King in the Student Chapel. These men can be of great help to you regardless of whether or not your problems are of a religious nature.

PARKING — This will be a daily problem to you car owners. Daytime parking in the university parking lot behind the Science Hall is reserved for the faculty and those cars with special permits issued by the Supt. of Building and Grounds. The lot is open to everyone after school hours. Dorm residents park behind the dorms they live in. Students may park wherever it is legal on the streets, and first come, first served. You may have to park five or six blocks from the campus. If you park on Fifth Avenue, make sure you move your car before three o'clock, or you will find a \$5 parking ticket on your windshield. There is no parking on Fifth Avenue between the hours of 3 P. M. and 6 P. M. Limited parking is available in the Engineering Building Lot, corner 5th Avenue and 19th Street.

If you violate the above rules concerning parking on the campus, you MUST report to the Dean of Men's Office within 24 hours after the issuance of a ticket. All tickets given by city police concerning parking on the city streets must be handled at the city police station and need not be reported to the Dean of Men's Office. Explanation

of campus parking violations: first ticket is a warning; second offense means an appearance before the traffic committee; third offense means an appearance before the Administrative Cabinet and a possible suspension from school or dismissal.

JAMES E. MORROW LIBRARY — You will become familiar with this building during your next four years at Marshall. There is unlimited reference material available in the library which will be of valuable help to you in your classwork, and a great supplement to your learning in the classroom. Try to spend more time in the library both to accomplish studying and to broaden your scope of knowledge.

Library hours during the school week are from 8 A. M. to 9:30 P. M.; and 8 A. M. to 5 P. M. on Saturdays. If you are unable to find the material you desire, ask the person on duty at the desk, and they will be able to offer you assistance.

The journalism department is located in the basement of the library, and it is here that the school newspaper, the **PARTHENON**, is published.

CLOTHES AND MANNERS TO FIT THE OCCASION FOR WOMEN ONLY

Probably, you have been wondering all summer what to wear when you finally "hit the campus". You want to make a good impression but you most likely don't want to be classified as "different" or "way-out". Relax, most of the clothes that you wore in high school are popular and practically traditional in class.

Neatness is the catchword whether when wearing bermudas in the dorm or that standard library equipment—peggars. Blouses are always convenient and bermudas and peggars are right in style on the campus after class. Shorts are acceptable on the tennis courts only, and please remember that skirts or dresses are the only proper attire for town.

As for dating, matched skirts and sweaters are always good with heels and earrings for downtown movies and the Community Forums. We girls wear casual skirts and sweaters to week-day and dateless basketball games, but add heels for the week-end games. As for football games, what you should wear—casual or dressy clothes—often depends upon your date. Skirts and sweaters or blouses plus flats or loafers are fine for the Wednesday night mixes.

"Special dates" and the Artist Series require we wear a party or good wool dress, depending upon the occasion. At teas and receptions and also church, hats and gloves are usually necessary extras. You may find that a good basic suit is often invaluable in solving the problem of "what to wear".

Floor-length formals are not usually the rule at formal dances unless specifically decided upon for the particular occasion, but are nice if available. Usually, a cocktail dress is fine for all the formal dances. Informals call for school clothes or costumes that are in good taste. Most of the girls wore cocktail dresses or dressy wool dresses to the Homecoming Dance.

Because Huntington has an unusually "drippy" climate, you will find boots, raincoat, and umbrella indispensable on Marshall's campus. And for our cold winters, you'll need a heavy winter coat, a carcoat, gloves, and scarves. Kneesocks are also handy, and by the way, considered sharp by our guys in cold weather.

The "natural look" is very in, so make it your guiding hand when applying make-up. As for hair styles, casualness plus versatility is what pleases University men.

Outfits which mix and match will stretch your wardrobe considerably, and you may find that you don't need as much as you had expected. However, should you need something, Huntington has quite a few dress shops which carry up to the minute styles at reasonable prices. So why don't you plan to have some of your clothes allowance to spend here?

As for etiquette, just remember, "always be a lady". You know to be polite and show respect for your elders and persons of authority; you know to thank your date for a wonderful time and to be attentive to him while on a date; and you know to be considerate of your roommate and others around you. So relax and have a good time, but always remember that whatever you do in public is seen by someone else. And for you girls who plan to rush here is a little tip; sororities are very interested in your neat appearance and polite personality.

CLOTHES AND MANNERS TO FIT THE OCCASION FOR MEN ONLY

Casual and comfortable are the keywords for attire of Marshall men. A neat sports shirt and khakis or cords will do for class, also sweaters and dress pants. Wash and wear fabrics are economical and a good substitute for the jeans you wore in high school. Suits and ties are worn by some to class, but it's entirely up to you. But remember, guys, to get a date you'll be in competition, and your appearance at all times is important.

Loafers are good for the feet, but don't forget neat dress shoes for "special dates." You'll have plenty of opportunity to wear those tennis shoes, too. Wear a suit and tie on dates, for movies, and ball games. Dress accordingly to what your date is wearing is a good rule to follow.

Formal clothes are nice to have, but are not a necessity. A tux is usually worn to a winter formal (a dark suit will do), and a white dinner jacket is traditional at a spring formal.

Trench coats and water repellent gabardines are popular as well as necessary during the rainy season. Most of our men also carry absolutely huge black umbrellas (which serve as an introduction to that beautiful coed standing in the rain). A heavy top-coat and jacket are necessary for winter. Hats are up to you; they are fine for dress wear, cold football games, or in a windy convertible

Your old high school sweat shirt and pants are fine for sports when it's cold; tennis shoes, swimming trunks, and T-shirts are fine for doing what comes athletically. You'll be able to wear those bermudas and beachcombers too.

Impressing girls by doing crazy things like you did in high school just won't work here; you're in college now, so act accordingly. Our gals like gentlemen; they appreciate it when you open a door for them, or take their arm when crossing the street. Help them put on their wraps, and compliment them on that dress which was worn especially for you. Just be yourself with a little added polish, and you'll get along swell, be it a professor, a date, a fraternity you're rushing, or another guy.



Cultural Program

GET ACQUAINTED WITH CULTURE

While you were in high school, you may have had culture forced on you. Now that you are a university student you have the choice of accepting or rejecting the various culture programs offered. We hope you will take advantage of the entertainment made possible by your student activity card.

At least once a month convocations are held in Old Main Auditorium on Thursdays at 11:00 A. M. There, programs range in variety from art lectures to jazz sessions.

Community Forums are held in the evenings in Old Main Auditorium and the programs include such subjects as literature, science, travel, current events, and other topics.

The Artists Series are held downtown at the Keith-Albee Theatre at various times during the record year. These are professional performances of national and international fame. For instance, last year we had the Pittsburgh Symphony Orchestra, The San Francisco Ballet, the play, "Sound of Music", and those well-known pianists Ferrante & Teicher (and these are only a sample!)

While attending the convocations, Forums, and Artists Series, save time for the University Theatre too. Don't underestimate your own talents, maybe you will be the next leading lady or man. Normally, there are four full-length plays and several studies and experimental dramas produced each year. Tryouts are open to the entire student body regardless of experience, so give yourself a chance—you might discover just how talented you really are!

If art is your serious interest, you will be glad to learn that West Virginia's only art museum is located right here in Huntington on Eighth Street Road. Various exhibits such as the Centennial Art Display and Exhibition 180 are offered during the year as well as the standard exhibits. Why not take an art class if you're really interested in it—you'd be surprised at what you could learn.

Music lovers will find all types of record albums offered on the second floor lounge of the Student Union. If you wish to check any out, just see Mr. Don Morris, Student Union Manager. There is also a television set in the second floor lounge for your added enjoyment.

In the music building are rooms of pianos and musical instruments. There you will also find a chance to meet people who share your common interest in music. Then, too, the marching and concert bands, the symphony orchestra, the symphonic or men's concert choirs are ever on the lookout for new members. Perhaps you?

Don't forget the library, stacks upon stacks of books from which you can glean knowledge will be found there. Aid your cultural development; you'll find it can be lots of fun.

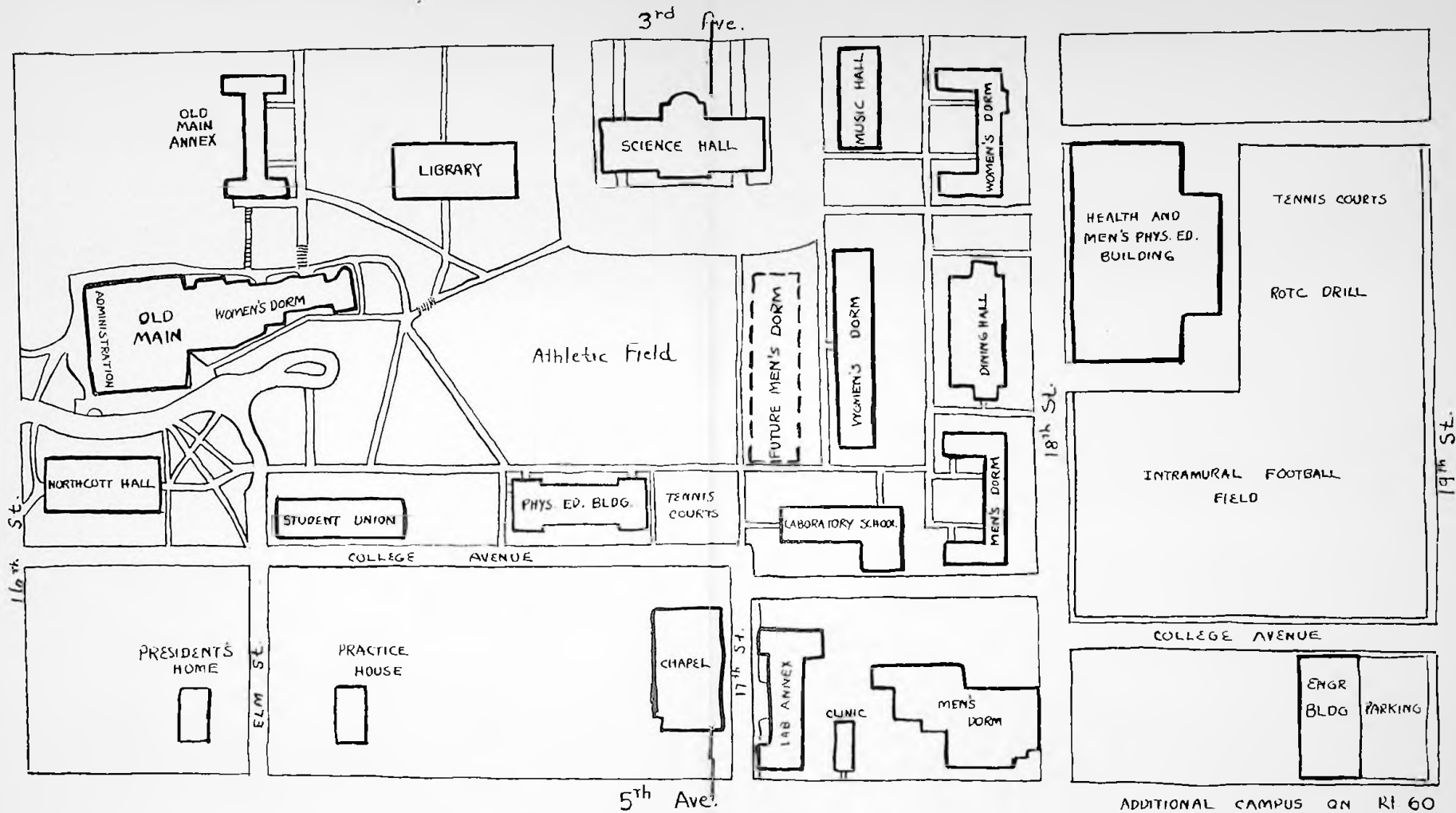

ADDITIONAL CAMPUS ON RT 60

MARSHALL UNIVERSITY

HUNTINGTON, WEST VIRGINIA

LET'S GET ACADEMIC

If you are to achieve your purpose at Marshall University, you must learn how to study now. Studying is a term representing various activities, and thus there are various methods of study. There is no recipe or surefire solution to passing your next four years at Marshall. What works best for you may flunk your roommate. No two individuals can study exactly alike. The best policy is to formulate your own pattern. However, we'll try to let you in on a few of our time-tested procedures.

Buy your books early. Then read the preface and introduction before going to class the first time. DON'T be afraid to ask questions this or ANY other day. DON'T be afraid of the professor. He is sincerely interested in your abilities, so get acquainted and show an interest in the course.

Note-taking is a necessity at college and quite different from high school. Our professors move fast; they have to in order to cover all the material in one short semester. Take notes in ink on standard size paper; then you can read them at exam time. Keep them organized, dated, and in a notebook so you won't lose half a semester's work if you drop a book sometime.

You can usually detect possible test questions by the emphasis put on certain points in lecture. MARK IT IN RED OR STAR IT. Speaking of exams, find out what type your professor will give: essay or objective. Knowing what to study makes your studying easier. You may also have "pop quizzes" so be prepared each day. Many students recommend a short review period and a good night's sleep before a test. If this plan works for you—congratulations! If not, join the rest of us and burn the midnight oil. However, you cannot be expected to cram millions of facts into your head if you have not heard them before or read the chapters. Exams are one of the few ways that professors have to measure your progress.

For each hour in class, two out-of-class hours of preparation are recommended. Some classes may not require this while in others, you will have to devote far more time. Always have assignments ready to turn in and have chapters read before class.

Marshall is small enough to afford a close student-professor relationship, so take advantage of it. You won't get ribbed as you probably were in high school for getting to know your professor. We like our "profs"; we get to know them. If you're timid when it comes to asking questions in class or if you need special help, make an appointment to see your professor.

Unfortunately, final exams are a necessary evil. We hate 'em, but we take 'em. A final can be a complete review or merely cover the segment since the last test. After you're through that first final week, you're one of the gang. Finals will be tough. They can raise or lower a grade, so study, but don't PANIC when this week rolls around. It is best to begin studying early and to get plenty of sleep.

Your big academic aim is the Dean's list. This is for the students each semester making a 3.0 average or better. Work for it.

We don't advise cutting class. However, if you find it necessary to miss class, be sure you know the policy of your professor before doing so, or you may get a grade cut. When you're sick, call your dean's office, and they will contact your professor. However, this does not automatically excuse you from class. Upon returning to class, be sure to explain why you were absent, and then you will be responsible for making up the work you missed. You may find it necessary to crawl to class for some professors, so do it without question. If you miss a class because of a school activity such as intercollegiate sports, debates, choir trips, etc., the department head will notify your instructors.

Along the line of class etiquette, call a professor by his correct title. The faculty directory tells you whether it is Mister, Doctor, Professor, Mrs. or Miss. They have worked long earning their titles, so call them by the correct one. You had better get used to the idea of being called Mister or Miss yourself; this isn't high school. An instructor also appreciates a student who is on time.

A final word, remember your first and primary aim in coming to Marshall is TO OBTAIN AN EDUCATION — aside from you "husband-hunting" females. But remember, girls, Marshall men like their women to have brains as well as beauty.

At college, learning is no longer "candy-coated." The responsibility now lies upon YOU.

NEARBY CHURCHES

Just because you are away from home, you must not neglect your spiritual life. No matter what your church preference might be, Huntington can accommodate you. In fact, it has been called "the city of churches," and you will soon realize why. There are nearly fifty churches and one will suit you.

Following is a list of churches that most of our students attend.

The entire list of churches can be found in the yellow section of the telephone directory. You can always find someone on campus who will go with you, so don't worry about being by yourself. Many churches are within walking distance, and most of the outlying churches will be glad to furnish transportation if you are interested in attending their services.

Central Christian—1202 Fifth Avenue
Emmanuel Methodist—18th Street and Sixth Avenue
Enslow Park Presbyterian—Enslow and Washington Boulevards
Fifth Avenue Baptist—1135 Fifth Avenue
Fifth Avenue Church of God—2128 Fifth Avenue
First Church of Christ's Scientists—1101 Twelfth Avenue
First Congregational—707 Fifth Avenue
First Methodist—1124 Fifth Avenue
First Presbyterian—1015 Fifth Avenue
First Evangelical United Brethren—21st Street at Fifth Avenue
Hellenic Orthodox, Saint George—7th Street at Eleventh Avenue
Johnson Memorial Methodist—10th Street and Fifth Avenue
Ohev Sholom Temple—949 Tenth Avenue
Pilgrim Holiness—20th Street and Ninth Avenue
St. Paul's Evangelical Lutheran Church—721 Twelfth Avenue
St. Joseph's Roman Catholic—519 Thirteenth Street
Sixth Avenue Church of Christ—530 Twentieth Street
Trinity Episcopal—520 Eleventh Street
Twentieth Street Baptist—20th Street and Fifth Avenue

ENTERTAINMENT

Believe it or not, you'll find you have some leisure time. To fill it, try the wide range of entertainment which is concentrated within the tri-state area. Entertainment will naturally differ with the individual, but here are some suggestions on how to use your leisure time in our city.

Fourth Avenue is the main street of the city. On this street about seven blocks from the campus is located the theatre area. Three theatres are located in this section; they offer special student rates if you take your ID card. There are several drive-in theatres in Huntington or the surrounding area.

The city maintains Ritter Park and several other smaller parks, with their recreational facilities. In Huntington is also found Dreamland and the Olympic Pool, superior recreational sites. If the tennis courts on campus are filled, try the ones in Ritter Park. Camden Park also offers many fun-filled amusements.

Huntington offers horseback riding, golf, swimming, hiking, bowling, car rentals, airplane rides, and boating facilities. Miniature golf is one of our most popular recreations.

The YMCA and YWCA are sources of varied activities. Classes in swimming, first aid, handicraft, and lounging facilities are available to students. Neophyte artists can find direction for their talents in classes at the Huntington Galleries, the only one of its kind in the state.

Nationally known entertainers often visit Huntington. All you need to do is read the ads in the newspapers to find out when they are to appear.

Students are always welcomed as helpers with such activities as the Girl Scouts, Boy Scouts, Campfire Girls, and related youth groups.

If show business is your calling, you'll find collegians have an opportunity to try their talents in front of the footlights of the Community Players, located at the Abbot Theatre, which is on West Fourteenth Street.

Just so you won't get lost, remember that the avenues run east and west and are numbered beginning at the river. The streets run north and south and are numbered in both directions from First Street, which is located fifteen blocks west of the campus. Buses make regular runs, and taxis are always available.

EXTRA CURRICULAR ACTIVITIES

UNIVERSITY THEATRE — For thirty-seven years the University Theatre has given training in dramatic skills and techniques, and has helped students to develop such qualities as poise, initiative, self-reliance, confidence, and cooperativeness. The Marshall University Theatre helps to encourage appreciation of dramatic literature, and to help keep alive the plays which have made dramatic history.

The Theatre presents four plays each year and weekly plays which are presented on the Marshall Radio Station WMUL. All students are eligible for parts or work as directors, stage hands, etc. If you are a student interested in dramatics, you should participate in University Theatre. The play productions class is in charge of the stage setting and props.

The University Theatre is supervised by Clayton Page. The top honor that a drama student can obtain is Alpha Psi Omega.

RADIO — The Marshall University Radio Station (WMUL), which was reopened last year, has been a success. The station broadcasts on 88.1 megacycles on the FM band from 7-10 A. M. and 3-10 P. M., Monday thru Friday. The programs vary from popular, jazz, and classical music to news, sports, weather, and other campus activities.

All Marshall students are invited to participate in the University Radio Station. This gives the student an opportunity for a broader background and knowledge in radio and TV.

The Director of the university radio and television facilities is Dr. Stephen Buell, Assistant Professor of Speech.

CHORAL UNION — The Choral Union is composed of members of all the choirs in the music department, united in order to present productions such as the "Messiah" and the "Requiem."

A CAPELLA CHOIR — This is the training ground for freshmen interested in participating in choral work. From this group freshmen advance to the Men's Concert or Symphonic Choir.

SYMPHONIC CHOIR — This choir is made up of sophomore, junior, and senior women.

MEN'S CONCERT CHOIR — This choir consists of an all-male touring group for upperclassmen.

MARSHALL UNIVERSITY BAND — We are proud of our Marshall University Band. This group is open to any student who is interested in being a part of a marching or a concert band. The band under the direction of Thomas O'Connell performs at all home football games. The marching band with a few minor changes, becomes a concert band for many college programs. Both men and women students are eligible to participate in the band.

MARSHALL UNIVERSITY DEBATE TEAM — Marshall is becoming quite well-known and praised for their debate team. Debating at Marshall is an intercollegiate activity. It offers you a chance to gain recognition for you and your school, and it is an invaluable opportunity for all students, especially those in Law, Political Science, or Economics, to develop and further their ability to think and speak effectively under pressure.

The team enters about eight tournaments each year and culminates the season by participation in the State Intercollegiate Speech Tournament and the National or Regional Pi Kappa Delta meet. Outstanding debaters may gain membership in Pi Kappa Delta, national debate fraternity.

SOCIAL CALENDAR

1963 - 1964

SEPTEMBER

9-14	Orientation & Registration	
14	House Party	Lambda Chi Alpha
16	Classes Begin	
18	Mix to meet team & coaches	Cheerleaders
21	Football — Morehead	
28	Informal	Alpha Sigma Phi
28	Informal	Pi Kappa Alpha
28	Informal	Lambda Chi Alpha
28	Informal	Sigma Phi Epsilon
28	Informal	Sigma Alpha Epsilon
29	Picnic	University Hall
29	Tea	Scabbard & Blade

OCTOBER

3	Informal	Tau Kappa Epsilon
4	Informal	Cavaliers
4	Retreat	Sigma Sigma Sigma
5	Football — Toledo	
6	Open House	Lambda Chi Alpha
6	Open House	Alpha Xi Delta
12	Informal	Delta Zeta
12	Informal	Zeta Beta Tau
12	Informal	Sigma Sigma Sigma
18	Informal	Alpha Chi Omega
18	Informal	Laidley Hall
19	Football —	
19	Informal	Kappa Alpha Order
19	Informal	Alpha Sigma Alpha
19	House Party	Lambda Chi Alpha
25	Informal	Alpha Xi Delta
25-26	Retreat	Tau Kappa Epsilon
26	Informal	Sigma Alpha Epsilon
26	Informal	Sigma Phi Epsilon
26	Informal	Sigma Kappa
30	Blood Drive	Student Government

NOVEMBER

2	Informal	Alpha Sigma Phi
2	Informal	Pi Kappa Alpha
3	Open House	University Hall
3	Faculty Tea	Alpha Chi Omega
9	Football — HOMECOMING — Bowling Green	
16	Informal	Kappa Alpha Order
16	Informal	Cavaliers
16	Informal	Tau Kappa Epsilon
16	Semi-Formal	Prichard Hall
16	Informal	Sigma Sigma Sigma
16	Informal	Lambda Chi Alpha
17	Open House	Laidley Hall
23	Football — Ohio University	
23	After Game Party	Lambda Chi Alpha
23	Informal	Zeta Beta Tau
27	Thanksgiving Recess Begins	

DECEMBER

2	Classwork Resumed	
6	Formal	Alpha Chi Omega
7	Formal	Alpha Sigma Phi
7	Formal	Lambda Chi Alpha
7	Formal	Sigma Phi Epsilon
7	Formal	Sigma Sigma Sigma
8	Open House	Delta Zeta
13	Christmas Party—Orth. Hospital	I. S. A.
14	Formal	Sigma Alpha Epsilon
14	Formal	Pi Kappa Alpha
14	Formal	Cavaliers
14	Formal	Tau Kappa Epsilon
14	Formal	Alpha Sigma Alpha
14	Formal	Delta Zeta
19	Christmas Recess Begins	

JANUARY

3	Classwork Resumed	
11	Formal	Kappa Alpha Order
11	House Party	Lambda Chi Alpha
11	Formal	Zeta Beta Tau
11	Formal	Sigma Kappa
16	Last Class Session	
17-18	Advance Registration for Second Semester	
20-25	Semester Examination Period	
25	Semester Ends	
27-28-29	Orientation and Registration	
30	Classwork Begins	

FEBRUARY

8	Informal	Sigma Alpha Epsilon
8	Informal	Alpha Sigma Phi
8	Informal	Pi Kappa Alpha
8	Informal	Kappa Alpha Order
8	Informal	Lambda Chi Alpha
8	Informal	Sigma Phi Epsilon
8	Informal	Zeta Beta Tau
14	Semi-Formal	Laidley Hall
14	Informal	Alpha Xi Delta
14	Informal	Sigma Sigma Sigma
15	Informal	Delta Zeta
15	Informal	Tau Kappa Epsilon
15	Formal	I. S. A.
21-23	Retreat	Tau Kappa Epsilon
22	House Party	Lambda Chi Alpha
22	Informal	Alpha Chi Omega

MARCH

8	Ess'n Fress	Zeta Beta Tau
14	Informal	Cavaliers
14	Party	Lambda Chi Alpha
14	Informal	Sigma Phi Epsilon
14	Informal	Sigma Kappa
14	Military Ball	Scabbard & Blade
20	Blood Drive	Student Government
21	Informal	Alpha Sigma Phi
21	Informal	Alpha Sigma Alpha
21	Informal	Pi Kappa Alpha

- | | | |
|----|----------------------|------------|
| 22 | Spaghetti Dinner | Delta Zeta |
| 26 | Easter Recess Begins | |
| 31 | Classwork Resumed | |

APRIL

- | | | |
|-------|---------------------------|---------------------|
| 3 | Informal | Cavaliers |
| 4 | Informal | Tau Kappa Epsilon |
| 4 | Semi-Formal | Prichard Hall |
| 11 | Informal | Sigma Alpha Epsilon |
| 11 | Informal | Lambda Chi Alpha |
| 11 | Chicken Dinner | Sigma Sigma Sigma |
| 12 | Pikes Peak | Pi Kappa Alpha |
| 18 | Informal | Zeta Beta Tau |
| 17-18 | Delta Zeta Weekend | Delta Zeta |
| 17-19 | Sigma Kappa Weekend | Sigma Kappa |
| 24-26 | Alpha Chi Omega Weekend | Alpha Chi Omega |
| 24-25 | Sigma Sigma Sigma Weekend | Sigma Sigma Sigma |
| 25-27 | Alpha Xi Delta Weekend | Alpha Xi Delta |

MAY

- | | | |
|-------|--------------------------------|---------------------|
| 1 | Formal | Sigma Alpha Epsilon |
| 1 | Informal | Kappa Alpha Order |
| 2 | Formal | Kappa Alpha Order |
| 2 | Formal | Cavaliers |
| 2 | Lambda Chi Alpha Weekend | Lambda Chi Alpha |
| 2 | Formal | Sigma Phi Epsilon |
| 2 | Formal | Zeta Beta Tau |
| 9 | Formal | Alpha Sigma Phi |
| 10 | Mother's Day | |
| 15 | Banquet for graduating seniors | I. S. A. |
| 16 | Formal | Tau Kappa Epsilon |
| 16 | Formal | Pi Kappa Alpha |
| 16 | Approx. date—Spring Carnival | Student Government |
| 18 | Formal | Alpha Sigma Alpha |
| 21 | Last Day of Classes | |
| 22-23 | Advance Registration for Fall | |
| 25-30 | Semester Examination Period | |
| 31 | Commencement | |



Student Government

STUDENT GOVERNMENT

The purpose of Student Government is to provide an instrument which will make it possible for all students to have a voice in any program which would make Marshall a better University. It is constructed to represent democratically all members of the Student Body. It is designed to reflect student opinion, and to crystallize and make effective any constructive program. It encourages initiative and civic development; it trains for intelligent citizenship.

Our Student Government, like the federal government, is composed of three branches: The EXECUTIVE, The LEGISLATIVE, and The JUDICIAL.

The EXECUTIVE portion of the government is directed by the President of the Student Body. Under the President serving in executive capacity are the STUDENT EXECUTIVE CABINET Secretaries and the COMMISSIONS. The Student Cabinet acts as an advisory group to the President and its members include the Secretaries of Academic Affairs, Athletic Affairs, Publications and Public Relations, Social Affairs, and Student Government Affairs, and The Executive Secretary, the Business Manager, and the Vice-President of the Student Body. The Commission heads, better known as Co-ordinators, serve over the various Student Government Commissions. These Coordinators, five cabinet secretaries, the Business Manager, and the Executive Secretary are all appointed by the Student Body President and are subject to approval of the Student Senate.

The LEGISLATIVE branch of Student Government is the STUDENT SENATE. This is the elected branch. This fall you will go to the polls and elect Four Regular Senators, one Alternate Senator, and a Freshman Class President to voice your opinion in the Student Senate. In the springtime General Elections are held each year to elect upperclass representatives to the Senate, our lawmaking body. The Student Senate meets each Wednesday night at 6:30 P. M. in the Student Government Office, and anyone may attend the meeting to watch his representative in action. If you think you might be willing to "try your luck" during Frosh elections, try to attend a Senate meeting. The Vice-President of the Student Body serves as the Speaker of the Senate, the Senate's presiding officer.

The JUDICIAL branch of our government consists of eight Student Court Justices and the Chief Justice. The President of the Student Body appoints the 9 Justices. The Student Senate must approve these appointments and select the Chief Justice.

Active in many campus activities, Student Government sponsors the following: Homecoming, Life Planning Week, Parents' Weekend, Leadership Camp, the Greenbackers, Student Elections, Freshman Activities, and the Blood Drives. These are only a few, as you may see by consulting the chart of student government.

Incoming freshmen can take an active part in student government activities. Freshmen elections will be held just a few weeks after the opening of school and you will be given a chance to elect six representatives from your class to the Senate. However, this is by no means the only way you may enter into the activities of your university government. There are many commissions which are formed during the first few months of school, so just drop in the Student Government Office, and fill out an application. Commission coordinators always consult the file of appointments in selecting their commissions.

STUDENT GOVERNMENT MEMBERS

President of the Student Body Ken Gainer
 Vice President of the Student Body Marna Paulovicks
 Executive Secretary Patricia Kidd
 Business Manager Tom Tweel

THE STUDENT SENATE

Senior Class Senators:

Claren Brooks
 Ted Wiley
 Elaine Thompson
 Bertie Ann Humphreys
 Sally Jewell
 Mike Ferrell
 Frank Varacalli
 Ralph McBrayer, alternate

Junior Class Senators:

Mike Carroll
 Francis Fabi
 Brenda Hubbard
 Larry LeMasters
 Larry Dezio
 Hobert Raikes
 Dean Thompson, alternate

Sophomore Class Senators:

Joan Fleckenstein
 Danie Stewart
 David Cramp
 Jane McCaskey
 Carolyn Fleming
 Vicki Massey, alternate

RECOGNITION AND HONORARY ORGANIZATIONS

ALPHA EPSILON DELTA — Honorary pre-med fraternity for students with an over all 2.8 academic average.

ALPHA KAPPA DELTA — Honorary sociology fraternity.

ALPHA LAMBDA DELTA — Honorary academic fraternity for freshmen women who attain a 3.5 academic average the first semester of the freshman year or a 3.5 over all average at the end of the second semester of the freshman year.

ALPHA PHI OMEGA — National service fraternity for men who have previously been in scouting and have attained good scholastic standards.

ALPHA PSI OMEGA — National dramatics fraternity.

CHI BETA PHI — National science honorary fraternity. Membership is extended to these students majoring in one of the sciences

who has attained at least 20 hours in his science field with a 3.0 academic average in science and an over all 3.0 average.

D-RHO D-THETA — Honorary engineering fraternity.

DELTA OMICRON — National music honorary fraternity. Membership is extended to those who have attained a 3.0 average in music and at least a 2.0 over all average.

ETA MU PI — National recognition fraternity for retailing students.

ETA SIGMA PHI — National honorary fraternity for students of classical languages.

FAGUS — Senior women's leadership honorary fraternity which was founded in 1950-51 on Marshall's Campus by local members of Mortar Board, national senior women's honorary. Members are elected the second semester of their junior year on the basis of scholarship, leadership, character, and service.

FOURTH ESTATE — Women's honorary journalism fraternity.

GAMMA THETA UPSILON — National geographical honorary fraternity.

KAPPA DELTA PI — National education honorary fraternity. Membership is extended to students in Teachers College who maintain an overall 3.0 average.

KAPPA OMICRON PHI — National home economics honorary fraternity.

OMICRON DELTA KAPPA — Men's national leadership honorary fraternity for Junior and Seniors which was established on Marshall's campus in 1947. Members are selected on the basis of good scholarship and leadership in three fields.

PHI ALPHA THETA — National honorary history fraternity.

PERSHING RIFLES — Military honorary for freshmen and sophomores.

PHI ETA SIGMA — Honorary academic fraternity for freshmen men who attain a 3.5 academic average during their first year of college.

PHI MU ALPHA — National music honorary fraternity.

PI DELTA PHI — National French honorary fraternity. Membership is extended to those attaining a 3.0 average in French and one advanced course and an 2.8 over all average.

PI KAPPA DELTA — National debate honorary fraternity. Membership is extended to those who have participated in five judged debates.

PI SIGMA ALPHA — National political science honorary fraternity.

PI OMEGA PI — National business education honorary fraternity.

PSI CHI — National honorary psychology fraternity. Membership is extended to any student majoring or minoring in psychology who have completed 12 hours with a 3.0 average and maintaining a 3.0 over all average.

ROBE — Local men's honorary fraternity which strives to promote school spirit and student participation in projects that further the purpose of the University.

SCABBARD AND BLADE — National junior and senior military honorary fraternity.

SIGMA DELTA PI — National Spanish honorary fraternity.

RESERVE OFFICER TRAINING CORPS

The ROTC battle group is composed of the men in companies A, B, C, D, N, and Headquarters. Each Tuesday at 11 A. M. the battle group converges on the drill field on the west campus for their regular drill. A Second Lieutenant's commission awaits the student who participates in the ROTC for four years and supplements his experience with summer boot camp. The group acts as an organization, taking part in Homecoming and the annual blood drive. Student military leadership is developed through the battle group program. Student leaders are chosen to head each company on the basis of academic ability, military skill, extra-curricular activities, and work in summer camp.

Freshmen and sophomores are eligible for membership in Pershing Rifles. Purpose of the organization is to develop a highly skilled drill team and promote brotherhood among the members of the ROTC unit.

INTEREST ORGANIZATIONS

ALPHA BETA ALPHA — An organization for students interested in library science.

AMERICAN CHEMICAL SOCIETY — An organization for students majoring in chemistry.

GERMAN CLUB — An organization for students interested in German culture.

HOME ECONOMICS CLUB — An organization for all home economics majors.

INTERNATIONAL RELATIONS CLUB — An organization for those interested in foreign affairs.

LA SOCIEDAD HISPANICA — An organization for students interested in Spanish.

LE CERCLE FRANCAIS — An organization for students interested in French culture.

MARSHALL CLASSICAL ASSOCIATION — An organization for students interested in classical languages.

MARSHALL ENGINEERING SOCIETY — An organization for junior and senior engineering students.

MUSIC EDUCATORS ASSOCIATION — This organization is open to all music majors.

PSI SOCIETY — An organization for psychology majors.

RADIO CLUB — An organization open for all students interested in working with Marshall's radio station, WMUL-FM.

STUDENT NATIONAL EDUCATION ASSOCIATION — An organization for those students who plan to teach.

VARSITY "M" CLUB — An organization open to students who have won a letter in an intercollegiate sport.

VETERANS CLUB — Membership is open to all armed forces veterans.

WOMEN'S ATHLETIC ASSOCIATION — An organization open to all women on the Marshall Campus.

YOUNG DEMOCRATS CLUB — An organization that promotes interest in the Democratic Party.

YOUNG REPUBLICAN CLUB — An organization that promotes interest in the Republican Party.

MU ALPHA THETA — State science interest club.

SOCIAL ORGANIZATIONS

Fraternities and Sororities

A fraternity is a group of men or women joined together in common bond who have pledged themselves to the pursuit of the highest standards of achievement and conduct. The best fraternities manifest a commitment to these standards in their daily operations.

A fraternity is closely associated with and considered an integral part of the University community. The principles and objectives of a fraternity complement the expressed aims of institutions of higher education. Membership gives rise to an inter-personal relationship which enhances personal growth, engenders a spirit of cooperation, and develops a sense of responsibility.

Whether or not to join a fraternity is a decision that each individual must make for himself. The value of association with any group is only as beneficial as the individual himself chooses to make it.

FRATERNITIES (All National)

"Greek Groups"

ALPHA SIGMA PHI — Jerry Miller, President

KAPPA ALPHA — Bob Tittle, President

KAPPA ALPHA PSI — Henry Parrish, President

LAMBDA CHI ALPHA — Tom Young, President

PI KAPPA ALPHA — Ralph McBrayer, President

SIGMA ALPHA EPSILON — Fred Gumma, President

SIGMA PHI EPSILON — Bob Altamare, President

TAU KAPPA EPSILON — Don Smith, President

ZETA BETA TAU — Kieve Pearlman, President

SORORITIES (All National)

ALPHA CHI OMEGA — Donna Gail Lytle, President

ALPHA SIGMA ALPHA — Linda Ranson, President

ALPHA XI DELTA — Nina Hatfield, President

DELTA ZETA — Janis Kemp, President

SIGMA KAPPA — Barbara Collins, President

SIGMA SIGMA SIGMA — Claren Brooks, President

"Independents"

I. S. A. & CAVALIERS — Gene Casto, President

SOCIETAS — Ann Combs, President

RELIGIOUS GROUPS

KAPPA DELTA CHI — The purpose of this organization is to stress religious life on the Marshall campus. It is open to anyone planning to enter full-time Christian service.

CAMPUS CHRISTIAN FELLOWSHIP — This organization serves to unite students in Christian fellowship and service. It is open to all students.

CANTERBURY CLUB — This organization provides worship and fellowship for Episcopal students. Meetings are held Sunday evenings.

NEWMAN CLUB — This organization is the Catholic fellowship group.

BAPTIST STUDENT FELLOWSHIP — This group meets each Sunday evening at the Fifth Avenue Baptist Church.

WESTMINSTER FELLOWSHIP — This is the Presbyterian student group and meets each Sunday evening at the First Presbyterian Church.

STUDENT PUBLICATIONS

CHIEF JUSTICE — Presenting a pictorial review of the academic, social, and athletic year plus interesting sidelights is the job of the Marshall University yearbook, the **CHIEF JUSTICE**. Its editor and business manager are selected by a Faculty-Student Committee and approved by the Student Senate. With such a gigantic job as covering the entire college year, the Chief Justice affords freshmen an excellent opportunity to display their talents and still have fun at the same time. Your copy of the Chief Justice is paid for in your activity fee, so be sure to get it.

THE PARTHENON — Written and edited by students in the Journalism Department, the **PARTHENON** is published twice weekly during the regular school year and once a week during the summer terms. The Parthenon covers everything from club meetings and intramural games to the State Board of Education and varsity athletic contests. It is distributed each week on Wednesday and Friday in the Union, Science Hall, Old Main, and University Cafeteria. Your Activity fee also pays for your subscription to the Parthenon.

STUDENT DIRECTORY — This book is published by the Marshall University Student Government contains the name, home address, phone number, and local address of students, faculty, and administration members. It is an invaluable aid to all students.

SHAVETAIL — This is published by the R.O.T.C. students.

ET CETERA — This is the campus literary magazine published in the spring by the Et Cetera Commission of Student Government. It contains poetry, short stories, and essays. Any student may contribute material to be judged for publication in this magazine.



Sports

A LOOK AT SPORTS

Marshall University is a member of the National Collegiate Athletic Association and of the Mid-American Conference which includes Bowling Green University, Kent State University, Marshall University, Miami University, Ohio University, Toledo University and Western Michigan University. Marshall competes with all the conference schools in football, basketball, baseball and golf; and with some of the conference foes in tennis, wrestling, and track. Since freshmen cannot participate in varsity athletics, a fine program has been set up to invite freshmen into the Marshall athletic program.

Here is a chance to win recognition for yourself and honors for your school; so all you freshmen try out for the sport of your choice and let's make the athletic teams of Marshall University something to be proud of.

FOOTBALL — Head Coach Charlie Snyder's rebuilding program reaped many dividends last year. Besides having an All M. A. C. end who was ranked nationally in pass catching and a quarterback who gained national prestige, the Big Green had the most successful season the public has seen in many a year. The outlook for this year is even more promising due to the return of most of the key players plus some promising freshmen from a good freshman team.

This year we have many added attractions to make the games more enjoyable and exciting. There will be a High School Band Day, R. O. T. C. Day, Parents Day, a fireworks show and the always exciting Homecoming Game.

Support is something that our team will have to have in order to excel on the gridiron. So let's really show them that we are backing them and want to see them win!

All home games are played at Fairfield Stadium. Our away games are within easy driving distance and they are always fun.

Overall we should have a fine season if you support and cheer the Big Green to victory both home and away!

BASKETBALL — The basketball team will be under the direction of our new coach Ellis Johnson. Coach Johnson was a very successful coach at another institution before coming to Marshall and this should be an excellent indication of a winning season.

The return of the famous "Baby Bombers" plus the freshman team which had a tremendous season should give the students an exciting night at Memorial Field House.

The Big Green plays one of the toughest schedules in the country and our support will be a great factor toward a winning season.

BASEBALL — With Coach Alvis Brown at the helm, Marshall University has built up one of the finest baseball programs in the area. The team plays two games with each of the Mid-American Conference teams plus twelve other games outside the conference.

The team had a good season last year and prospects look great this year. So if you have any talent why not try out for the team.

WRESTLING — Wrestling is becoming more popular each year which is evident by the increase in matches and the increase in wins each year.

Wrestling affords many thrills and much entertainment. This sport offers the student who is not big enough for football or basketball the opportunity to engage in a fine competitive sport since the weight classes start at 125 pounds. If you're small or large, just as long as you're interested see Coach Ed Prelaz.

GOLF — Last year the golf team had an excellent record and due to the return of the top three men, Coach "Buddy" Graham is already predicting a conference championship for this year's team.

The team plays a tough schedule against the best competition and is respected by all opponents.

If you have any golfing ability, you are urged to try out for the team. Our home matches are held at the beautiful Spring Valley Country Club.

TENNIS — Tennis is a tough, competitive sport that is continually growing. Each year our team, coached by Ray Cumberland and John Noble, faces stiff competition from conference teams and from outside the conference. We usually have a winning team and prospects look

good for this year. So you freshmen grab a racket and try out for the team.

TRACK AND FIELD — Track at Marshall continues to improve. The Big Green had a winning season last year and coach Charlie Kautz should have an even greater season this year. All home track meets are held at the men's physical education building.

This is a sport that has many opportunities for those of you who cannot participate in the other sports. If you have the ability, Coach Kautz will gladly give you the opportunity.

The 75-piece band is beautifully led by our line of seven **MAJORETTES** and one head majorette. These girls are chosen for the honor in the spring of each year by a series of practices and tryouts. If any of you girls are interested, look forward to next spring and brush up on your marching, twirling, and smiling; that's the basis on which you are chosen.

Our **CHEERLEADERS** are an outstanding crew of gals. The six regulars and two alternates are also chosen in the spring. Don't worry "fellows" you can be a cheerleader too, just try out the same time as the girls do. Also a freshmen cheerleading squad is chosen in early autumn to cheer for the freshmen teams.

The "**GREENBACKERS**," the Flash Card Section at our home football games, was organized four years ago. Its purpose is to promote school spirit and enthusiasm and to add color and life to the football games. The Greenbackers is composed of 900 members, half frosh and half upperclassmen, and they sit on the 50 yd. line. All those interested should sign up during Freshmen Week.

INTRAMURAL — The broad intramural program here at Marshall offers an opportunity for every student to participate in the sport or sports of his liking attempting to promote athletics in every field of athletic interest. The intramural program includes over 136 different sports, making our intramural program the most active of any university in the nation.

The men's intramural program is directed by the Phys. Ed. Dept. With the help of four student assistants and one graduate assistant, and the Intramural Board, the program is conducted very smoothly. The fraternities are very active in this program. The intramural program was originally organized and developed by Otto "Swede" Gullickson, recently retired.

The Women's Athletic Association conducts a program of events and tournaments for the athletically minded girls. Sororities compete in this program on a group basis too.

GLOSSARY

1. **AID:** Short term loans for 60 days and long term loans of 2, 3, or 4 years administered in the Dean of Men's Office, Old Main 116. There is no interest charged unless you fail to pay in the allotted time.
2. **ALUM:** Short for alumnus or alumnae which means a person who has attended or been graduated from a school, college, or university.
3. **ARMOR:** Various number of pins (sorority or fraternity) worn by females.
4. **A & S STUDENT:** Anyone who is not going to be a teacher, nurse, or engineer, e. g. Arts and Science Student.
5. **BIDS:** Invitations issued to dorms, sororities, and fraternities to attend various organization dances. It also designates an invitation to join an organization.
6. **BMOC:** "Big man on the campus."
7. **BWOC:** "Big woman on campus." A gal with beauty plus brains who manages to hold honors in many campus activities.
8. **BRIDGE:** A pre-requisite to graduation: class meets daily in the Union.
9. **BULL SESSIONS:** Where anything from A to Z is discussed until the wee hours in the morning; provides for many enjoyable hours in the dorms.
10. **CAP AND GOWN:** The symbol of four (?) years of fatigue.
11. **UNIVERSITY BULLETIN:** Issued every other year which contains requirements, course & curriculum descriptions, and general information about the university.
12. **COKE PARTY:** The "get-acquainted" party given for rushees by the sororities.
13. **CRAMMING:** The painful result for those who forget to study "day by day."
14. **CULTURE:** It's not a disease, but a well-rounded student has it.
15. **DEAN'S LIST:** The entire list of students who earn a 3.0 or above during a semester.
16. **DORM:** Your home away from home during the next four years.
17. **EIGHT O'CLOCK:** Classes resulting from the theory that "The early bird gets the worm."
18. **FISH POND:** Of historical interest as Fraternity and Sorority pin-mates were at one time dunked into the Fish Pond in Ritter Park. The custom is still often observed.
19. **FINAL EXAMS:** Farewell parties sponsored by class professors at the end of each semester!!!
20. **FIRE-SIDE CHATS:** Informal talks among campus groups during Life Planning Week and Greek Week.
21. **FIW:** Failure because of Irregular Withdrawal—this puts you on Academic Probation. If you want to drop a class, do so through your respective College Dean. This is the Dean's "Pet Peeve."
22. **FROSH WEEK:** The first week of school dedicated to helping you freshmen become acquainted with Marshall.
23. **FLUNK:** Fail a course, You've had it, friend.
24. **GREEKS:** Anyone who is affiliated with a sorority or fraternity with Greek names.
25. **HOLIDAY:** Vacations at Thanksgiving, Christmas, and Easter.
26. **HOME COMING:** The week-end designated for the return of the ALUMS and also a "Student Remaining" week-end.
27. **I. D. CARDS:** You can pick these up during Frosh Week, and you must present them at all intercollegiate sports, cultural programs, the Library, and for voting.
28. **IFC:** Inter-Fraternity Council.
29. **LATES:** Upperclassmen get 11:00 permission on Wednesday nights several times a semester.
30. **LEADERSHIP CAMP:** A meeting of the campus leaders prior to school to plan the coming year.
31. **LOCKERS:** 12 books at a time can become mighty heavy, so go to Room 103 in Old Main, for lockers are issued there for Old Main or the Science Hall; it is one dollar per lock, but you get your money back when you return it.
32. **LOST AND FOUND:** The Dean of Women and Dean of Men handle this problem.
33. **MIX:** The Wednesday night dances in the Union.
34. **OFFICE HOURS:** 8:00 until 4:15 for all administrative personnel.

35. **PAN-HEL:** Pan-Hellenic Association of Sororities.
36. **PROBATION:** When students do not make their required grades, they are limited to a 12-hour load.
37. **RUSH:** A period where sororities and rushees, and fraternities and rushees get acquainted. The sororities and fraternities finally issue bids to rushees to become affiliated with the organization.
38. **RUSHEE:** If you are rushing a fraternity or sorority, you are a RUSHEE.
39. **SACK TIME:** That longed-for break meaning "sleep-time."
40. **SCHOLARSHIPS:** These are administered at the Dean of Men's Office, Main 116.
41. **SEMESTER LOAD:** Average 16 hours; be careful, Frosh . . . don't bite off more than you can chew.
42. **SHEEP'S SKIN:** The diploma of our Alma Mater.
43. **SMOKER:** The get-acquainted gatherings for you guys; these are sponsored by the campus frats.
44. **STUDENT ACTIVITIES CARD:** Fee paid for this card entitles admission to university activities, free tickets, and your Yearbook.
45. **SUITCASE:** Something to be used only during Thanksgiving, Christmas, Easter, and the semester break.
46. **SUITCASER:** Refers to someone who goes home every week-end and misses out on all the campus fun. Amen!!
47. **SNAP:** A course which requires little or no work. We have such a thing?
48. **TGIF:** "Thank God It's Friday" parties.
49. **TRANSCRIPTS:** When transferring to another college or university, the Registrar's Office will make out the first one free, but any others will cost \$1.00 each.
50. **TRANSFER:** Comes here from another school.
51. **TUTORING SYSTEM:** Alpha Lambda Delta and Phi Eta Sigma tutor women and men respectively at \$1.00 an hour. Take advantage of this if you need it.
52. **UNIONOLOGY:** Be careful, don't spend too much time on this course. Most freshmen decide to major in it but soon change their minds.
52. **VETERANS:** All information concerning veterans is in the Registrar's Office.