

Marshall University

## Marshall Digital Scholar

---

Marshall University Student Handbook

University Archives

---

8-1964

### The Student Handbook of Marshall University, 1964-1965

Marshall University

Follow this and additional works at: <https://mds.marshall.edu/studenthandbook>



Part of the [Higher Education Commons](#)

---

#### Recommended Citation

Marshall University, "The Student Handbook of Marshall University, 1964-1965" (1964). *Marshall University Student Handbook*. 27.

<https://mds.marshall.edu/studenthandbook/27>

This Book is brought to you for free and open access by the University Archives at Marshall Digital Scholar. It has been accepted for inclusion in Marshall University Student Handbook by an authorized administrator of Marshall Digital Scholar. For more information, please contact [zhangj@marshall.edu](mailto:zhangj@marshall.edu), [beachgr@marshall.edu](mailto:beachgr@marshall.edu).

ARCHIVES

StP  
1.28  
1964-65  
cop.2

Marshall University



---

---

COOK PRINTING CO.  
HUNTINGTON, W. VA.

---

---

Student Handbook  
1964-1965

# THE OFFICIAL STUDENT HANDBOOK

Dedicated to Dr. Elizabeth Cometti,  
a scholar and teacher.



Published by

The Student Handbook Commission of the  
MARSHALL UNIVERSITY STUDENT GOVERNMENT

DAVID M. PANCAKE, Secretary Publications and Public Relations

JANET RATCLIFF, EDITOR

Bob Barnette, Linda Brabban, Brenda Faulkner

Mary Lind Hagan, John Hoover

A. Ann Huffman, Judy White

1964 - 1965



**JOHN MARSHALL**

"The services of Marshall will always remain as an inspiration to young America as well as to the older generations. He stands as an example of courage, perseverance, and self-sacrifice. He ranks among the founders of the Nation; he early formed definite habits of thinking which crystallized his character. To these principles he remained adamant. As a lawyer, he knew the drudgery incident to the careful preparation of an argument in court. As a legislator he studied the fundamental principles upon which a democracy must be founded. As a member of Congress he rose to the defense of a President who was carrying out the duties of his office. As an envoy he outwitted the craftiest statesman of France. As Secretary of State he gave the first outlines of a strong foreign policy. As Chief Justice of the Supreme Court he rendered decisions which have influenced and molded the character of the American Nation. John Marshall, born of humble parentage in Virginia, rose to a position of power and prominence equal to that of the presidency . . . His memory will be an inspiration in the years to come to the thousands of students of this University who will take with them into the world the influence of this great American which is still a vital living force in our Nation."

(Above quote from J. F. T. O'Connor from  
One Hundred Years of Marshall College.)



**DR. STEWART H. SMITH**  
President of Marshall University

### **PRESIDENT'S MESSAGE**

To the Class of 1968:

We are glad that you chose Marshall as your University. We hope that all of you will graduate. Most of you will live up to your fine promise. Some day your country may honor some of you for your achievements.

You have already begun to lay the foundation for your future successes. At Marshall you will make many important decisions. Your course of study is a choice you must make. The planning of your time, the number of hours spent in serious study; these are matters for you to determine. The time you will spend in extra-curricular and social affairs is left in your hands. Your choice of a career will be one of your most important decisions.

Our faculty and administrative officials want to help you and we are available. All you need do is seek our counsel.

A university education should make your life richer and more meaningful. The knowledge and vision acquired here will prepare you not only for a finer life but also for greater service to others.

Cordially yours,  
STEWART H. SMITH  
President

DICK COTTRILL



**MESSAGE FROM THE PRESIDENT  
OF THE  
STUDENT BODY**

Dear Freshmen,

Welcome to Marshall University! You are beginning a new and exciting phase of your life. It is a sincere hope that you will learn to take advantage of all the educational opportunities of the University.

Remember that you learn by mistakes, so enter into the life of the University with enthusiasm. Study hard and learn to budget your time.

Give your loyalty first of all to the University, but then become conscious of the many extra-curricular activities that are a part of the University. Seek the one that is right for you, whether it is a fraternity or sorority, one of the religious groups, or perhaps one of our active honoraries. There is a place for you on this campus, so seek it out and become involved in it.

Maybe you are interested in government or committee work. If so, the Student Government can offer an outlet for your talents and a chance for real service to the University.

I sincerely hope to meet and get to know you during the coming school year. Feel free to become acquainted with the Student Government Office at any time.

Sincerely,  
DICK COTTRILL  
Student Body President

**FRESHMAN WEEK**

Freshman Week is a tradition at Marshall, and it can be fun for everyone! No doubt you have heard many gruesome tales of the horrors of Freshman Week, but these are certainly exaggerated. Freshman Week has not been designed to terrorize or humiliate you; its purpose is to make you feel at home on Marshall's campus.

**FRESHMAN GUIDES**

You will be assigned to a specific group of fellow students headed by Freshman Guides. These guides will show you the interesting places and buildings on Marshall's campus and will answer any questions you may have about Marshall University. Please do not feel hesitant about asking for information. However, after reading this Handbook and the Marshall University Catalogue, you will probably find that most of your questions have been answered. In case they haven't, then fire them at the Guides! Remember they asked about the same things when they were Freshmen.

**FRESHMAN GUIDES SEPTEMBER 1964**

Gretchen Adkins	Rose Marie Frecka
William R. Allen	David Frost
Linda Brabban	Nancy Ellen Glazer
Ronald R. Brandon	Vincent Gonzalez
Arlene Bruno	Claire Grace
Kennylee Ann Burgess	Sarabeth Grant
Kathryn Burke	Douglas Robert Hardman
James M. Byrd	Rose Marie Hayes
Catherine Call	William Curtis Hedrick
Margaret Carroll	Erica Henderson
Jean V. Cattano	Nancy Louise Hickman
Linda Cornett	Charlotte Hoffman
Harold Dodd, Jr.	Roy Emmett Huffman
Penelope Douglas	Glenda Lec Hyer
Sharon Kaye Estep	Catherine Imbrogno
Francis Fabi	Elaine Johnson
Phil Farthing	Thomas E. Johnson
Michael Howard Ferrell	Charles F. Jordan
Rosemary Flaherty	Elaine Keagy
Carolyn Fleming	Terry N. Keller
Richard Forth	Patricia Kennedy

Betty Kessler  
 Janet King  
 Michael Leckie  
 Sandra Lynn Lilly  
 Mary Margaret Loemker  
 Lawrence Alan Magariello  
 Jane McCaskey  
 Rebecca McDaniel  
 Carolyn DeDonei  
 Sally Anne McGrath  
 John Allen Murphy  
 Laura Louise McGrew  
 Jennifer Nagle  
 Carl K. Nestmann  
 Penelope Nichols  
 Janis O'Hara  
 Charlotte Parsons  
 June E. Patton  
 Diana Sue Petty  
 Jerry Phelps  
 Patricia Pierce  
 Hobert Raikes  
 Emelie Ruffier  
 Sandra Rutherford

Sharon Ann Reed  
 Kay Marie Sage  
 Leonard Samworth, Jr.  
 Becky Sansom  
 Sharon Schwarz  
 Margaret Ellen Shepard  
 Patricia Ann Smith  
 Virginia C. Smith  
 Jim Stevenson  
 Mary Ann Stultz  
 Donna Sturgeon  
 Somelias Sutikulphaut  
 Patricia Ann Taylor  
 Mary Elizabeth Theis  
 Loretta Ufheil  
 Jane Virgallito  
 Juliette Wiles  
 Kathryn V. Williams  
 Anna Marie Wilson  
 Quentin T. Wilson  
 Mary Margaret Wood  
 Jane L. Woodburn  
 Charlotte Zelnak

## THE RULES AND THE RULERS

Many universities, Marshall included, employ the use of beanies to distinguish their freshmen. So be sure you're always seen with your little green chapeaux, or you may find yourself face to face with an Enforcer. Freshmen Enforcers are upperclassmen who have been chosen by the Freshman Activities Commission. They can easily be identified by their name tags to which are attached green and white ribbons.

If you are caught violating one of the Freshmen Rules — perish the thought — one of the Enforcers will give you a ticket. The Freshman Court will then decide your penalty. A word to the wise: In the history of Marshall, not once has an Enforcer ever lost a case!

The following rules governing Freshman Activities have been drafted by the Freshman Activities Commission for 1964-1965:

1. Freshman Rules will go into effect Monday, September 4, 1964.

They will end on Saturday, September 26, 1964, if the Freshman men win the tug-of-war. If the rope breaks the Freshmen lose. If the Freshmen lose the tug-of-war, the rules will continue to be in effect for one week until October 5.

2. Freshman caps, handbooks, and name plates are to be worn at all times during the day from 8:00 A. M. to 5:00 P. M. and to all Freshman activities. However, Freshmen men must not wear their caps in the classrooms, ROTC formations, or other buildings on campus.
3. Freshmen are required to speak to all persons they see on campus.
4. Freshmen are required to walk on the walk-ways and shall not cut campus at anytime.
5. Freshmen are urged to attend all home football games and Pep Rallies.
6. Freshmen will be required to sing or recite upon request at anytime the following:
  - a. Alma Mater
  - b. The year which Marshall was founded
  - c. The name of the President and Vice-President of the Student Body
  - d. The school song "We Are the Sons of Marshall"
  - e. The name of the President of the University
  - f. The name of the Dean of Men, Dean of Women, the name of your own Academic Dean, and your own Academic Advisor
7. Freshmen cannot wear any article of clothing that pertains to any school other than Marshall University.
8. Freshmen cannot sit in the booths by the windows in the Student Union, and at the request of any upperclassmen, must relinquish their seats.
9. During the Freshman Activities period, Veterans must follow all the rules as the Freshmen with the exception of purchasing beanies.

10. Freshmen are required to carry a schedule of their classes with them while on campus for as long as the Freshman Rules are in effect.
11. All Freshmen are encouraged to join the Greenbackers.
12. Freshmen cannot be served at the Student Union counter if upperclassmen are waiting to be served.
13. Freshmen are required to know the names of all buildings on Marshall's campus.
14. Freshmen are required to know all markings (Beech Tree, ODK Circle, etc.) on Marshall's campus.

## ALMA MATER

Marshall gracious Alma Mater  
 We thy name revere;  
 May each noble son and daughter  
 Cherish thine honor dear.  
 May thy lamp be ever bright,  
 Guiding us to truth and light;  
 As a beacon o'er dark water  
 This is for thee our prayer.

### Second verse:

May the years be kind to Marshall  
 May she grow in fame;  
 May her children fail her never,  
 True to her beacon flame.  
 May her spirit brave and strong  
 Honor right and conquer wrong;  
 This the burden of our song,  
 Ever her truth proclaim.

## "WE ARE THE SONS OF MARSHALL

We are the sons of Marshall  
 Sons of the great John Marshall  
 Year after year we go to Marshall U  
     Cheering for the team and gaining knowledge too  
 Proudly we wear our colors, Love and Loyalty we share,  
 Sure from far and near you'll always hear the  
     wearing' of the green  
 For it's the Green and White of Marshall U.

## THE HISTORY OF MARSHALL

When you step into the campus of Marshall University this fall of '64, you will be confronted with the school's interesting past and promising future. Her past began in 1837 when John Holderby purchased one and one half acres of land for \$40.00. He requested that the estate always be used for school purposes. 1964-1965 marks the 127th year of the estate as an educational institution.

John Laidley is considered to be the Founder of Marshall University; it was then called Marshall Academy after Laidley's close friend, Chief Justice John Marshall. By an act of the Virginia Assembly in March, 1858, the Academy became Marshall College and was given the authority to confer degrees.

The school was sold because of debts during the Civil War, but a private school was housed at this time because of the terms of the original deed. When the new state of West Virginia was created, Marshall was soon revived under State control.

Today, with over 35 acres in the heart of Huntington, Marshall is a multimillion dollar institution, possessing twenty-two permanent buildings and several temporary structures. Our newest building, the women's dorm, will be open this year for the first time. Marshall also provides housing for its married couples in the new University Heights apartments. We have more land out on Route 60 which is now being planned for our campus. In the near future, a new classroom building will be erected on the ROTC field, and where Old Main stands, a music and concert building will be built. Money for this project has already been appropriated by the State.

Marshall maintains an Evening School, a college extension program and off-campus workshops as well as our four colleges: the College of Arts and Sciences, the Teachers' College, the College of Applied Sciences, and the Graduate School. This past year saw the opening of two new branches of Marshall; these are located in Logan and Williamson.

We are accredited by the North Central Association of Colleges and Secondary Schools and the National Council for accrediting of Teaching Teacher Education. The university is approved by the American Association of University women and is a member of the Association of American Colleges and the American Council on Education.

Marshall has grown beyond all expectations and she is still expanding. Her future lies unlimited.

## TRADITIONS

In front of Old Main stands the **BUST OF JOHN MARSHALL**. Our University was named after John who was Chief Justice of the United States Supreme Court. His principles and ideals are also those of Marshall: Equality, Democracy, and Individual Freedom.

The **OLD BEECH TREE**, standing for more than 300 years, is symbolic of the tree of life. It also represents the growth of Marshall from an Academy to its present University status. The Beech Tree is also located in front of Old Main.

Omicron Delta Kappa, men's leadership honorary, has enriched our campus with their contribution of the **ODK VICTORY BELL** and the **ODK CIRCLE**.

Sounding from beside the Music Building, day or night, you may hear our ODK Victory Bell. It is traditionally rung after each victory in the field of sports or knowledge. The bell is rung to remind us that victory is not always won at Fairfield Stadium or Memorial Field House, but also in the every day trials and tribulations of college life.

Located in front of the Student Union tennis courts is a red brick circle enclosed by concrete benches with the emblem ODK in the center. This is our ODK Circle which is sometimes used by organizations for public initiations. Many students find the circle a place for conversing, resting, meetings, or just sunning.

The traditional **TUG OF WAR** between the Freshman football team and a group of upperclassmen symbolizes the quest of the Frosh to be accepted. If the Freshmen win, off come the beanies and goodbye to the Freshman Rules. If the rope breaks or the upperclassmen overpower, then the rules will stay in effect until a later date. The battle will take place during a half-time football game which will be announced. Good luck, but, remember, Win or Lose — Be a Good Sport!

One of Marshall's most unforgettable and enjoyable weekends is **HOME COMING**. It promises to be a weekend that will leave your head swimming from all the excitement. Many of our Alums return to the campus to renew bonds, to observe the changes, and to live it up with us, the undergrads!



A week prior to Homecoming, an election is held to choose class queens and "Miss Marshall". All full time women with an overall "C" average are eligible to run for queen in her respective class. The girls must secure a petition from the Student Government office. Marshall's best are chosen at the polls with the senior queen reigning over the festivities as "Miss Marshall".

On Friday of the big weekend at the intramural field, our pep rally is held. Maybe "Swede" will preside again to start off the fun-filled Homecoming weekend with a bang! On Saturday the House decorations of the dorms and sororities will be judged. That afternoon, the colorful parade, starting around noon, will travel through downtown Huntington. The elected campus beauties will ride on a float built by one of the fraternities. The other fraternities will be in competition with their float entries. The Band, Majorettes, Cheerleaders, and ROTC also join in to put on a parade to remember!

Next, it's off to the game. Unlike our others, everyone dresses up for Homecoming. The Greenbackers and an enthusiastic crowd will be all the support for a victory that any team could desire. After the game comes a round of reunions and open houses. Finally, to top off the evening there's a dance at the Memorial Field House where you can dance the night away to the music of a "name" band.

Marshall is known for her great and exciting Homecomings, and this year's promises to be the best yet!

One week of our college life is set aside during second semester for you, the student, to evaluate yourself, your life, and your future. This is our **LIFE PLANNING WEEK**. A main theme is selected and speakers from all parts of the nation are brought to speak with various classes, the entire student body, and "fire-side" groups. This week deals with life's confusing problems and we hope that it will aid you in your quest of finding "yourself". Religion plays a part in this week as it does in all of life. You are urged to attend the week's sessions for you will profit tremendously by it.

The Greek fraternities and sororities unite to provide entertainment in antics and contests in their annual Greek Week. This week includes fireside chats and exchange dinners among the various Greeks. On a Saturday afternoon at the intramural field, the Greeks compete in games for a trophy. Last year the ancient Greek torch was run from Charleston to Marshall by the Fraternities. The Highlight of the Week is the Greek Week Dance at which

the Greek woman and man of the year are presented. This week is held to promote better relations among the Greeks.

The highlight of second semester is **PARENTS' WEEKEND**. On one spring weekend our parents are invited to visit the campus and participate in the series of entertaining and informative activities presented by the departments and the student body. Sunday afternoon offers for a closing the Mothers' Day Sing.

As a tribute to our mothers the Greek Organizations provide music entertainment at the close of Parents' Weekend. This is our **MOTHERS' DAY SING**. Each fraternity and sorority spends months preparing a song for their group to sing. This has become a friendly rivalry to determine which one sings the best. The winners carry off permanent trophies. The dormitories and Greeks hold open house for the public afterwards.

**LEADERSHIP CAMP** is the "meeting of the campus wheels" the weekend prior to Freshman Week. During this weekend, the student senate, president and vice-president of the student body, members of the administration, officers of organizations, and those students connected with Freshman Week and Homecoming, seclude themselves at a near-by camp to plot and plan the coming school year. It's something that most of you will never attend, but for those of you fortunate enough to make the grade, it's an unforgettable and invaluable experience.

## UNIVERSITY ADMINISTRATION

There is one building on Marshall's campus that all students should know — Old Main. In her halls you will find classrooms, a bookstore, the administrative offices, and various other offices. The first floor houses the administrative personnel. Office hours are from 8:00 A. M. to 4:15 P. M. Your individual instructor's office may differ as to location and hours open, so check with them to be sure.

Room 108 is open to all. If you happen to stick your head in for a peek, a pleasant looking man who has lead Marshall for several years will greet you with a smile. This man is Dr. Stewart H. Smith, our **PRESIDENT**. Once he has met you, he does not often forget your name or face. He will be glad to aid you at anytime with problems which your advisor or dean cannot solve.

Room 110 houses the VICE-PRESIDENT OF ACADEMIC AFFAIRS. The man filling this position is Dr. Harold Walker.

Mr. Joseph S. Soto is our VICE-PRESIDENT OF BUSINESS AND FINANCE. He is in charge of money and building and grounds.

At college, like at home, you will have a guardian who will take care of you from the time you enter until you graduate. He is Mr. Luther E. B. Bledsoe, REGISTRAR. He can be found in Room 105.

The COMPTROLLER has the important job of handling all your money. The man in this position is Mr. Fred Smith, who is located in Room 103.

Serving as ADMINISTRATIVE ASSISTANT AND DIRECTOR OF ADULT EDUCATION is Mr. Paul H. Collins. He serves as an advisor to the president, and in adult education is in charge of the extension classes and the University's evening program. He is in Room 107.

Whenever you women have a problem, Mrs. Lillian Helmus Buskirk, DEAN OF WOMEN, is the one to see. She is always willing to help you at any time. Her office number is 109.

Our new DEAN OF MEN, Dr. John E. Shay, Jr., is in Room 116. Whenever you men are having difficulties, he is the man to see. His office also handles loans and scholarships, lost and found, traffic and parking violations, men's housing, fraternities, and counselling.

If you are in the Arts and Sciences College, Dean J. Frank Bartlett will aid you in your academic problems. He is also the person to see about changing your major or obtaining a credit evaluation. The DEAN of the ARTS AND SCIENCES office is located in Room 115.

The DEAN of the TEACHERS' COLLEGE, in Room 113, serves in the same capacity for those in the teaching field as Dean Bartlett does for those in the field of Arts and Sciences.

The COLLEGE OF APPLIED SCIENCES may be found in Room 116. The DEAN, Dr. A. E. McCaskey, is in charge of engineering, Reserved Officers' Training Corps, nursing education, and medical technology.

After receiving your University diploma, you may decide to do graduate work. Dr. John R. Warren handles your affairs as the new DEAN of the GRADUATE SCHOOL. His office is in Room 111.

Room 112 is the home of the INFORMATION AND PUBLICATIONS DIRECTOR, David Dodrill. He releases news media to local and hometown newspapers, and to radio and TV stations. He also prepares our official University publications.

PLACEMENT DIRECTOR, Mr. Robert Alexander, does the hard job of go-between for students seeking both full and part-time jobs, and employers seeking personnel. Room 114 contains his office.

The James E. Morrow Library, named for a former president of Marshall, is directed by Dr. Harold Apel, LIBRARIAN. Ours is the third largest in the state and contains over 120,000 volumes.

Located in the southeast corner of Old Main is Room 129, the office of Mr. John Sayre. He is DIRECTOR OF DEVELOPMENT AND ALUMNI AFFAIRS.



## STUDENT GOVERNMENT

The purpose of Student Government is to provide an instrument which will make it possible for all students to have a voice in any program which would make Marshall a better University. It is constructed to represent democratically all members of the Student Body. It is designed to reflect student opinion, and to crystallize and make effective any constructive program. It encourages initiative and civic development; it trains for intelligent citizenship.

The Student Government of Marshall University is composed of three branches: The EXECUTIVE, The LEGISLATIVE, and The JUDICIAL.

The EXECUTIVE branch of the government is directed by the President of the Student Body. Under the President, serving in executive capacity, are the STUDENT EXECUTIVE CABINET Secretaries and the COMMISSIONS. The Student Cabinet acts as an advisory group to the President, and its members include the Secretaries of Academic Affairs, Athletic Affairs, Publications and Public Relations, Social Affairs, and Student Government Affairs, and the Executive Secretary, Business Manager, and the Vice President of the Student Body. The Commission heads, better known as the co-ordinators, serve over the various Student Government commissions. The coordinators, five cabinet secretaries, the Business Manager, and the Executive Secretary are all appointed by the Student Body President and are subject to approval of the Student Senate.

### **Student Government Organization**

President — Dick Cottrill  
Vice President — Fred Reeder  
Chief Justice — Wendall English  
Executive Secretary — To Be Announced  
Business Manager — Bob Altamore

### **Executive Branch Cabinet**

President, Vice President, Business Manager, Advisor,  
Executive Press Secretary — Sam Stanley  
Commissioner of Academic Affairs — Francis Fabi  
Commissioner of Athletic Affairs — Steve Goodman  
Commissioner of Publications and Public Relations — Dave Pancake  
Commissioner of Social Affairs — Jennifer Nagle  
Commissioner of Student Government Affairs — Danny Stewart

## **STUDENT GOVERNMENT COMMISSIONS**

### **ACADEMIC AFFAIRS COMMISSION**

The Academic Affairs Commission is headed by Francis Fabi. This commission is in charge of such things as the Book of the Year, Commencement and Honorary degrees, Freshman activities, Freshman Court, Student Scholarships and Loans, Who's Who, and Life Planning Week.

## **ATHLETIC AFFAIRS COMMISSION**

Under the direction of Steve Goodman, the Athletic Affairs Commission oversees the cheerleaders, Greenbackers, the United Fund drive, University athletics (in conjunction with the University), Dad's Day, Intramural finance, and the Robe, men's leadership honorary.

## **PUBLICATION AND PUBLIC RELATIONS COMMISSION**

David Pancake is the commissioner who takes over the responsibility for publication of the ET CETERA, Student Handbook, Student Directory, and the CHIEF JUSTICE. He also oversees the Hospitality, State Awareness, and Public Relations and Publicity committees.

## **SOCIAL AFFAIRS COMMISSION**

Under this commission, Homecoming, Parent's Week-end, and the new Spring Weekend are planned and supervised. This commission sends representatives to the Artist Series Corporation, Student Activities Board, Student Conduct and Welfare Commission, and the Student Union Corporation. Jennifer Nagle is commissioner.

## **STUDENT GOVERNMENT AFFAIRS COMMISSION**

Danie Stewart, commissioner, guides his co-ordinators in the Brood Drive, Civil Service system, elections, Leadership Camp, and the West Virginia Federation Committee.

There are many commissions which are formed during the first few months of school, so just drop in the Student Government Office, and fill out an application. Commission coordinators always consult the file of appointments in selecting their commissions

## **LEGISLATIVE BRANCH**

The Legislative Branch of Student Government is the Student Senate, and it is presently composed of representatives from every class along with Graduate School representatives.

Members of the Student Senate are elected by members of their Class or by the Student Body (in the case of President and Vice President). The student who is seeking membership to the Senate must not be on Social Probation and/or Academic Probation and must have a 2.0 or "C" average. He must also pass an oral and/or

written examination concerning the Constitution and Senate rules before being seated. All of these requirements must be met in order to become an officers in the Student Government.

Representation is now based upon the total percentage of Class members voting in the General Elections. For example, if 40% of a class votes, their class is entitled to four representatives. Forty-one to fifty-five per cent entitles a class to five senate seats. This fall you will go to the polls and elect four regular senators, one alternate senator, and a freshman Class president.

Participation in extra-curricular activities is an asset to an individual's education, and the Student Senate offers a fine opportunity for developing leadership. If you want to participate actively in your University's growth, this is the place to be. If you think you might be interested in entering the Freshman Senate elections, try to attend a Senate meeting. These meetings are held on Wednesdays at 6:30 P. M. and are presided over by the Vice President of the Student Body and Speaker of the Senate, Fred Reeder.

### MEMBERS OF THE LEGISLATIVE BRANCH

Senior Class President — John Cross

**Representatives:**

Aaron Wagner  
Loretta Ufheil  
Donna Sturgeno  
Dean Thompson  
Larry LeMaster

Junior Class President — Joan Fleckinstein

**Representatives:**

Judy Varnum  
Cathy Imbrogno  
Jim Stevenson  
Carolyn Fleming

Sophomore Class President — Hobby Spaulding

**Representatives:**

Dave Frost  
Sue Dilworth  
Sam Samworth  
Larry Bruce  
Nancy Glaser

### JUDICIAL BRANCH

The Judicial power of the Student Government is vested in the Student Court. The problem of administering the rules of the Student Government and seeing that the rights of the students are protected is the duty and function of this branch.

The Student Court has the authority to make decisions concerning the constitutionality of any act passed by the Student Senate, and original jurisdiction in cases involving the constitutionality of actions of the President of the Student Government or of the Student Cabinet. The court is also a body before which disputes between organizations may be heard and resolved. Infraction of University rules and regulations by students may be heard before the court. The Student Court may hear cases referred to it by the administration. Thus, the court has a wide range of duties.

### MEMBERS OF THE JUDICIAL BRANCH

Chief Justice — Wendall English

**Senior Members:**

Charles Ross  
John Young

**Junior Members:**

Dick Hodges  
Mike Smith  
Craig Westfall

**Sophomore Members:**

Tony Broh  
Mike Engle  
Jane Woodburn

Prosecutor — Ronald Jarrell

Assistant Prosecutor — Steve Dare

Secretary — Patty Smith

Baliff — Keith Peters

## STUDENT GOVERNMENT PUBLICATIONS

### STUDENT PUBLICATIONS

**CHIEF JUSTICE** — Presenting a pictorial review of the academic, social, and athletic year plus interesting sidelights is the job of the Marshall University yearbook, the **CHIEF JUSTICE**. Its editor and business manager are selected by a Faculty-Student Committee and approved by the Student Senate. With such a gigantic job as covering the entire college year, the Chief Justice affords freshmen an excellent opportunity to display their talents and still have fun at the same time. Your copy of the Chief Justice is paid for in your activity fee, so be sure to get it. This year, is the first year the Chief Justice has been the responsibility of the Student Government.

**THE PARTHENON** — Written and edited by students in the Journalism Department, the **PARTHENON** is published twice weekly during the regular school year and once a week during the summer terms. The Parthenon covers everything from club meetings and intramural games to the State Board of Education and varsity athletic contests. It is distributed each week on Wednesday and Friday in the Union, Science Hall, Old Main, and University Cafeteria. Your Activity fee also pays for your subscription to the Parthenon.

**STUDENT DIRECTORY** — This book is published by the Marshall University Student Government contains the name, home address, phone number, and local address of students, faculty, and administration members. It is an invaluable aid to all students.

**ET CETERA** — This is the campus literary magazine published in the spring by the Et Cetera Commission of Student Government. It contains poetry, short stories, and essays. Any student may contribute material to be judged for publication in this magazine.

**FRESHMAN HANDBOOK** — This handbook is published by the Student Government as an aid to transfer students and incoming freshmen.



### GENERAL INFORMATION

**BOOKSTORE** — Snuggling under Old Main in the basement, rests the Bookstore. Here, under the efficient management of Mr. Percy L. Galloway, you buy your textbooks, drafting equipment, art supplies, and desk supplies. The hours are from 8 A. M. to 12 P. M. and from 1 to 4:15 P. M. during week. On Saturdays, the bookstore is open from 8 A. M. to 12 P. M.

**BUILDING AND GROUNDS** — If you need something repaired, want to borrow a tool, or need paint for your room, this is the place to go. The office is located under Old Main, and it is open from 6 until 4:30. These are the people who keep our campus so clean and attractive all during the year.

**CAFETERIAS** — Our regular cafeteria is located between Laidley and Hodges Halls at the east end of the campus. Meal hours are: Week Days — Breakfast from 7-9 A. M., Lunch from 11-1:30 P. M., and dinner from 5-6:30 P. M. Saturday lunch is served from 11-12. On Sunday, breakfast hours are from 8:30-9:30 A. M., lunch from 12-1 P. M., and dinner is not served. The new Men's Dorm Cafeteria observes the same hours.

**DEVELOPMENT AND ALUMNI AFFAIRS** — This department, which acts as a link between the University, its alumni, and all other interested groups is located in Room 129 in Old Main. It is supervised by John Sayre, who will be working with us on Homecoming and Parents' Week End.

**DUPLICATING DEPARTMENT** — Our University also offers a duplicating department which will print material for your dormitory, organization, or committee. Mrs. Jeanne Bias manages the department which is located under Old Main across from the Bookstore. It is open from 8-4:15.

**HEALTH SERVICE** — Feeling bad? Well, here is good news. All full-time students receive the health service free after they have paid their health fee during registration. The clinic is located in the basement of Gullickson Hall. Dr. T. Craig McKee and Mrs. Mary D. Summers have office hours of 9-12 A. M. and 1-4 P. M. on weekdays, and 9-12 A. M. on Saturdays. If you need a shot, medicine, or a physical examination, the clinic will be glad to help you.

**INFORMATION SERVICE** — If you need anything along the line of publicity, publications, or public relations of Marshall, David Dodrill can help you. His office is located in Room 112 of Old Main.

**JAMES E. MORROW LIBRARY** — Like most students of Marshall, you will soon become acquainted with this building. There is unlimited reference material available in the library which will be of value to you in your classwork and a great supplement to your learning in the classroom. Try to spend more time in the library, both to accomplish studying and to broaden your scope of knowledge. Library hours are from 8 A. M. to 9:30 P. M. on week days, and Saturdays from 8 A. M. to 5 P. M. Whenever you may need assistance, ask the person on duty at the desk; they will be quite helpful.

The journalism department is located in the basement of the library. Here is where the school newspaper, the PARTHENON, is published.

**PARKING** — The problem of where to park will hound you car owners as you hunt for a place when you bring your car to

school. Daytime parking in the University behind the Science Hall is reserved for the faculty and those cars with special permits issued by the Supt. of Buildings and Grounds. The lot is open to everyone after school hours. Dorm residents park behind their dorms after school hours. Students may park whenever it is legal on the streets. There is no parking on Fifth Avenue between the hours of 3 P. M. and 6 P. M. Make sure that you move your car before three on Fifth Avenue or you will find yourself with a \$5 parking ticket. Limited parking is available in the Engineering Building Lot on the corner of Fifth and 19th Street.

If you violate any of the campus parking rules, you **MUST** report to the Dean of Men's office within 24 hours after the issuance of a ticket. All tickets given by city police concerning parking on the city streets must be handled at the city police station. A first ticket (on campus) is a warning; second offense means an appearance before the traffic committee; third offense means an appearance before the Administrative Cabinet and a possible suspension from school or dismissal.

**PLACEMENT OFFICE** — Another handy department at Marshall is the Placement Office managed by Mr. Robert P. Alexander. Checking at his office, Room 114 of Old Main, will save you a lot of trouble finding a job. Here you also may look for an on-campus job as well as an off-campus one. Office hours are from 8-4:15.

**POST OFFICE** — The Post Office, located adjacent to the Bookstore, handles all of the University's mail. Mr. Galloway runs the Post Office. There packages may be mailed if you have the correct change. It is best to take all packages to the subdivision of the downtown post office, located on Third Avenue above 20th Street.

**PSYCHOLOGY CLINIC** — In Room 307 of Old Main is the Psychology Clinic, which is open to all full-time students. They can help you by consultation with your scholastic, vocational, social, and personal problems.

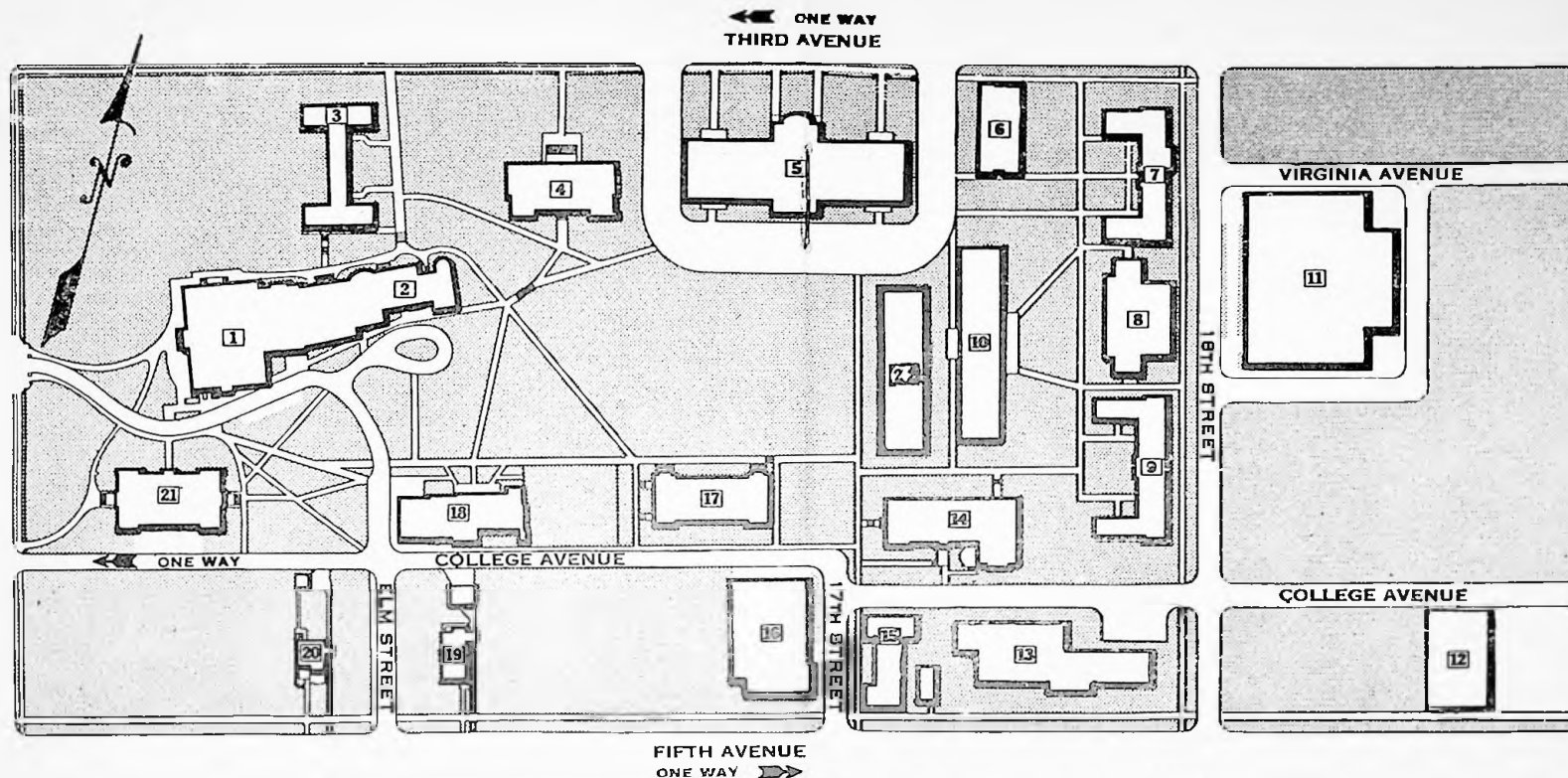

## Key

- |                           |                               |   |
|---------------------------|-------------------------------|---|
| 1 Old Main Building       | 9 Hodges Hall (men)           | 17 Women's Physical Education Building  |
| 2 University Hall         | 10 Lucy Prichard Hall (women) | 18 Shawkey Student Union                |
| 3 Old Main Annex          | 11 Gullickson Hall            | 19 Everett Hall (Home Management House) |
| 4 James E. Morrow Library | 12 Engineering Building       | 20 President's Home                     |
| 5 Science Building        | 13 New Residence Hall for Men | 21 Northcott Hall                       |
| 6 Music Building          | 14 Jenkins Laboratory School  | 22 New Women's Dorm                     |
| 7 Laidley Hall (women)    | 15 Laboratory School Annex    |   |
| 8 University Dining Hall  | 16 Student Christian Center   |   |

**RELIGIOUS COUNSELING** — Another place open to students for consultation on all phases of life, religious or non-religious, is the Student Chapel. The staff of ministers here will do all they can for you.

**SHAWKEY STUDENT UNION** — Our Student Union is named after Morris P. Shawkey, one of our past presidents at Marshall. It is managed by Mr. Don Morris. The Union is the center of social activity on campus. On the first floor are found a lunch counter, a lounge, and a dance area. Bridge, checkers, and chess facilities are available. In the basement are found pool and ping-pong tables. On the second floor are found the office of the University annual staff — The Chief Justice — two conference rooms, and a music room where television and record facilities are available. The Student Government Office is found in the west wing of the Student Union, and we urge you to take an interest in and to participate in the campus government.

## CLOTHES TO FIT THE OCCASION

### Women

Event	Type of Dress	Accessories, Etc.
Athletic Events	Casual or dressy (depends on date)	Heels are added for week-end games
Community Forums and Downtown Movies	Matched skirts and sweaters or suits	Heels
Wednesday Night Mixes	School clothes	
Special dates; Artist Series	Party or good wool dress	Heels
Teas, receptions, Church	Dressy dress or suit	Heels, gloves
Informals	School clothes or costumes	
Formal dances	Floor length dresses are not the rule un- less specified. Cocktail dresses are usually fine.	



## Men

Event	Type of Clothing
Athletic events	Casual or dressy (depends on date)
Community Forums, Downtown Movies	Suit and tie
Wednesday night Mixes	School clothes
Special dates and Artist Series	Suit and tie
Teas, Receptions, Church Informals	Suit and tie
Formal Dances	School clothes or costume
	A tux is usually worn to a winter formal (a dark suit will do) and a white dinner jacket is traditional at a Spring formal.



## CULTURAL PROGRAMS

While you were in high school, you may have had culture forced on you. Now that you are a university student you have the choice of accepting or rejecting the various culture programs offered. We hope you will take advantage of the entertainment made possible by your student activity card.

At least once a month convocations are held in Old Main Auditorium on Thursdays at 11:00 A. M. There programs range in variety from art lectures to jazzy sessions.

Community Forums are held in the evenings in Old Main Auditorium and the programs include such subjects as literature, science, travel, current events and other topics.

The Artist Series are held downtown at the Keith-Albee Theatre at various times during the record year. These are professional performances of national and international fame. For instance, last year we had the Woody Herman Orchestra, the Broadway musical "Camelot", Ballet Folklorico of Mexico and Dave Brubeck (and these are only a sample!)

Besides attending the convocations, Forums and Artists Series, save time for the University Theatre too. Don't underestimate your own talents, maybe you will be the next leading lady or man. Normally there are four full-length plays and several studies and experimental dramas produced each year. Tryouts are open to the entire student body regardless of experience, so give yourself a chance — you might discover just how talented you really are!

If art is of interest, you will be glad to learn that West Virginia's only art museum is located right here in Huntington on Eighth Street Road. Various special exhibits are offered during the year as well as the standard exhibits. Why not take an art class if you're really interested in it—you'd be surprised at what you could learn.

Music lovers will find all types of record albums offered on the second floor lounge of the Student Union. If you wish to check any out, just see Mr. Don Morris, Student Union manager. There is also a television set in the second floor lounge for your added enjoyment.

In the music building are rooms of pianos and musical instruments. There you will also find a chance to meet people who share your common interest in music. Then, too, the marching and concert bands, the symphony orchestra, and the symphonic or men's concert choirs are ever on the outlook for new members. Perhaps you?

Don't forget the library, stacks upon stacks of books from which you can glean knowledge will be found there. Aid your cultural development; you'll find it can be lots of fun.

## LET'S GET ACADEMIC

If you are to achieve your purpose at Marshall University, you must learn how to study now. Studying is a term representing various activities, and thus there are various methods of study. There is no recipe or surefire solution to passing your next four years at Marshall.

Buy your books early. Be sure to read the preface and introduction before going to class the first time.

Note-taking is a necessity at college and quite different from high school. Take notes in ink on standard size paper, then you can read them at exam time. Keep them organized, dated, and in a notebook so you won't lose half a semester's work if you drop a book sometime.

You can usually detect possible test questions by the emphasis put on certain points in lecture. MARK IT IN RED OR STAR IT. Speaking of exams, find out what type your professor will give — essay or objective. Knowing what to study makes your studying easier. You may also have "pop quizzes" so be prepared each day.

For each hour in class, two out-of-class hours of preparation are recommended. Some classes may not require this while, in others, you will have to devote far more time.

Unfortunately, final exams are a necessary evil. We hate 'em, but we take 'em. A final can be a complete review of the semester's work or merely cover the segment since the last test. After you're through that first final week, you're one of the gang. Finals will be tough. They can raise or lower a grade, so study, but don't PANIC when this week rolls around. It is best to begin studying early and to get plenty of sleep.

Your big academic aim is the Dean's list. This is for the students each semester making a 3.0 average or better. Work for it.

We don't advise cutting class. However, if you find it nec-

essary to miss class, be sure you know the policy of your professor before doing so, or you may get a grade cut. When you're sick, call your dean's office and they will contact your professor. However, this does not automatically excuse you from class. Upon returning to class, be sure to explain why you were absent, and then you will be responsible for making up the work you missed. You may find it necessary to crawl to class for some professors, so do it without question. If you miss a class because of a school activity such as intercollegiate sports, debates, choir trips, etc. the department head will notify your instructors.

A final word, remember your first and primary aim in coming to Marshall is TO OBTAIN AN EDUCATION — aside from you "husband-hunting" females. But remember, girls, Marshall men like their women to have brains as well as beauty.

At college, learning is no longer "candy-coated". The responsibility now lies upon YOU.

### NEARBY CHURCHES

Just because you are away from home, you must not neglect your spiritual life. No matter what your church preference might be, Huntington can accommodate you. In fact, it has sometimes been called "the city of churches" and you will soon realize why. There are over one hundred and fifty churches and one will suit you.

Following is a list of churches that most of our students attend. The entire list of churches can be found in the yellow pages of the telephone directory. You can always find someone on campus who will go with you, so don't worry about being by yourself. Many churches are within walking distance, and most of the outlying churches will be glad to furnish transportation if you are interested in attending their services.

Central Christian — 1202 Fifth Avenue

Emmanuel Methodist — 18th Street and Sixth Avenue

Enslow Park Presbyterian — Enslow and Washington Boulevards

Fifth Avenue Baptist — 1135 Fifth Avenue

Fifth Avenue Church of God — 2128 Fifth Avenue

First Church of Christs' Scientists — 1101 Twelfth Avenue

First Congregational — 707 Fifth Avenue

First Methodist — 1124 Fifth Avenue

First Presbyterian — 1015 Fifth Avenue

First Evangelical United Brethren — 21st Street and Fifth Avenue

Hellenic Orthodox, Saint George — 7th Street at Eleventh Avenue

Johnson Memorial Methodist — 10th Street and Fifth Avenue

Ohev Sholom Temple — 949 Tenth Avenue

Pilgrim Holiness — 20th Street and Ninth Avenue

St. Paul's Evangelical Lutheran Church — 721 Twelfth Avenue

St. Joseph's Roman Catholic — 519 Thirteenth Street

Sixth Avenue Church of Christ — 530 Twentieth Street

Trinity Episcopal — 520 Eleventh Street

Twentieth Street Baptist — 20th Street and Fifth Avenue

## CAMPUS CHRISTIAN CENTER

The Campus Christian Center is an interdenominational co-operating group open to all students. Its various activities include: Sunday morning preaching in the chapel sanctuary, inter-denominational Thursday evening meetings plus a social meeting of this group once a month, a week-end service project with under-privileged children, the annual Marshall Ecumenical Retreat open for all Marshall students in the Fall, State retreats and various seminars held in Washington, D. C. and New York late in the year. (If you are interested in joining this group, an Incoming Students Dinner will be held September 13.) Other information concerning this organization and its activities is available at the Campus Christian Center. The Campus Christian ministry is sponsored by nine denominations: Baptist, Christian, Church of Christ, Church of God, Evangelical United Brethren, Episcopal, Lutheran, Methodist and Presbyterian.

## ENTERTAINMENT

Believe it or not, you'll find you have some leisure time. To fill it, try the wide range of entertainment which is abundant in the Tri-State Area. Entertainment will naturally differ with the individual, but here are some suggestions on how to use your leisure time in our city.

Fourth Avenue is the main street of the city. On this street about seven blocks from the campus is located the theatre area. Three theatres are located in this section; they offer special student rates, if you present your ID card. There are several drive-in theatres in Huntington or the surrounding areas.

The city maintains Ritter Park and several other smaller parks, with their recreational facilities. In Huntington is also found several swimming pools, superior recreational sites. If the tennis courts on campus are filled, try the ones in Ritter Park. Camden Park also offers many fun-filled amusements.

Huntington also offers horseback riding, golf, swimming, hiking, bowling, car rentals, airplane rides, and boating facilities. Miniature golf is one of our most popular recreations.

Nationally known entertainers often visit Huntington. All you need to do is read the ads in the newspapers to find out when they are to appear.

If show business is your calling, you'll find collegians have an opportunity to try their talents in front of the footlights of the Community Players, located at the Abbot Theatre, which is on West Fourteenth Street.

Students are always welcomed as helpers with such activities as the Campfire Girls, Girl Scouts, Boy Scouts, and related youth groups.

Just so you won't get lost, remember that the avenues run east and west and are numbered beginning at the river. The streets run north and south and are numbered in both directions from First Street, which is located fifteen blocks west of the campus. Buses make regular runs and taxis are always available.



## EXTRA-CURRICULAR ACTIVITIES

**UNIVERSITY THEATRE** — For thirty-eight years the University Theatre has given training in dramatic skills and techniques, and has helped students to develop such qualities as poise, initiative,

self-reliance, confidence, and cooperativeness. It helps to encourage appreciation of dramatic literature, and it keeps alive the plays which have made dramatic history.

The Theatre presents four plays each year and weekly plays on the Marshall Radio Station WMUL. All students are eligible for parts or work as directors, stage hands, etc. If you are a student interested in dramatics, you should participate in University Theatre.

**RADIO** — The Marshall University Radio Station (WMUL) has been a success. The station broadcasts on 88.1 megacycles on the FM band from 7-10 A. M. and 3-10 P. M., Monday through Friday. The programs vary from popular, jazz, and classical music to news, sports, weather, and other campus activities.

All Marshall students are invited to participate in the University Radio Station. This gives the student an opportunity for a background and knowledge in radio and TV.

**CHORAL UNION** — The Choral Union is composed of members of all the choirs in the music department, united in order to present productions such as the "Messiah" and "Requiem."

**A CAPELLA CHOIR** — This is the training ground for freshmen interested in participating in choral work. From this group freshmen advance to the Men's Concert or Symphonic Choir.

**SYMPHONIC CHOIR** — Sopomore, junior, and senior women make up the Symphonic Choir.

**MEN'S CONCERT CHOIR** — The Men's Concert Choir consists of male upperclassmen.

**MARSHALL UNIVERSITY BAND** — This fine group is open to any student who is interested in being a part of a marching or

a concert band. The band, under the direction of Howard Bell, performs at all home football games. The marching band, with a few minor changes, becomes a concert band for many college programs. Both men and women students are eligible to participate in the band.

**MARSHALL UNIVERSITY DEBATE TEAM** — Marshall is becoming quite well-known and praised for their debate team. Debating at Marshall is an intercollegiate activity. It offers one a chance to gain recognition both for himself and his school and is an invaluable opportunity for all students, especially those in law, political science, or economics, to develop and further their ability to think and speak effectively under pressure.

The team enters about eight tournaments each year and culminates the season by participation in the State Intercollegiate Speech Tournament and the National or Regional Pi Kappa Delta meet. Outstanding debaters may gain membership in Pi Kappa Delta, national debate fraternity.

## RECOGNITION AND HONORARY ORGANIZATIONS

**ALPHA EPSILON DELTA** — Honorary pre-med fraternity for students with an overall 2.8 academic average.

**ALPHA KAPPA DELTA** — Honorary sociology fraternity.

**ALPHA LAMBDA DELTA** — Honorary academic fraternity for freshmen women who attain a 3.5 academic average the first semester of the freshman year or a 3.5 overall average at the end of the second semester of the freshman year.

**ALPHA PHI OMEGA** — National service fraternity for men who have previously been in scouting and have attained good scholastic standards.

**ALPHA PSI OMEGA** — National dramatics fraternity.

**BETA ALPHA MU** — National business administration honorary.

**CHI BETA PHI** — National science honorary fraternity. Membership is extended to these students majoring in one of the sciences who has attained at least 20 hours in his science field with a 3.0 academic average in science and an overall 3.0 average.

**D-RHO D-THETA** — Honorary engineering fraternity.

**DELTA OMICRON** — National music honorary fraternity. Membership is extended to those who have attained a 3.0 average in music and at least a 2.0 overall average.

**ETA MU PI** — National recognition fraternity for retailing students.

**ETA SIGMA PHI** — National honorary fraternity for students of classical languages.

**FAGUS** — Senior women's leadership honorary fraternity which was founded in 1950-51 on Marshall's campus by local members of Mortar Board, national senior women's honorary. Members are elected the second semester of their junior year on the basis of scholarship leadership, character, and service.

**FOURTH ESTATE** — Women's honorary journalism fraternity.

**GAMMA THETA UPSILON** — National geographical honorary fraternity.

**KAPPA DELTA PI** — National education honorary fraternity. Membership is extended to students in Teachers' College who maintain a 3.0 overall average.

**KAPPA PI** — National art honorary fraternity.

**OMICRON DELTA KAPPA** — Men's national leadership honorary fraternity for juniors and seniors which was established on Marshall's campus in 1947. Members are elected on the basis of good scholarship and leadership in three fields.

**PHI ALPHA THETA** — National honorary history fraternity.

**PERSHING RIFLES** — Military honorary for freshmen and sophomores.

**PHI ETA SIGMA** — Honorary academic fraternity for freshmen men who attain a 3.5 academic average during their first year of college.

**PHI MU ALPHA** — National music honorary fraternity.

**PI DELTA PHI** — National French honorary fraternity. Membership is extended to those attaining a 3.0 average in French and one advanced course and a 2.8 overall average.

**PI KAPPA DELTA** — National debate honorary fraternity. Membership is extended to those who have participated in five judged debates.

**PI SIGMA ALPHA** — National political science honorary fraternity.

**PI OMEGA PI** — National business education honorary fraternity.

**PSI CHI** — National honorary psychology fraternity. Membership is extended to any students majoring or minoring in psychology who have completed 12 hours with a 3.0 average and maintaining a 3.0 overall average.

**ROBE** — Local men's honorary fraternity which strives to promote school spirit and student participation in projects that further the purpose of the University.

**SCABBARD AND BLADE** — National junior and senior military honorary fraternity.

**SIGMA DELTA PI** — National Spanish honorary fraternity.

## RESERVE OFFICER TRAINING CORPS

The ROTC battle group is composed of the men in companies A, B, C, D, E, and Headquarters. Each Tuesday at 11 A. M. the battle group converges on the drill field on the west campus for their regular drill. A Second Lieutenant's commission awaits the student who participates in the ROTC for four years and supplements his experience with summer boot camp. The group acts as an organization, taking part in Homecoming and the annual blood drive. Student military leadership is developed through the battle group program. Student leaders are chosen to head each company on the basis of academic ability, military skill, extra-curricular activities, and work in summer camp.

Freshmen and sophomores are eligible for membership in Pershing Rifles. The purpose of the organization is to develop a highly skilled drill team and to promote brotherhood among the members of the ROTC unit.

The ROTC unit publishes its own newspaper. This publication is called SHAVETAIL.

## INTEREST ORGANIZATIONS

**ALPHA BETA ALPHA** — An organization for students interested in library science.

**AMERICAN CHEMICAL SOCIETY** — An organization for students majoring in chemistry.

**GERMAN CLUB** — An organization for students interested in German culture.

**HOME ECONOMICS CLUB** — An organization for all home economics majors.

**INTERNATIONAL RELATIONS CLUB** — An organization for those interested in foreign affairs.

**LA SOCIEDAD HISPANICA** — An organization for students interested in Spanish.

**LE CERCLE FRANCAIS** — An organization for students interested in French culture.

**MARSHALL CLASSICAL ASSOCIATION** — An organization for students interested in classical languages.

**MARSHALL ENGINEERING SOCIETY** — An organization for junior and senior engineering students.

**MUSIC EDUCATORS ASSOCIATION** — This organization is open to all music majors.

**PSI SOCIETY** — An organization for psychology majors.

**RADIO CLUB** — An organization open for all students interested in working with Marshall's radio station, WMUL-FM.

**STUDENT NATIONAL EDUCATION ASSOCIATION** — An organization for those students who plan to teach.

**VARSITY "M" CLUB** — An organization open to students who have won a letter in an intercollegiate sport.

**VETERANS CLUB** — Membership is open to all armed forces veterans.

**WOMEN'S ATHLETIC ASSOCIATION** — An organization open to all women on the Marshall Campus.

**YOUNG DEMOCRATS CLUB** — An organization that promotes interest in the Democratic Party.

**YOUNG REPUBLICAN CLUB** — An organization that promotes interest in the Republican Party.

**MU ALPHA THETA** — State science interest club.



## SOCIAL ORGANIZATIONS

A fraternity is a group of men or women joined together in common bond who have pledged themselves to the pursuit of the highest standards of achievement and conduct. The best fraternities manifest a commitment to those standards in their daily operations.

A fraternity is closely associated with and considered an integral part of the University community. The principles and objectives of a fraternity complement the expressed aims of institutions of higher education. Membership gives rise to an inter-personal growth, engenders a spirit of co-operation, and develops a sense of responsibility.

Whether or not to join a fraternity is a decision that each individual must make for himself. The value of association with any group is only as beneficial as the individual himself chooses to make it.

## "GREEK ORGANIZATIONS"

### National Fraternities

- ALPHA SIGMA PHI** — Fred Tolman, President
- KAPPA ALPHA** — Bill Hedrick, President
- KAPPA ALPHA PSI** — Eddie Howard, President
- LAMBDA CHI ALPHA** — John Murphy, President
- PI KAPPA ALPHA** — Rick Josephs, President
- SIGMA ALPHA EPSILON** — Dean Thompson, President
- SIGMA PHI EPSILON** — Roy Clark, President
- TAU KAPPA EPSILON** — Cliff Yerkey, President
- ZETA BETA TAU** — Jan Blummer, President

## National Sororities

- ALPHA CHI OMEGA** — Charlotte Parsons, President
- ALPHA SIGMA ALPHA** — Marilyn Vorholt
- ALPHA XI DELTA** — Becky McDaniel, President
- DELTA ZETA** — Donna Lambert, President
- SIGMA KAPPA** — Kay Sage, President
- SIGMA SIGMA SIGMA** — Jane Staats Holswade, President

## "Independents"

- I.S.A. and CAVALIERS** — Quenton Wilson



## ATHLETICS

Marshall University is a member of the National Collegiate Athletic Association and of the Mid-American Conference, which includes Bowling Green University, Kent State University, Marshall University, Miami University, Ohio University, Toledo University and Western Michigan University. Marshall competes with all the conference schools in football, basketball, baseball and golf; and with some of the conference foes in tennis, wrestling, and track. Since freshmen cannot participate in varsity athletics, a fine program has been set up to invite freshmen into the Marshall athletic program.

**FOOTBALL** — Returning from last year's winning team (5-4-1) are Jim Cure, All MAC end; Jack Mahone, second team All MAC halfback, Bill Winter, second team MAC guard; Tom Good, second team All MAC center; and Howie Miller, leading passer in MAC at quarterback. Built around this nucleus are thirteen other experienced veterans. Looking from the view point of experience,



Marshall is predicted to have another winning record and possibly even be in contention for the MAC Conference race.

Fairfield Stadium will be the scene of many outstanding home football games. Added to this, most of the away games are within easy traveling distance.

**BASKETBALL** — This will be the second year that Coach Ellis Johnson will be leading our varsity team. Coach Johnson has been very active in recruiting in the past year, and everyone will be keeping their eye on the freshman team. The varsity and freshman teams will be providing many exciting evenings at the home games played at the Memorial Field House.

**BASEBALL** — This past spring the Marshall team experienced a difficult season. The baseballers managed to compile a 5 win, 16 loss record. Outlook for the next year is fair as there are some returning veterans. Among the returning veterans are Larry Tincher, pitcher; Tom Patterson, short stop; Charley Brown, centerfielder; and Tom Cunningham, right fielder.

**WRESTLING** — Wrestling is becoming one of the fastest growing sports on the college level. It is a highly scientific and exciting sport. Matches are decided by either falls or points gained during the match.

The 1963-64 Marshall team placed fifth in the tough MAC Conference. Returning from last year's team are David Cran, 123 lbs.; Bob Lambert, 147 lbs.; Roger Jefferson, 157 lbs.; Jim May, 130 lbs.; Larry Gyer, 167 lbs.; John Tolen, 177 lbs.; and Bob Pruit, heavyweight. With this impressive group of veterans, Coach Edward Prelaz can look forward to an outstanding season.

**GOLF** — Last year the golf team had an excellent record (16-4), under the leadership of coach "Buddy" Graham. In addition to playing the Mid-American Conference foes, Ohio State, University of Dayton, University of Cincinnati, Xavier, and University of Kentucky are among other competitors. Dick Shepherd, one of MU's greatest golfers, will be returning to the team. The home matches are held at the Guyan Country Club.

**TENNIS** — Tennis is one of the popular sports on campus. Our varsity team competes in the tough game with both conference and non-conference teams. The team is coached by John Noble. Freshmen interested in this active sport are urged to tryout for the varsity team.

**TRACK AND FIELD** — The Big Green, while failing to produce a winning season last year, lost only two lettermen. With a large group returning and some outstanding freshmen, Marshall may look forward to a good year in track.

**MAJORETTES** — The beautiful Majorettes who will lead the Big Green band are: Sharon Gaddy, Ann Richardson, Linda White, Earline Sizemore, Rita McCullough, Sally McGrath, and Kay Cramer. These girls were chosen for the honor last spring by a series of practices and tryouts. The basis on which they were selected were marching, twirling, and smiling. Freshmen girls will have their chance next spring!

**CHEERLEADERS** — The Big Green Cheerleaders squad is headed this year by Lynda Taylor. Others on the squad are Betty Theis, Betsy Rich, Judy Varnum, Sonny Sharp, and Karen Agee. Loretta Ufheil and Sally Sotak are alternates. Miss Marion Barone, a former member of the Olympic gymnastics team will serve as the squad advisor and coach. There are plans for new uniforms and cheers, lots of pep rallies, and enthusiasm. Spike Barnette and Carol Smith will assist Ann Nelson on the Student Government committee. Tryouts for Freshmen interested in cheering on a freshman squad will be held in late October. Announcements will be made in the PARTHENON and on campus. Requirements are that you be single, attain a 2.0 average, attend practices, and be really interested. Freshmen men with tumbling ability are welcome on the squad also.

**GREENBACKERS** — The Greenbackers will be reorganized this year under the leadership of Art Fornari with the aid of the Robe. The Greenbackers is a volunteer organization dedicated to the promotion of school spirit. This group is responsible for the MU card section at the home football games. Eighteen members of the Robe are permanent row captains for the card section, filling their own rows with nineteen other students. Each row captain will be responsible for filling his own row. A list of row captains is posted in the Student Government Office in case you wish to participate and have not been contacted. The card stunts are simple and can be executed by following directions accompanying each card. Freshmen are urged to participate!

**INTRAMURALS** — The Marshall intramural program is directed by Robert Dollanger. A student may choose from over 100 sports or activities. These sports are conducted on both a competitive and enjoyment level. Some of the sports are football, basketball,

softball, track and field, soccer, volley ball, aerial darts, and cageball. To add depth to the program, many individual sports are added to the program. An example of these are shuffleboard, foul shooting, tennis, horseshoes, billiards, and wamo throwing.

**UNION SPORTS** — This will be the second year for the Union Sports program. The program is under the direction of Don Morris, director of the Student Union, and assisted by John Beaver. The Union Sports consist of about twenty popular pastimes; table tennis, billiards, bridge, chess, checkers, and many other table game. The competitions will be posted in the Union.

## GLOSSARY

1. **AID:** Short term loans for 60 days and long term loans of 2, 3, or 4 years administered in the Dean of Men's Office, Old Main 116. There is no interest charged unless you fail to pay in the allotted time.
2. **ALUM:** Short for alumnus or alumnae which means a person who has attended or been graduated from a school, college or university.
3. **ARMOR:** Varicus number of pins (sorority or fraternity) worn by females.
4. **A & S STUDENT:** Anyone who is not going to be a teacher, nurse, or engineer, e. g., Arts and Science Student.
5. **BIDS:** Invitations issued by dorms, sororities, and to attend various organization dances. It also designates an invitation to join an organization.
6. **BMOC:** "Big man on the campus."
7. **BWOC:** "Big woman on campus." A gal with beauty plus brains who manages to hold honors in many campus activities.
8. **BRIDGE:** A pre-requisite to graduation; class meets daily in the Union.
9. **BULL SESSIONS:** Where anything from A to Z is discussed until the wee hours in the morning; provides for many enjoyable hours in the dorms.
10. **BUSHES:** See Foliage.
11. **CAP AND GOWN:** The symbol of four (?) years of fatigue.
12. **UNIVERSITY BULLETIN:** Issued every other year which contains requirements, course and curriculum descriptions, and general information about the university.

13. **COKE PARTY:** The "get-acquainted" party given for rushees by the sororities.
14. **CRAMMING:** The painful result for those who forget to study "day by day."
15. **CULTURE:** It's not a disease, but a well-rounded student has it.
16. **DEAN'S LIST:** The entire list of students who earn a 3.0 or above during a semester.
17. **DORM:** Your home away from home during the next four years.
18. **FISH POND:** Of historical interest as Fraternity and Sorority pin-mates were at one time dunked into the Fish Pond in Ritter Park. The custom is still often observed.
19. **FINAL EXAMS:** Farewell parties sponsored by class professors at the end of each semester!!
20. **FIRE-SIDE CHATS:** Informal talks among campus groups during Life Planning Week and Greek Week.
21. **FIW:** Failure because of Irregular Withdrawal — this puts you on Academic Probation. If you want to drop a class, do so through your respective College Dean. This is the Dean's "Pet Peeve."
22. **FOLIAGE:** Refer to Buildings and Grounds.
23. **FROSH WEEK:** The first week of school dedicated to helping you freshmen become acquainted with Marshall.
24. **FLUNK:** Fail a course, You've had it, friend.
25. **GREEKS:** Anyone who is affiliated with a sorority or fraternity with Greek names.
26. **HOMECOMING:** The week-end designated for the return of the ALUMS and also a "Student Remaining" week-end.
27. **I. D. CARDS:** You can pick these up during Frosh Week, and you must present them at all intercollegiate sports, cultural programs, the Library, and for voting.
28. **IFC:** Inter-Fraternity Council.
29. **LEADERSHIP CAMP:** A meeting of the campus leaders prior to school to plan the coming year.
30. **LOCKERS:** Twelve books at a time can become mighty heavy, so go to Room 103 in Old Main, for lockers are issued there for Old Main or the Science Hall; it is one dollar per lock, but you get your money back when you return it.

31. **LOST AND FOUND:** The Dean of Women and Dean of Men handle this problem.
32. **MIX:** The Wednesday night dances in the Union.
33. **OFFICE HOURS:** 8:00 until 4:15 for all administrative personnel.
34. **PEN-HEL:** Pan-Hellenic Association of Sororities.
35. **PLAGUE:** A common campus illness.
36. **PROBATION:** When students do not make their required grades, they are limited to a 12-hour load.
37. **RUSH:** A period where sororities and rushees, and fraternities and rushees get acquainted. The sororities and fraternities finally issue bids to rushees to become affiliated with the organization.
38. **RUSHEE:** If you are rushing a fraternity or sorority, you are a **RUSHEE**.
39. **SCHOLARSHIPS:** These are administered at the Dean of Men's Office, Main 116.
40. **SEMESTER LOAD:** Average 16 hours; be careful, Frosh . . . don't bite off more than you can chew.
41. **SHEEP'S SKIN:** The diploma of our Alma Mater.
42. **SMOKER:** The get-acquainted gatherings for you guys; these are sponsored by the campus frats.
43. **STUDENT ACTIVITIES CARD:** Fee paid for this card entitles admission to university activities, free tickets, and your Year-book.
44. **SUITCASER:** Refers to someone who goes home every weekend and misses out on all the campus fun. Amen!!
45. **SNAP:** A course which requires little or no work. We have such a thing?
46. **TGIF:** "Thank God It's Friday" parties.
47. **TRANSCRIPTS:** When transferring to another college or university, the Registrar's Office will make out the first one free, but any others will cost \$1.00 each.
48. **TRANSFER:** Comes here from another school.
49. **UNIONLOGY:** Be careful, don't spend too much time on this course. Most freshmen decide to major in it but soon change their minds.
50. **VETERANS:** All information concerning veterans is in the Registrar's Office.
51. **WATER BATTLES:** A warfare.